

**UNOFFICIAL**

SHEET 1 OF 2

# 1250

BAYFIELD COUNTY CERTIFIED SURVEY MAP #000683  
LOTS 1 THRU 16 BLOCK 23, DUPONT PARK ADD.  
TO THE CITY OF WASHBURN, BAYFIELD CO., WI

Contact the Bayfield County Register of Deeds  
Office to obtain an official copy of this document.

SCALE



GRANDVIEW

BLVD.

PARK

APPROXIMATE  $\frac{1}{2}$  OF  
DRIVEWAY EASEMENT

25'  
25'

S 00° 49' 05" W 77.40'

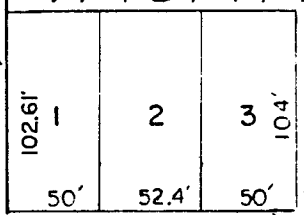

ALLEY

152.48'

"

5

6

7

8

9

10

11

12

13

14

15

16

152.48'

40'

DRIVE

778.61'

PARK

N 89° 39' 08" W

N 89° 39' 08" W

VACATED

BLVD.

VIEW OF ISLES

BK 18

BK 23

LEGEND

- IRON PIPE FOUND
- 1" x 24 CAPPED IRON PIPE WEIGHING 1.13lbs. PER FOOT SET.

BEARINGS ARE FROM THE N. LINE OF DUPONT PARK ADDITION

DATE: 10/20/89

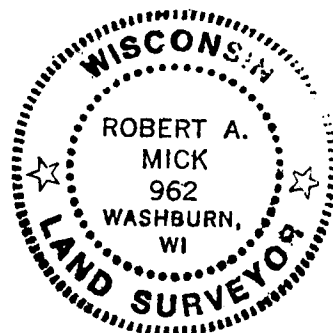

Robert A. Mick  
3-4-90

NET-32-49-4

50' SUNSET

AVE.

# UNOFFICIAL COPY

Contact the Bayfield County Register of Deeds  
Office to obtain an official copy of this document.

Sheet 2 of 2

BAYFIELD COUNTY CERTIFIED SURVEY MAP NO. \_\_\_\_\_

Located in Block 23, DuPont Park Addn. to City of Washburn  
Bayfield County, WI

## Legal Description

Lots 1 through 16, Block 23, DuPont Park Addition to the City of  
Washburn, Bayfield County, Wisconsin.

## Certificate of Survey

I, Robert A. Mick, do hereby certify that I have surveyed the  
property hereon described according to the official records, and  
with the provisions of Chapter S.236.34 of the Wisconsin Statutes  
and Bayfield County Subdivision Ordinance in making the same and  
is a correct representation of the lot lines to the best of my  
knowledge and belief. This survey was performed under the order  
of Mike Pedersen, Washburn, WI.

Robert A. Mick 3-4-90  
Robert A. Mick, L.S. 962

SUPERIOR SURVEYS, INC.  
118 W. Bayfield St.  
P.O. Box 247  
Washburn, WI 54891

Oct. 20, 1989

