

UNOFFICIAL COPY
Contact the Bayfield County Register of Deeds Office to obtain an official copy of this document.

V3P7

MAP OF DRUMMOND ADDITION TO IRON RIVER

Scale 100 Ft. = 1 in.

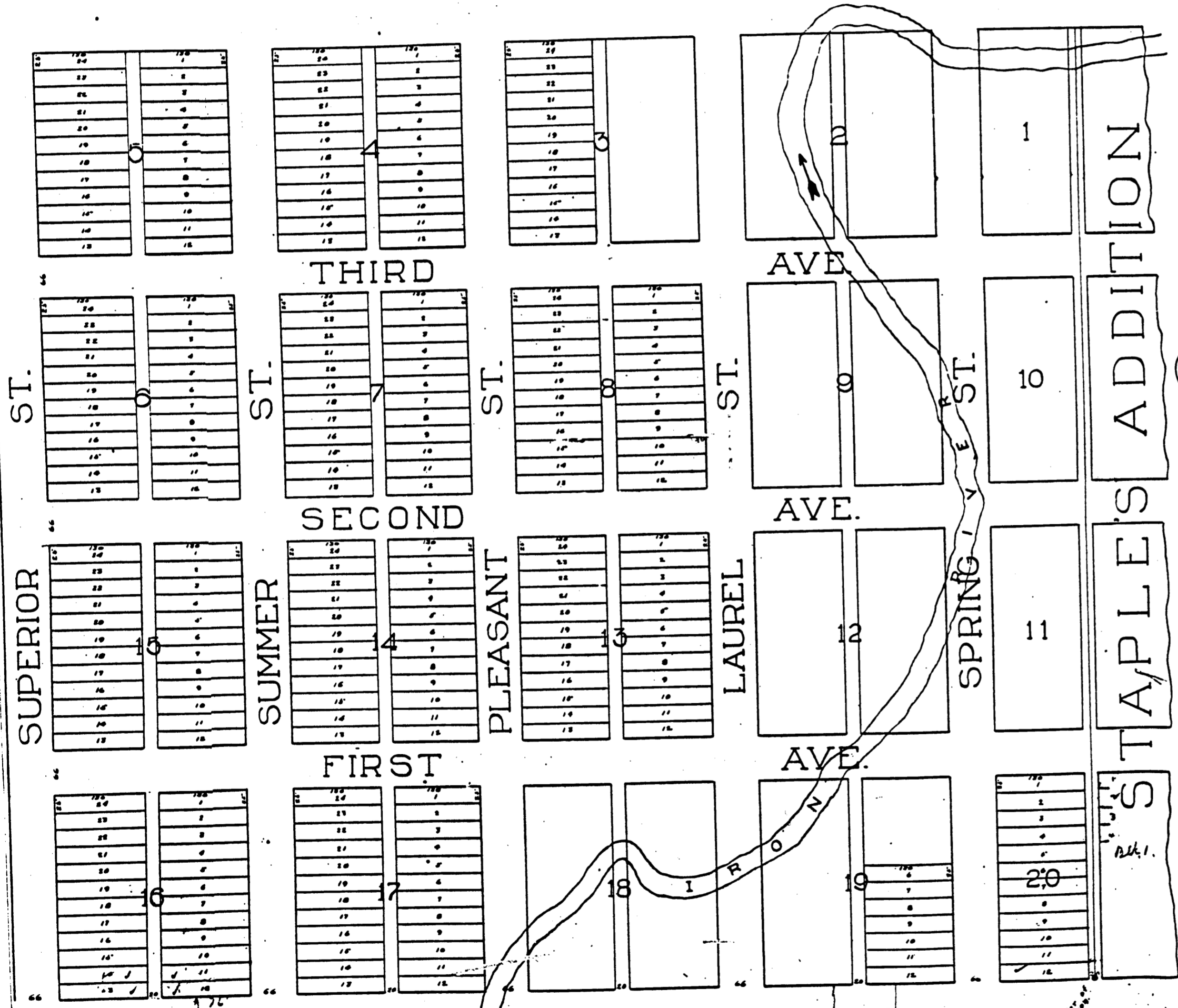

Beginning at monument at Center of Section 7 Township 47 Range 1, thence north 6° West 1398 ft to the Northeast of Block one, thence West at right angle 1320 ft to the North West corner of Block four, thence south at right angle 1398 ft to the South West corner of Block sixteen thence east ¹³²⁰ along the quarter line thence the North West quarter and the South West quarter of said Section 7, to the place of Beginning, being a part of the North West quarter of Section 7, Twp. 47, Rge. 1.

State of Wisconsin }
County of Bayfield } S.S.
I hereby certify that I have surveyed the within plat of Drummond Addition (description of land in Caption) to the town of Iron River as ordered by her and that the same is a true Plat of the Lots and Blocks as they are staked out, that all stakes are set as indicated on the said plat, that all Lots, Blocks, Streets and Alleys are of the length and width designated on the said plat and that I have fully complied with the laws of the State of Wisconsin General Statutes 1898.
Given under my hand this 1st day of July, A.D. 1892.
S. F. Staples
Surveyor.

I hereby certify that I caused the land described in the foregoing certificate of S. F. Staples, Surveyor, to be surveyed and mapped as represented on the within map.
R. M. Drummond
Subscribed and sworn to this 2nd day of July, A.D. 1892
in the presence of
Clifford Bliss }
Thomas Anderson } Witnesses.

I hereby certify that the above named, R. M. Drummond, personally appeared before me and in the presence of Clifford Bliss and Thomas Anderson subscribed and acknowledged the above certificate this 2nd day of July, A.D. 1892.
J. H. Drummond
Justice of the Peace.
Iron River, Wis.

Copied from the original by order of the County Board this 23rd day of Feb. 1916.
Original filed in the office of Registrar of Deeds
R. W. Smith
County Surveyor.

NORTHERN PACIFIC R.R.