

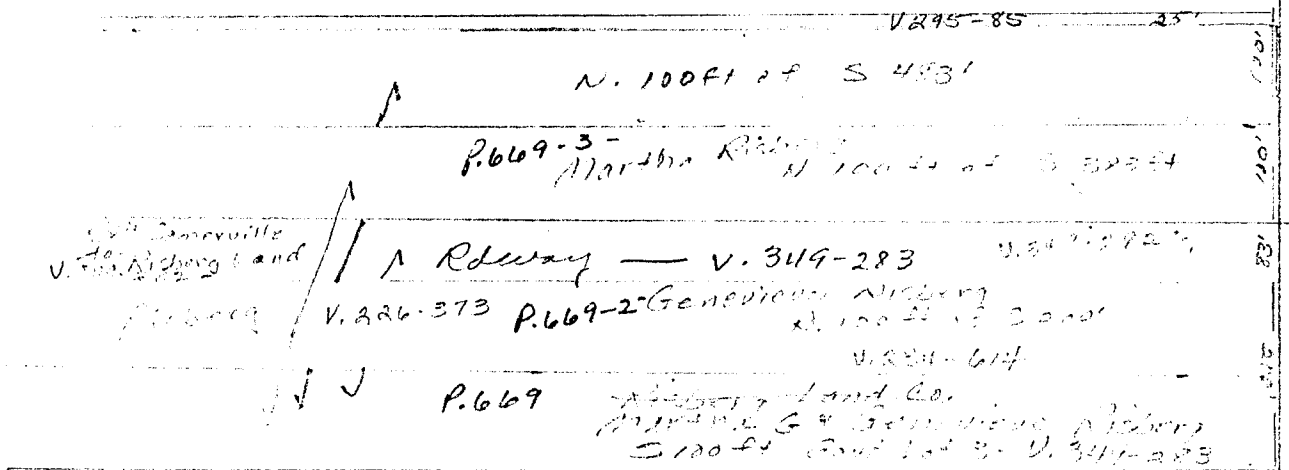

# UNOFFICIAL COPY

This document has not been recorded with the  
Bayfield County Register of Deeds Office.



# UNOFFICIAL COPY

This document has not been recorded with the  
Bayfield County Register of Deeds Office.

V. 186-186 W.D. 9-10-70

V. 232-489 Risking Land Co. - So. - ~~Mercurius J. Risking~~  
N 200 ft of S 483 ft of Govt Lot 3 - 17-44-9

V. 310-438- Strip of land lying N of N line, extended E by D. E. Line  
1, P.W. Lot 3 of the par. desc. in deed from above grantor  
& grantees in U. 295-85 & the line extending W, par  
to S line Lot 3 prompt on E line of Lot 3 which  
483' N of S line of Lot 3 & sh. 7th Ed. C. L. L. L. L.

10-27-58

V. 112-303 Rev. J. Martin - So. - E. L. Snyder  
A par. of land lying in Sec. 10 & 11 - 44-9  
beg. at a pt. on the line between Sec. 10 & 11.  
231.68 N 0° W of MC #5 on shore of Upper E. C.  
Lake & on E side of a pt. called Phase Pt  
thence N 89° E in Sec. 11, 163.4'  
to ip # 9 on upper E. C. Lake  
thence N E by along shore 216' to ip # 11  
thence S 89° E 245.1' to ip # 14  
on line between Sec. 10 & 11 to ip # 4  
being N 0° W of ip # 3 the pt.  
thence from ip # 4 S 38° W 256.1' to ip # 10  
thence N 86° E 160.6' to ip # 3 which is pt.

W.D. 7-25-69

V. 226-373 R. C. Youngman & wife - So. - Risking Land Co.  
A 200 ft of Govt Lot 3 & N 200 ft of S 483'  
of Govt Lot 3 - Sec. 17-44-9  
receiving ind. grantees, use of a way being  
across 783' of S 283' of aforesaid Govt Lot

V. 310-438 Risking Land Co. - So. - Theodore Weimarok & Valfrid  
All that part of the N 100 ft of the S 483 ft  
of Govt Lot 3 - 17-44-9  
the strip of land lying N of N line, extended to  
the east line of said Lot 3