

**UNOFFICIAL
COPY**

Contact the Bayfield County Register of Deeds Office to obtain an official copy of this document.

BAYFIELD COUNTY CERTIFIED

A PARCEL OF LAND LOCATED IN PART OF THE NE ¼ OF THE SW ¼, AND PART OF THE NW ¼ OF THE SE ¼, SECTION 7, TOWN 47 NORTH, RANGE 8 WEST, TOWN OF IRON RIVER, BAYFIELD COUNTY, WISCONSIN.

I, Daniel A. Holman, Registered Land Surveyor, hereby certify:

That on the order of Northwest Regional Planning, I have surveyed, divided and mapped this parcel of Land. Described as follows:

Commencing at the South ¼ corner of said Section 7; thence N 01°32'48" E 1917.25' along the North-South ¼ line to the Point of Beginning. Thence along the North Right of Way of Hwy "2" N 87°05'01" W 172.97'; thence leaving said Right of Way N 05°23'18" E 198.07'; thence S 84°36'42" E 160.01' to a point on said North-South ¼ line; thence N 01°32'48" E 100.23' along said North-South ¼ line; thence S 84°36'42" E 111.71' to a point on the West Right of Way of Lea Street; thence along said Right of Way S 05°23'18" W 286.63' to said Hwy "2" Right of way; thence along said Right of Way N 87°05'01" W 92.28' to the Point of Beginning.
Parcel contains: 60,817.66 Sq. Ft., 1.40 acres.

That said map is a correct representation of the exterior boundaries of the land surveyed and the subdivision thereof made.

That I have fully complied with the provisions of Chapter 236 of the Wisconsin Statutes and the Subdivision Regulations of Bayfield County in surveying, dividing and mapping the same.

Subject to all easements and restrictions of record.

Dated this 18th day of Sept. 2003

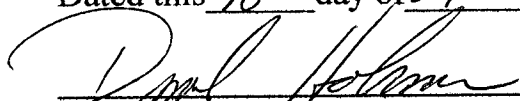
Daniel A. Holman

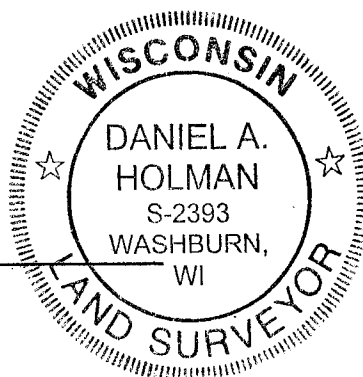

Bayfield County Zoning Department approval, Dated this 23rd Day of Sept. 2003.





Karl Kastrosky - Zoning Administrator

T J H Land Surveying

Daniel A. Holman RLS # 2393
503 West 5th Street
Washburn, WI. 54891
(715)-373-0848 Fax 2973

Project name: 7-47-8 NWRP
Client name: NWRP
Date: 5-19-2003
Fieldbook/Page No: 47-8 Iron River
Drafted by: Daniel A. Holman
Page 2 of 2

Legend

-  Found iron pipe as noted
-  Set 3/4"x18" iron rod - 1.50 lbs/ft
-  Found section corner

614