

UNOFFICIAL COPY

Contact the Bayfield County Register of Deeds Office to obtain an official copy of this document.

BAYFIELD COUNTY CERTIFIED SURVEY MAP#

LOCATED IN THE NE 1/4 - NW 1/4 OF SECTION 22, T. 50 N., R. 6 W., IN THE TOWN OF BELL, BAYFIELD COUNTY, WISCONSIN.

UNOFFICIAL COPY

SURVEYOR'S CERTIFICATE

I, Larry T. Nelson, Registered Land Surveyor in the State of Wisconsin, hereby certify:

That on the order of Dave Martinsen, owner, I have divided and mapped a parcel of land located in the NE 1/4 - NW 1/4 of Section 22, T. 50 N., R. 6 W., in the Town of Bell, Bayfield County, Wisconsin.

To locate the Point of Beginning, commence at the N 1/4 corner of said section 22, run S 00°40' 27" E, 1326.44' along the north-south 1/4 line of said section 22, to a 1 1/2" capped iron pipe at the CN 1/16 corner of said Section 22, which is the Point of Beginning.

Thence from said Point of Beginning by metes and bounds:

Along the south line of said NE 1/4 - NW 1/4, N 89°12'46" W, 851.61' to a 3/4" re-bar which is 76' more or less, S 89°12'46" E of the water's edge of Little Siskiwit Lake; Thence along a meander line near said water's edge, N 53°29'27" E, 495.10' to a 1" x 18" iron pipe; Thence N 41°58'41" E, 664.09' to a 3/4" re-bar that is 62', more or less, S 00°40'27" E of water's edge of the Siskiwit River; Thence leaving said meander line and along the north-south 1/4 line of said Section 22, S 00°40'27" E, 800.00' to the Point of Beginning.

Said parcel is subject to easements, reservations, and restrictions (if any) of record.

Said parcel contains 331,650 square feet, more or less, which is 7.59 acres, more or less, including that land lying between the meander line and the water's edge of Little Siskiwit Lake and the Siskiwit River and the extensions of the lot lines to said water's edge and lying within the right-of-way of Rocky Road.

That this map is a true representation of said survey and subdivision;

That I have fully complied with section 236.34 of the Wisconsin Statutes and the Bayfield County Subdivision Control Ordinance in making said survey, subdivision and map; and

That said survey and map are correct to the best of my knowledge and belief.

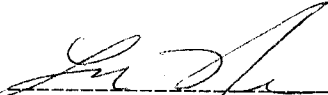
Larry T. Nelson RLS# 1276

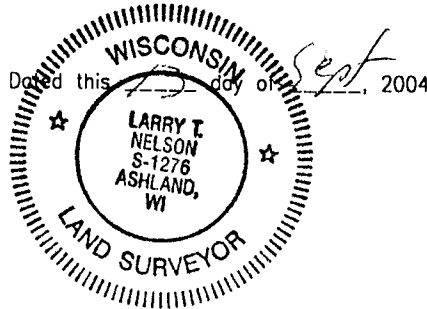

Bayfield County Zoning Approval

This Bayfield County Certified Survey Map is hereby approved by the Bayfield County Zoning Department.

Karl Kastrosky Zoning Administrator Dated this 14th day of Sept, 2004

CERTIFICATES	CLIENT: D. MARTINSEN JOB NO: 04/066 NB. 000 PG. 000 SCALE: 1" = 200' FILE: N/T50NR6W/SEC22 DATE: 08/01/04 /PSDATA&ACAD/04066 DRAFTED BY: JRN SHEET 2 OF 2 SHEETS	NELSON SURVEYING INCORPORATED SURVEYING NORTHERN WISCONSIN SINCE 1954 101 W. MAIN STREET SUITE 207 ASHLAND, WISCONSIN 54806 (715) 682-2692 FAX: (715) 682-5100 MAP NO. 1336 ©
--------------	---	--