

RECEIVED
 JAN 04 2007
 Bayfield Co. Zoning Dept.

UNOFFICIAL COPY #4429

Contact the Bayfield County Register of Deeds Office to obtain an official copy of this document.

BAYFIELD COUNTY CERTIFIED SURVEY MAP NUMBER

A PARCEL OF LAND LOCATED IN THE NW 1/4 OF THE SE 1/4, AND PART OF THE SW 1/4 OF THE SE 1/4, SECTION 5, TOWNSHIP 51 NORTH, RANGE 4 WEST, TOWN OF RUSSELL, BAYFIELD COUNTY, WISCONSIN.

Register of deeds recording area only

CURVE	RADIUS	ARC LENGTH	CHORD LENGTH	CHORD BEARING	DELTA ANGLE
C1	333.00'	149.50'	148.25'	S 77°56'53" W	25°43'24"

C 1/4
 Sec. 5

Par. No. 10300010000
 S 89°16'13" E
 1318.86'

LINE	BEARING	DISTANCE
L1	N 89°11'25" W	43.51'
L2	N 89°11'25" W	162.80'
L3	N 89°11'25" W	324.94'
L4	N 89°11'25" W	640.06'
L5	N 89°11'25" W	188.50'

Par. No. 30100010000
 North-South 1/4 line
 1308.54'

Lot 1
 2,772,846.24 SQ. FT.
 63.65 ACRES
 Excluding the R/W

NOTE: All parcel numbers begin with # 040462510405

Par. No. 30100020000
 00°00'00" N
 2617.08'

UNOFFICIAL COPY

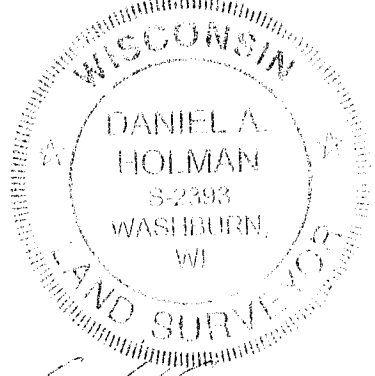
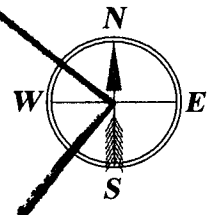

Daniel A. Holman RLS #2393
 Date: 1-4-07

Par. No. 30400020000
 00°29'10" W
 2615.90'

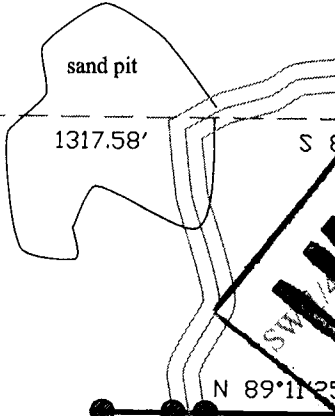

S 1/4
 Sec. 5

Old County Highway "K"

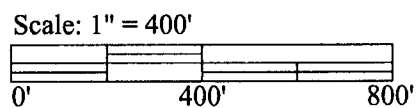

Bearing referenced to the South line of the SE 1/4, Section 5, T. 51 N., R. 4 W. bearing S 89°11'25" E
 All monuments are outside dimension

HOLMAN LAND SURVEYING

Daniel A. Holman WI. RLS #2393
 PO Box 726
 Washburn, WI. 54891
 (715)-373-0848 Fax 0848

Project
 Project name: 8-51-4
 Client name: Town of Russell
 Date: 12-10-2006
 Fieldbook/Page No: T51NR3-4W
 Drafted by: Daniel A. Holman
 Sheet 1 of 2 sheets

Legend
 Found iron pipe as noted
 Set 1 1/2" x 18" iron pipe
 Set RR spike
 Fd 1 1/2" x 24" iron pipe
 (RC) = Recorded as

NW-SE & SW-SE

S-51-4

RECEIVED
JAN 04 2007
Bayfield Co. Zoning Dept

**UNOFFICIAL
COPY**

Contact the Bayfield County Register of Deeds Office to obtain an official copy of this document.

BAYFIELD COUNTY CERTIFIED SURVEY MAP NUMBER _____

Register of deeds recording area only

A PARCEL OF LAND LOCATED IN THE NW ¼ OF THE SE 1/4, AND PART OF THE SW ¼ OF THE SE ¼, SECTION 5, TOWNSHIP 51 NORTH, RANGE 4 WEST, TOWN OF RUSSELL, BAYFIELD COUNTY, WISCONSIN.

I, Daniel A. Holman, Registered Land Surveyor, hereby certify:

That on the order of the Town of Russell, I have surveyed and mapped this parcel of land. Described as follows:

Beginning at the S ¼ of said Section 5. Thence N 00°03'11" W 2617.08' along the North-South ¼ line to the C ¼ of said section; thence S 89°16'13" E 1318.86'; thence S 00°00'13" W 1922.89'; thence N 89°11'25" W 65.00'; thence S 00°00'13" W 695.99' to a point on the centerline of Old County Highway "K"; thence along said centerline N 89°11'25" W 351.30' to the Point of Beginning. Parcel contains: 2,772,846.24 Sq. Ft., 63.65 acres excluding the right of way of Old County Highway "K".

That said map is a correct representation of the exterior boundaries of the land surveyed and the subdivision thereof made.

That I have fully complied with the provisions of Chapter 236.34 of the Wisconsin Statutes and the Subdivision Regulations of Bayfield County in surveying, dividing and mapping the same.

Subject to all easements and restrictions of record.

Dated this 4th day of Jan, 2007

Daniel A. Holman
Daniel A. Holman R.L.S. # 2393

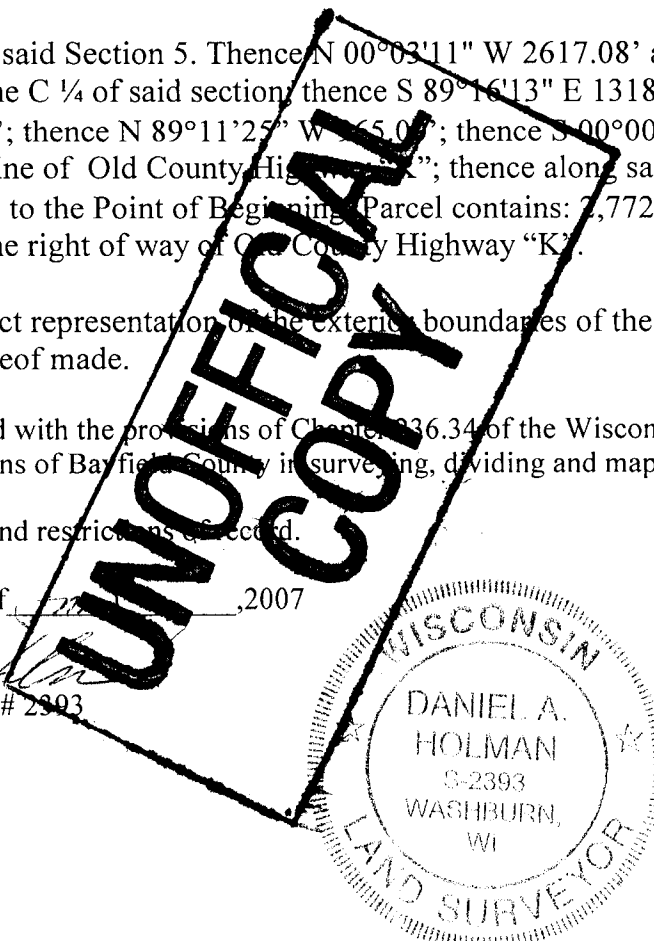

Bayfield County Director of Planning & Zoning Department approval

Karl Kastrosky
Karl Kastrosky - Planning & Zoning Administrator

Date 1/5/07

**HOLMAN
LAND SURVEYING**

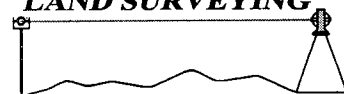

Daniel A. Holman WI. RLS #2393
PO Box 726
Washburn, WI. 54891
(715)-373-0848 Fax 0848

Project

Project name: 8-51-4
Client name: Town of Russell
Date: 12-10-2006
Fieldbook/Page No: T51NR3-4W
Drafted by: Daniel A. Holman
Sheet 2 of 2 Sheets

Legend