

## BAYFIELD COUNTY LAND SURVEY MONUMENT RECORD

INSTRUCTIONS: This record shall show the location of the corner and shall include all of the following nine elements (a through i).

(a) Identify the corner by reference to the U.S. public land survey system.

○ = Corner monument restored.

West 1/4 corner of Section 35, T.52N., R.4W., in the Town of Russell, Bayfield County, Wisconsin.

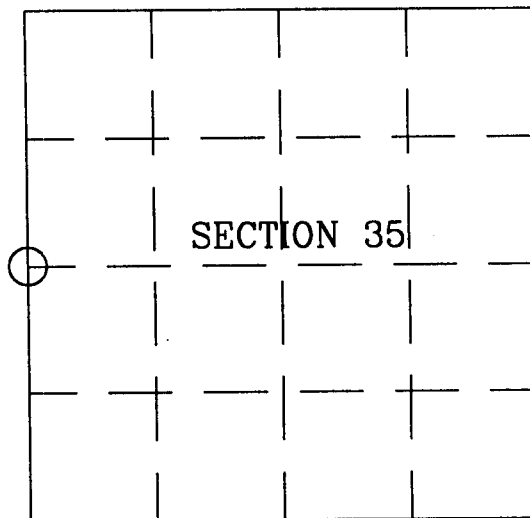

(b) Describe any record evidence, monument evidence, occupational evidence, testimonial evidence or any other material evidence you considered, and whether the monument was found or placed.

Found a 2-1/2" iron pipe with a 3" cap that is stamped to identify the corner. Pipe was set by T. W. Nelson, R.L.S.-263 in May of 1960 to replace a squared maple post he found. This corner was used by T.W. Nelson to subdivide Section 35.

VOL. 3 OF 49 PAGE 203 -  
*Otto Korpela 2004*  
 REGISTER OF DEEDS  
 '98 JAN 22 AM 9 29  
 REGISTER'S OFFICE/S.S.  
 BAYFIELD COUNTY, WIS.

438783

(c & d) Provide plan view drawing on reverse side.

(e) Describe any material discrepancy between the location of the corner as restored or re-established and the location of that corner as previously restored or re-established by distance and direction. Show the discrepancy on the plan view drawing under (d) above. Show the distances between the corner as previously restored or re-established and (1) the corner as restored or re-established, and (2) to at least 2 of the witness monuments shown on the drawing in (d), above.

N/A

(f) Was the corner restored through acceptance of (1) an obliterated evidence location, or, (2) a found or perpetuated location?

A found perpetuated location.

(g & h) Was the corner re-established through lost corner proportionate methods? If so, show the method, including the directions and distances to other public land survey corners used as evidence or or used for proportioning in determining the corner location.

N/A

*As per - Cor. v. Sec.*

203

