

DOCUMENTATION/STATUS OF GEODETIC STATIONS

Station Name: Port Wing GPS

Inspection Date: May 14, 2002

Monument: OK

Signage: OK

Site: OK

Photo of Monument:



Photo of
Sign and
Monument:

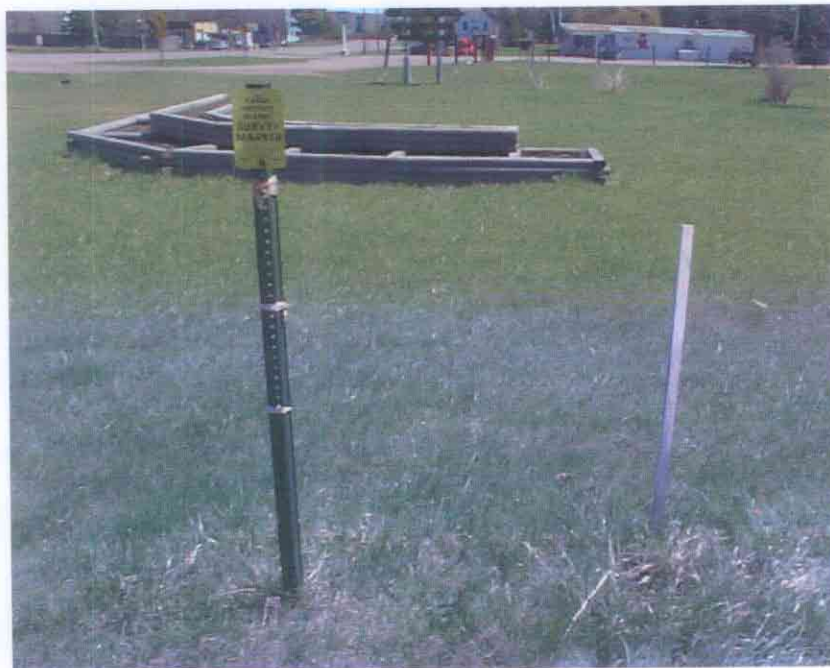

The NGS Data Sheet

DATABASE = Sybase ,PROGRAM = datasheet, VERSION = 5.76

Starting Datasheet Retrieval...

1 National Geodetic Survey, Retrieval Date = MARCH 16, 1999

AF9959 *****

AF9959 DESIGNATION - 313 PORT WING GPS

AF9959 PID - AF9959

AF9959 STATE/COUNTY- WI/BAYFIELD

AF9959 USGS QUAD - PORT WING (1984)

AF9959

AF9959 *CURRENT SURVEY CONTROL

AF9959* NAD 83(1991)- 46 46 29.19602(N) 091 23 14.63367(W) ADJUSTED

AF9959* NAVD 88 - 205.3 (meters) 674. (feet) GPS OBS

AF9959

AF9959 X - -105,955.097 (meters) COMP

AF9959 Y - -4,374,802.491 (meters) COMP

AF9959 Z - 4,624,780.605 (meters) COMP

AF9959 LAPLACE CORR- -12.23 (seconds) DEFLEC96

AF9959 ELLIP HEIGHT- 174.95 (meters) GPS OBS

AF9959 GEOID HEIGHT- -30.35 (meters) GEOID96

AF9959

AF9959 HORZ ORDER - FIRST

AF9959 ELLP ORDER - THIRD CLASS II

AF9959

AF9959.The horizontal coordinates were established by GPS observations

AF9959.and adjusted by the National Geodetic Survey in April 1998.

AF9959

AF9959.The orthometric height was determined by GPS observations.

AF9959

AF9959.The X, Y, and Z were computed from the position and the ellipsoidal ht.

AF9959

AF9959.The Laplace correction was computed from DEFLEC96 derived deflections.

AF9959

AF9959.The ellipsoidal height was determined by GPS observations

AF9959.and is referenced to NAD 83.

AF9959

AF9959.The geoid height was determined by GEOID96.

AF9959

	North	East	Units	Scale	Converg.
AF9959; SPC WI N	- 179,665.176	494,042.680	MT	1.00000149	-1 00 03.0
AF9959; UTM 15	- 5,181,398.938	623,112.222	MT	0.99978629	+1 10 30.7

AF9959

AF9959 SUPERSEDED SURVEY CONTROL

AF9959

AF9959.No superseded survey control is available for this station.

AF9959

AF9959_MARKER: DB = BENCH MARK DISK

AF9959_SETTING: 7 = SET IN TOP OF CONCRETE MONUMENT (ROUND)

AF9959_STAMPING: 313 PORT WING GPS

AF9959_STABILITY: C = MAY HOLD, BUT OF TYPE COMMONLY SUBJECT TO

AF9959+STABILITY: SURFACE MOTION

AF9959_SATELLITE: THE SITE LOCATION WAS REPORTED AS SUITABLE FOR

AF9959+SATELLITE: SATELLITE OBSERVATIONS - 1996

AF9959

HISTORY	Date	Condition	Recov. By
AF9959 HISTORY	- 1996	MONUMENTED	WI-007

AF9959

AF9959 STATION DESCRIPTION

AF9959

AF9959'DESCRIBED BY BAYFIELD COUNTY WISCONSIN 1996 (DKL)

AF9959'STATION DESCRIPTION DESCRIBED BY BAYFIELD COUNTY, 1996 THE STATION
AF9959'IS LOCATED IN THE UNINCORPORATED VILLAGE OF PORT WING, WISCONSIN ON
AF9959'THE RIGHT-OF-WAY OF STATE HIGHWAY 13 IN THE NORTHEAST QUATRRER OF THE
AF9959'NORTHEAST QUARTER, SECTION 32, T50N, R8W, TOWN OF PORT WING. TO REACH
AF9959'THE STATION FROM THE INTERSECTION OF COUNTY HIGHWAY A AND STATE
AF9959'HIGHWAY 13 IN PORT WING GO 11.58 M (37.99 FT) EAST OF THE CENTERLINE
AF9959'OF COUNTY HIGHWAY A AND 27.74 M (91.01 FT) SOUTH OF THE CENTERLINE OF
AF9959'STATE HIGHWAY 13. THE STATION IS A 8.3 CM (3.25 IN) ALUMINUM CAP
AF9959'STAMPED---313 PORT WING GPS---SET INTO THE TOP OF A ROUND CONCRETE
AF9959'MONUMENT 30.48 CM (12 IN) IN DIAMETER LOCATED FLUSH WITH THE GROUND.
AF9959'STATION IS 1 M (3.3 FT) SOUTH OF A STEEL FENCE POST BEARING THE SIGN
AF9959'(PLEASE PROTECT NEARBY SURVEY MARKER) .
Elapsed Time = 00:00:03