

N1/4 NW1/4 + N1/4 NW1/4  
P-24-46 292

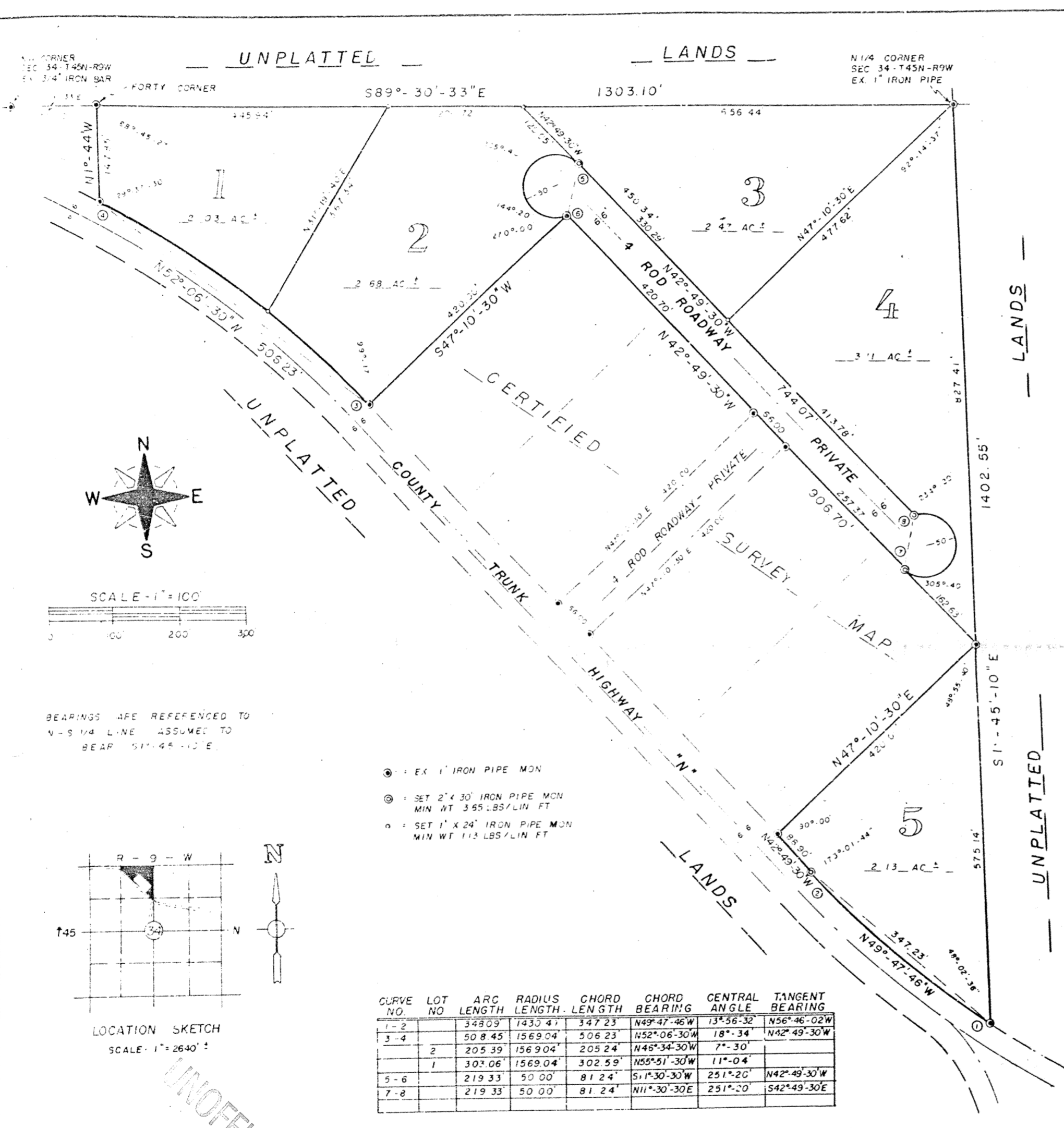

BEARINGS ARE REFERENCED TO  
N-S 1/4 LINE ASSUMED TO  
BEAR S17°45'10"E

- ⊙ : EX 1" IRON PIPE MON
- ⊙ : SET 2' X 30' IRON PIPE MON  
MIN WT 3.55 LBS/LIN FT
- ⊙ : SET 1' X 24' IRON PIPE MON  
MIN WT 1.13 LBS/LIN FT

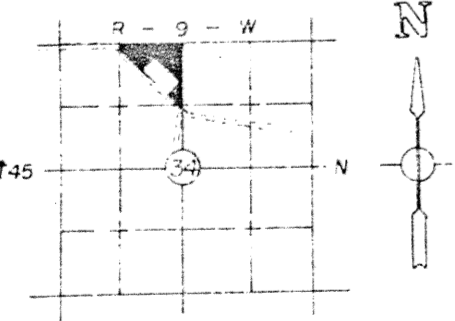

CURVE NO.	LOT NO.	ARC LENGTH	RADIUS LENGTH	CHORD LENGTH	CHORD BEARING	CENTRAL ANGLE	TANGENT BEARING
1-2		348.09	1430.47	347.23	N49°47'46"W	13°56'32"	N56°46'02"W
3-4		508.45	1569.04	506.23	N52°06'30"W	18°34'	N42°49'30"W
	2	205.39	1569.04	205.24	N45°34'30"W	7°30'	
	1	303.06	1569.04	302.59	N55°51'30"W	11°04'	
5-6		219.33	50.00	81.24	S1°30'30"W	251°20'	N42°49'30"W
7-8		219.33	50.00	81.24	N11°30'30"E	251°20'	S42°49'30"E

UNOFFICIAL COPY

341491  
REGISTERS OFFICE  
Bayfield County Wis  
RECORDED AT 3P M.  
On November 12, 1981 IN  
Book 26 of Plats Page 48  
Otto Korpela  
REGISTER OF DEEDS

# CHARLIE'S ACRES

LOCATED IN THE  
NE1/4-NW1/4 & SE1/4-NW1/4, SEC. 34-T45N-R9W, TOWN OF  
BARNES, BAYFIELD COUNTY, WIS.

**CERTIFICATE OF TOWN TREASURER**  
I, Town Treasurer of the Town of Barnes, do hereby certify that in accordance with the laws of this State there are no unpaid taxes or special assessments levied on any of the land included in the Plat of CHARLIE'S ACRES.  
Dated 10-5-81  
TOWN TREASURER

**CERTIFICATE OF COUNTY TREASURER**  
I, Duane A. Marten, being the duly elected, qualified and acting County Treasurer of Bayfield County, do hereby certify that the records in my office show no unredeemed tax sales and no unpaid taxes or special assessments as of 10/5/81 affecting the lands included in the Plat of CHARLIE'S ACRES.  
Dated 11-10-81  
COUNTY TREASURER

**TOWN BOARD RESOLUTION**  
Whereas, that the plat of CHARLIE'S ACRES in the Town of Barnes, Charlene Soderstrom, owner, is hereby approved by the town board.  
Dated 10-5-81  
TOWN CLERK

**CERTIFICATE OF REGISTER OF DEEDS**  
I hereby certify that the Plat of CHARLIE'S ACRES, was received for record this 12th day of November, 1981 at 3 o'clock P.M.  
Otto Korpela  
REGISTER OF DEEDS

**SURVEYOR'S CERTIFICATE**  
I, Duane A. Marten, Registered Land Surveyor, hereby certify that I have surveyed, divided and mapped that part of the NE1/4 NW1/4 and SE1/4 NW1/4, Sec. 34-T45N-R9W, Town of Barnes, Bayfield County, Wisconsin, bounded and described as follows: Beginning at the N.W. corner of the N. 1/4, Sec. 34; thence S17°10'30"W along the West line of the N. 1/4, 117.85 feet to the North line of the N. 1/4; thence N17°10'30"E along the North line of the N. 1/4, 1303.10 feet to the point of beginning. That said plat is a correct representation of all exterior boundaries of the land surveyed and the subdivision thereof made. That I have made such survey, land division and plat by the order and under the direction of Charlene Soderstrom, owner. That I have fully complied with Chapter 236 of the Wisconsin Statutes and the subdivision regulations of the Town of Barnes to the best of my knowledge and belief.  
Dated this 16 day of Sept., 1981.  
Duane A. Marten  
LOCAL SURVEYOR, LAND SURVEYOR  
VACATIONLAND SURVEYORS, INC.  
SOLON SPRINGS, WIS.

**OWNER'S CERTIFICATE OF DEDICATION**  
As owner, I hereby certify that I caused the land described on this plat to be surveyed, divided, mapped and dedicated as represented on the plat. I also certify that this plat is required to be submitted to the Town Board of the Town of Barnes and the Bayfield County Zoning Committee for approval.  
WITNESS the hand and seal of said owner this 22 day of Sept., 1981.  
In presence of: Charlene Soderstrom  
CHARLENE SODERSTROM, OWNER

STATE OF WISCONSIN )  
BAYFIELD COUNTY ) ss.  
Personally came before me this 22 day of Sept., 1981, the above named, Charlene Soderstrom, to me known to be the person who executed the following instrument and acknowledged the same.  
Duane A. Marten  
NOTARY PUBLIC, BAYFIELD COUNTY, WIS.  
My Commission expires 22 April 1984

