

TRUNK

HIGHWAY

"M"

S 81° 02' 28" E
32.59'

S 77° 36' 21" E
192.87'

N 4° 16' 30" W
100.00'

17° 25' 40"

PART OF THE NW 1/4 OF
THE SE 1/4 OF SECTION 16,
TOWNSHIP 43 NORTH, RANGE
7 WEST, TOWN OF CABLE,
BAYFIELD COUNTY WISCONSIN

2.0 Acres

331.46'

EASEMENT
ROAD

288.12'

277.48'

S 85° 29' 24" W
100° 31' 25"

2.1 Acres

305.13'
1154.28'
1155.84'

1068.61'

237.84'

S 15° 02' 01" E
S 15° 02' 55" E
(RECORDED AS

333.42'

S 85° 29' 24" W
100° 16' 25"

4.3 Acres

N 4° 30' 36" W
62.16'

480.49'

TELEMARK ROAD

LOCATION OF

TELEMARK ROAD

APPROX. 235

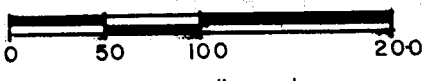
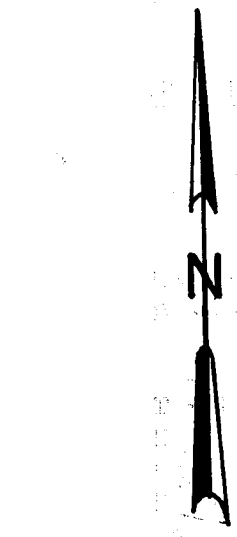

SCALE 1"=100'

LEGEND:

- IRON PIPE OR BAR FOUND IN PLACE
- 1/4" X 30" IRON PIPE SET THIS SURVEY

815334

000189
CSM No.

REGISTERS OFFICE
Bayfield County, Wis.
S.S.
RECORDED AT 10 A.M.
ON JUL 26 1977
IN
Vol. 2 of CSM Page 2354
2354

David K. Lee

REGISTER OF DEEDS

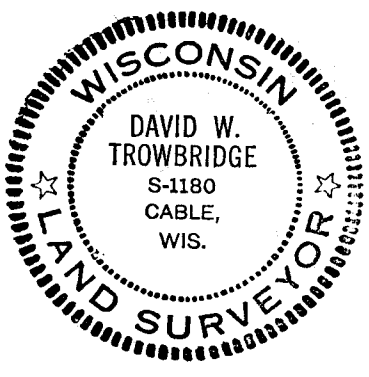

APPROVED

Bayfield County Zoning Comm.

By David K. Lee
Date July 26, 1977 Map# _____

SEE NW 1/4 43 N

CERTIFIED SURVEY MAP NO. _____

Part of the NW $\frac{1}{4}$ of the SE $\frac{1}{4}$ of Section 16, Township 43 North,
Range 7 West, Town of Cable, Bayfield County, Wisconsin.

SURVEYOR'S CERTIFICATE

I, Wayne Trowbridge, Registered Land Surveyor, do hereby
certify;

That I have surveyed, divided and mapped part of the
NW $\frac{1}{4}$ of the SE $\frac{1}{4}$ of Section 16, T 43 N, R 7 W, Town of Cable,
Bayfield County, Wisconsin, bounded and described as follows:

Beginning at the South Central 1/16 Corner of Section 16,
T 43 N, R 7 W; thence N 4° 30' 36" W, 1068.61 feet; thence
N 4° 16' 30" W, 100 feet; thence S 81° 02' 28" E, 32.59 feet
to a point on the southerly right-of-way of C.T.H. "M"; thence
S 77° 36' 21" E, 192.87 feet along the chord of an arc (which
is said right-of-way) whose center bears south and having a
radius of 3727.88 feet; thence S 15° 12' 01" E, 1154.28 feet;
thence S 89° 18' 04" W, 428.71 feet to the point of beginning.

That I have made such survey and map by the direction of
the owner of said lands; That such map is a correct representa-
tion of all exterior boundaries of the land surveyed and the
subdivision thereof made; That I have fully complied with the
provisions of Chapter 236 of the Wisconsin Statutes and the
subdivision regulations of Bayfield County in surveying and
mapping same.

7 July 1977
Date

David W. Trowbridge
RLS No. S-1180

Parcels are subject to easements and reservations of record.

Bearings are based on the N-S 1/4 line recorded on the December
1971 Certified Survey by Ronald G. Pember.



APPROVED
Bayfield County Zoning Com~~mittee~~
By David K Lee
Date July 27, 1977 Ord# _____ Map# _____

235A