

BOUNDARY & TOPOGRAPHIC SURVEY BAYFIELD COUNTY HIGHWAY DEPT. GARAGE

LOCATED IN THE NW 1/4 OF THE NE 1/4, SECTION 32, T.50N., R.8W.
TOWN OF PORT WING, BAYFIELD COUNTY, WISCONSIN

LEGEND

- = IRON PIPE OR ROD FOUND
- = 3/4"x18" IRON RE-BAR WEIGHING 1.63 LBS./LIN.FT. SET THIS SURVEY
- ⊕ = BORING
- ☐ = TELEPHONE PED.
- |V| = WATER VALVE
- ◀BM = BENCHMARK
- = POLE
- ≡≡≡≡ = CULVERT

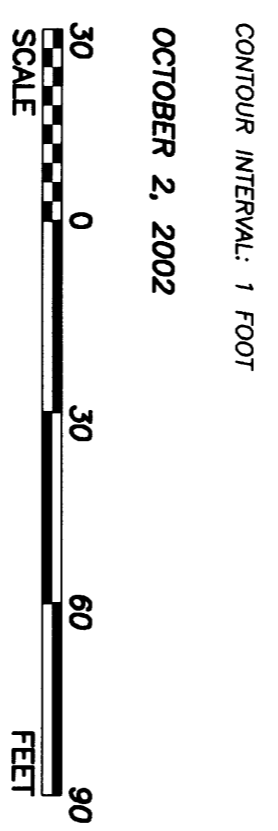

SURVEYOR'S CERTIFICATE

I hereby certify to the Bayfield County Highway Commission that this map is true and correct to the best of my knowledge and belief.

Robert A. Mick
Robert A. Mick, L.S. 962

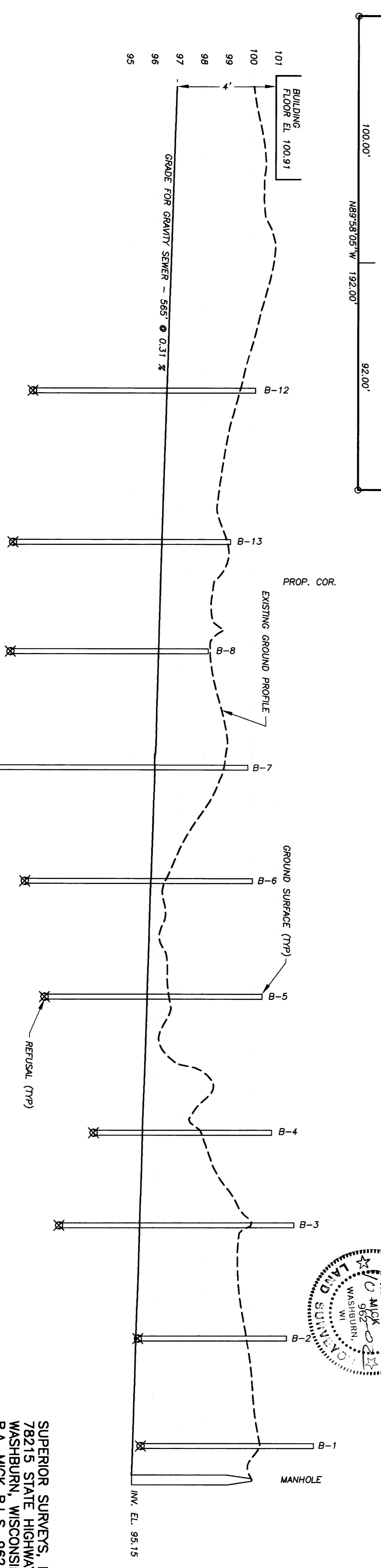
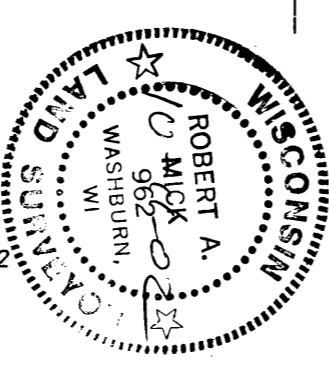

SUPERIOR SURVEYS, INC.
78215 STATE HIGHWAY 13
WASHBURN, WISCONSIN
R.A. MICK R.L.S. 962