

Bayfield County Forestry Department

Forester: B. Klobuchar	Twp: 45	Range: 9W	Sec: 13	Estimated Volumes RED PINE 600 cords Average dbh. = 14 inches
Acres: 58	Township: BARNES			
Soil: SAND	Compartment: 168			
Topography: FLAT	Tract Number: 15-09			
Scale: 4 in = 1 mi.	Contract Number:			

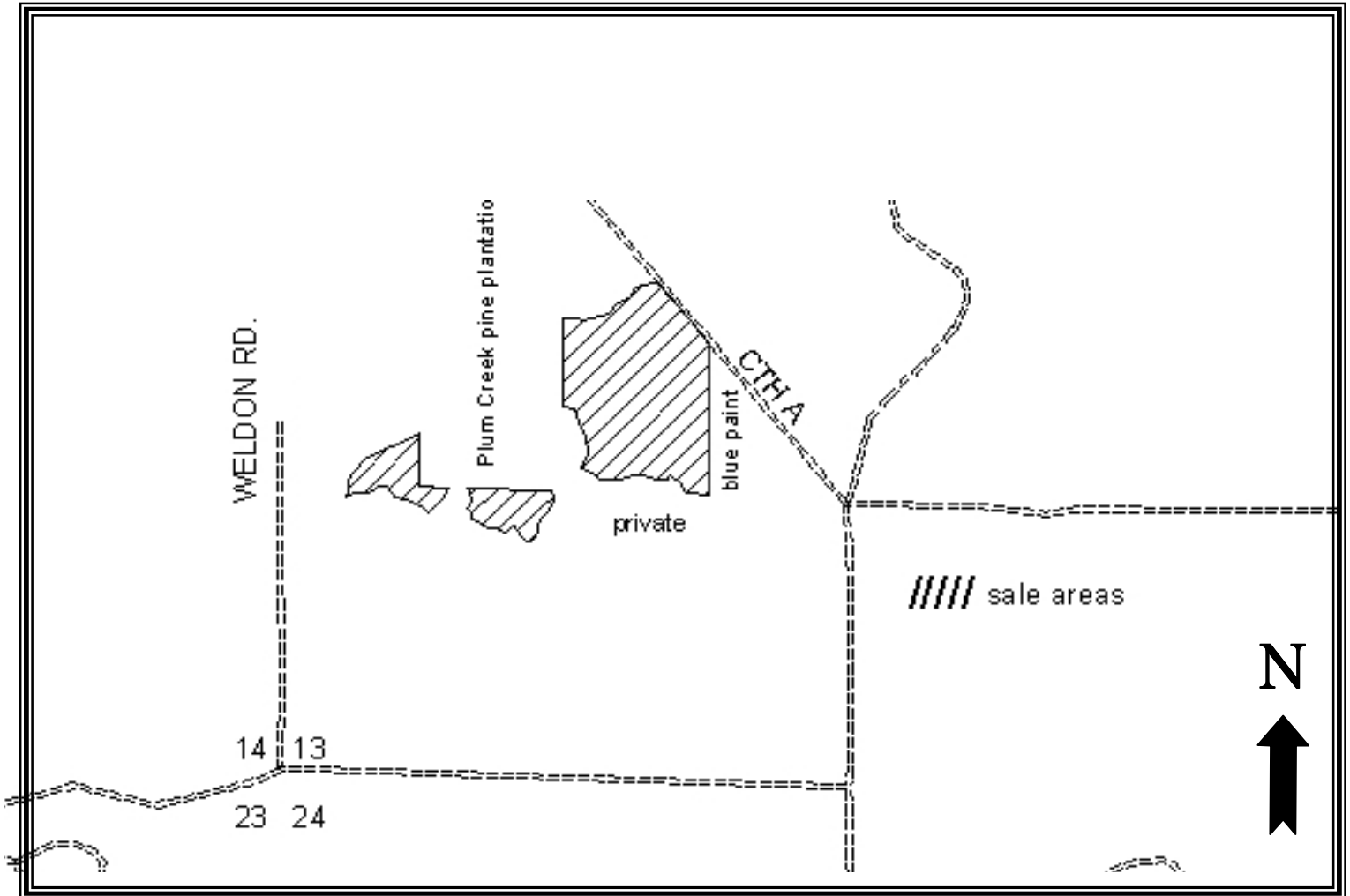

Harvest requirements: Harvest all orange paint marked trees. This is a ticket scale sale. Although this is a year round logging site, it is best to operate when the hazel is free of foliage. This is in order to see the paint marks clearly. Sale access will be off County Highway A and there is a possibility of using Weldon road for access to the small sale areas. No new roads need to be constructed.

The two small areas to the west have red paint lines around them. The larger area is defined by blue paint, roadway, and obvious timber type changes.

All pine must be hauled within 3 weeks of harvesting between May 1st and August 31st. Decking of wood along Town roads will not be allowed without permission from Bayfield County.

Bayfield County Timber Sale Bid

Date: 8-3-09

I hereby submit my bid on timber sale number: 15-09

Description: T45N. R9W. Sec. 13

Acres: 58

This sale can be purchased either by the cord or ton. Please indicate which product you are bidding on.

Species	Volume			Minimum Bid Per Cord or Mbf	Minimum Bid Per Ton	Total Minimum Bid Per Product	Bid Price Per Unit of Volume	Total Bid Per Product
	Cords	MBF	2" Tons*					
RED PINE	600			\$49.20		\$29,520.00		
Totals	600	0	0	Total Min. Bid =		\$29,520.00	Total Bid =	

*2" Ton volumes are based utilization to at least a 2" top. If the bid is based upon 2" tons, then the timber sale contract will reflect this utilization.

Bid Price is based on unpeeled products.

Enclosed is the amount of \$ _____, which represents 10% of the stumpage value based on my total bid.

Name/Company: _____

Signature: _____

Address: _____

Telephone: _____

**Please include the completed bid form and bid deposit in an envelope clearly marked "Timber Sale Bid Sale # ____" for each sale bid.

Submit bids to:
 Bayfield County Forestry Department
 Courthouse
 Post Office Box 445
 Washburn, WI 54891