

Bayfield County Forestry

Forester: Demovsek	Township: Iron River	Estimated Volumes Jack Pine: 222 cds ave dbh 10" Aspen: 156 cds Red Pine: 81 cds ave dbh 10" Scrub Oak: 64 cds Mx. Hwd: 42 cds * *Includes approx. 23 cds Paper Birch
Date: 9/23/09	Legal: 47N.-R.08W.	
Soil: Sand	Section: 10	
Topography: Rolling	Compartment: 101	
Advertised Val.: \$15,540.80	Acres: 25	
Scale: 4" = 1 mile	Tract Number: 33-09	

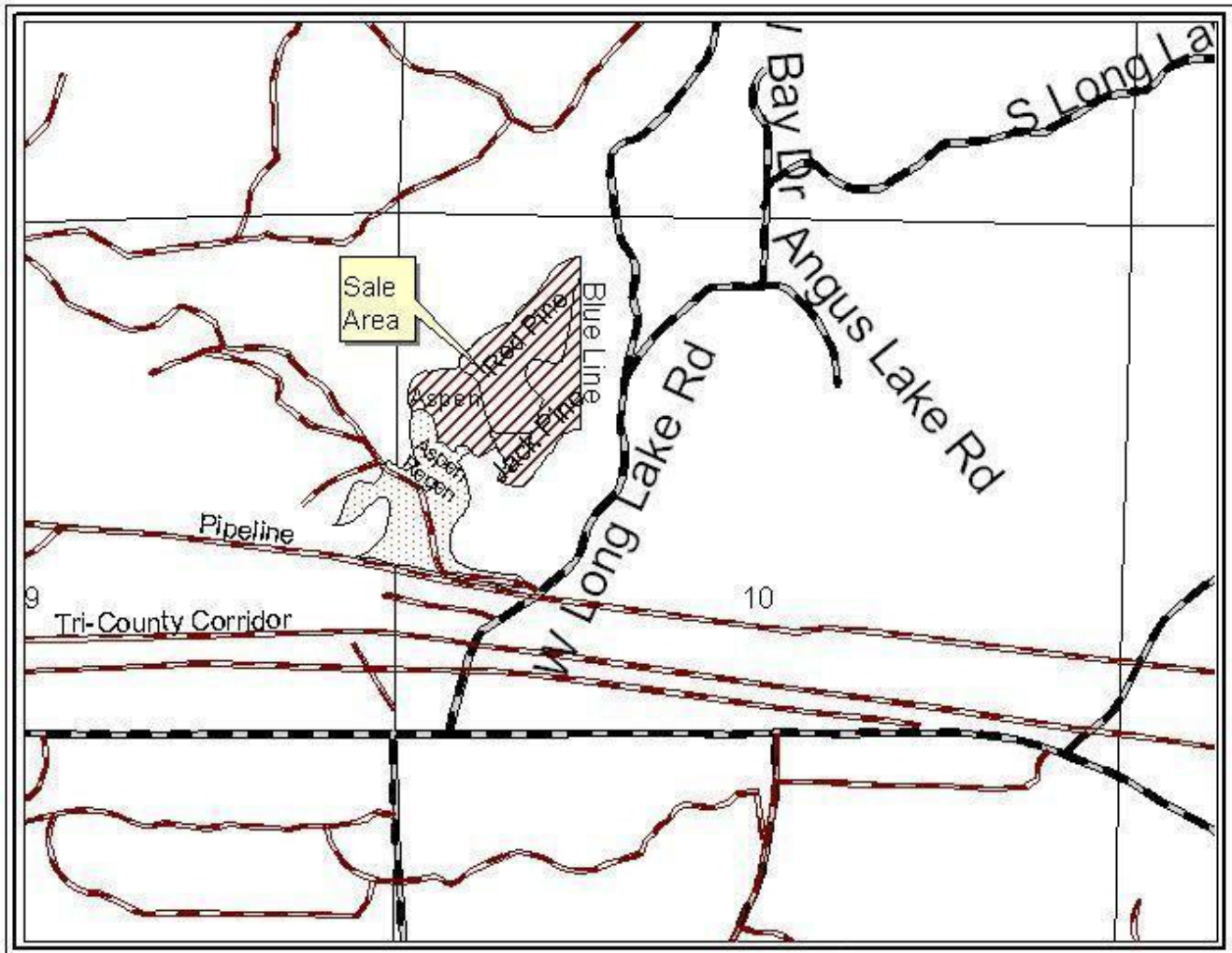

Harvest Requirements:

This sale is being sold on a TICKET SCALE basis. Harvest all stems 2" and greater except for Red and White Pine not marked with orange paint. The sale area is identified by a Blue Paint boundary on the East side indicating private property and a Red Paint boundary identifying the rest of the sale. Absolutely no logging operations will be allowed on the east side of the Blue Painted Boundary. Utilize all pine to a 4" top and all hardwood to a 5" top. From May 1 to August 31, all pine must be hauled within 3 weeks of harvesting. Access for this sale will be on the Pipeline right-of-way. Access will be restricted to only the northern portion of this right-of-way on the existing logging road. This contract requires County authorization for all road/landing construction and places a number of other requirements on road construction and closure (refer to section 17). Decking of wood along Town roads will not be allowed without proper permits and permission from sale administrator.

Bayfield County Timber Sale Bid

Date: _____

I hereby submit my bid on timber sale number: 33-09

Description: T47N R08W Sec.10

Acres: 25

This sale can be purchased either by the cord or ton. Please indicate which product you are bidding on.

Species	Volume			Minimum Bid Per Cord or Mbf	Minimum Bid Per Ton	Total Minimum Bid Per Product	Bid Price Per Unit of Volume	Total Bid Per Product
	Cords	MBF	Tons*					
Jack Pine	222		657	\$30.80	\$10.41	\$6,837.60		
Aspen	156		481	\$27.28	\$8.85	\$4,255.68		
Red Pine	81		242	\$26.40	\$8.84	\$2,138.40		
Scrub Oak	64		294	\$17.60	\$3.83	\$1,126.40		
Mx Hwd.	42		174	\$28.16	\$6.80	\$1,182.72		
Totals	565	0	1848	Total Min. Bid =		\$15,540.80	Total Bid =	

*Tonnage volumes are based upon whole tree utilization. If the bid is based upon tons, then the timber sale contract will reflect this utilization.

Bid Price is based on unpeeled products.

Enclosed is the amount of \$ _____, which represents 10% of the stumpage value based on my total bid.

Name/Company: _____

Signature: _____

Address: _____

Telephone: _____

**Please include the completed bid form and bid deposit in an envelope clearly marked "Timber Sale Bid Sale # ____" for each sale bid.

Submit bids to:
 Bayfield County Forestry Department
 Courthouse
 Post Office Box 445
 Washburn, WI 54891