

# Bayfield County Forestry

Forester: B. Klobuchar	Township: TRIPP	<b>ESTIMATED VOLUMES</b>  <b>ASPEN</b> <b>2120 cords</b> <b>JACK PINE</b> <b>470 cords</b> <b>W. BIRCH</b> <b>105 cords</b> <b>RED MAPLE</b> <b>125 cords</b> <b>R. OAK</b> <b>280 cords</b>  Ticket scale
Date: 09/24/09	Legal: SE ¼ & E1/2NW	
Soil: Sand	Section: 14 & 23	
Topography: Rolling	Compartment: 97 & 98	
Advertised Val.: \$77,932.85	Acres: 123	
Scale: 4" = 1 mile	Tract Number: 36-09	

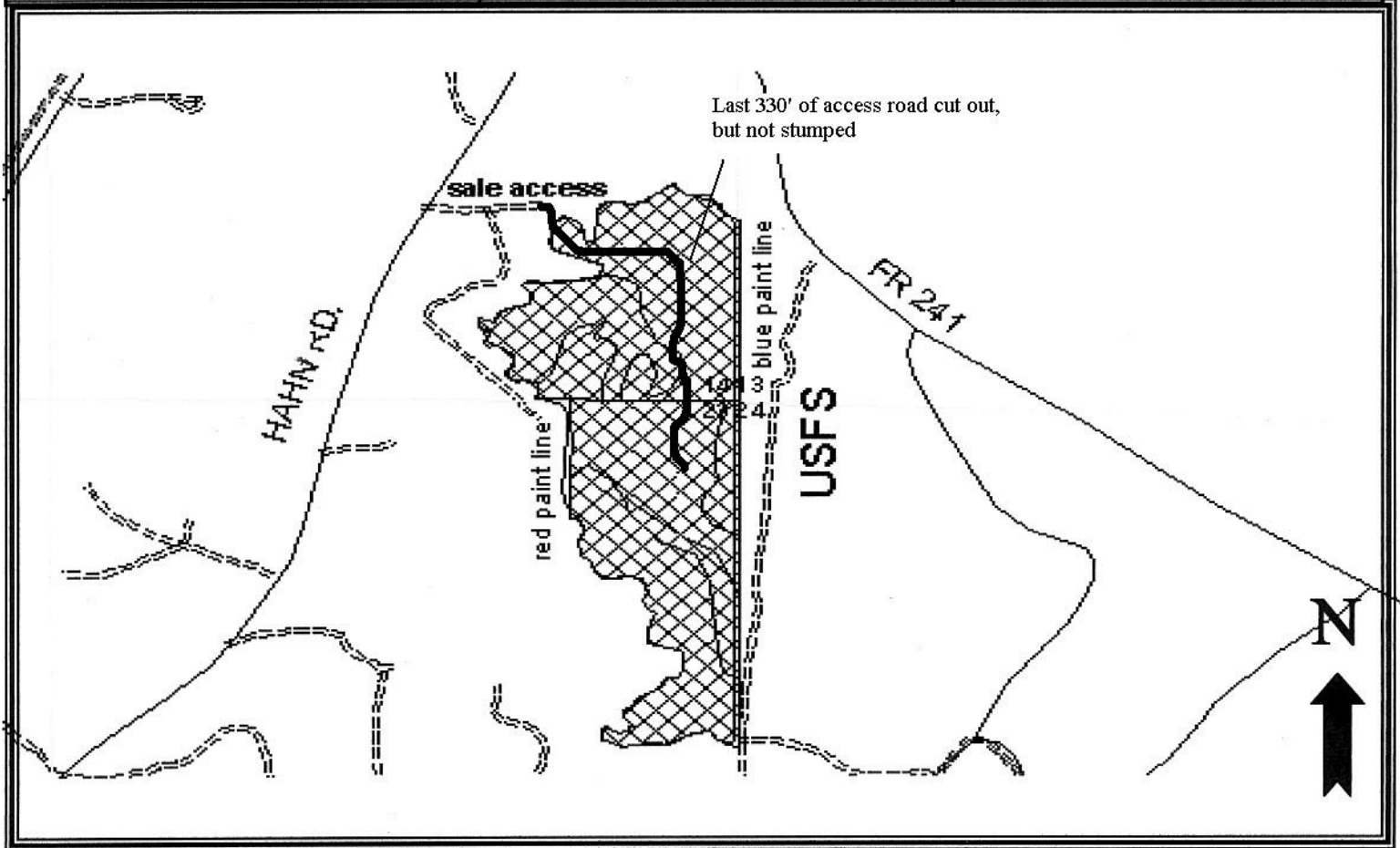

**Cutting Specifications and requirements:** Harvest all merchantable trees except obvious cavity trees. The sale boundary is painted red except the east side, which is the U. S. Forest Service boundary and is painted blue. The sale access is off of Hahn Rd. There is to be no logging activity on USFS property. This contract requires County approval for all road/landing construction and places a number of other requirements on road construction and closure. Decking of wood along Town roads will not be allowed without permission from Bayfield County. Do not damage any monumentation, which are present along the east boundary. **Caution:** There are some steep slopes due to eskers (ravines) and dry kettle holes.

# Bayfield County Timber Sale Bid

Date: \_\_\_\_\_

I hereby submit my bid on timber sale number: 36-09

Description: T48N R8W Sec. 14, 23

Acres: 123

This sale can be purchased either by the cord or ton. Please indicate which product you are bidding on.

Species	Volume			Minimum Bid Per Cord or Mbf	Minimum Bid Per Ton	Total Minimum Bid Per Product	Bid Price Per Unit of Volume	Total Bid Per Product
	Cords	MBF	Tons*					
Aspen	2,120		6,710	\$25.73	\$8.13	\$54,547.60		
Jack Pine	470		1,466	\$29.05	\$9.31	\$13,653.50		
Scrub Oak	280		1,340	\$16.60	\$3.47	\$4,648.00		
White Birch	105		366	\$20.75	\$5.95	\$2,178.75		
Red Maple	125		554	\$23.24	\$5.24	\$2,905.00		
<b>Totals</b>	<b>3,100</b>	<b>0</b>	<b>10,436</b>	<b>Total Min. Bid =</b>		<b>\$77,932.85</b>	<b>Total Bid =</b>	

\*Tonnage volumes are based upon whole tree utilization. If the bid is based upon tons, then the timber sale contract will reflect this utilization.

Bid Price is based on unpeeled products.

Enclosed is the amount of \$ \_\_\_\_\_, which represents 10% of the stumpage value based on my total bid.

Name/Company: \_\_\_\_\_

Signature: \_\_\_\_\_

Address: \_\_\_\_\_

Telephone: \_\_\_\_\_

\*\*Please include the completed bid form and bid deposit in an envelope clearly marked "Timber Sale Bid Sale # \_\_\_\_" for each sale bid.

Submit bids to:  
 Bayfield County Forestry Department  
 Courthouse  
 Post Office Box 445  
 Washburn, WI 54891