

APPLICATION FOR PERMIT
BAYFIELD COUNTY, WISCONSIN

SUBMIT COMPLETED ORIGINAL
APPLICATION, TAX STATEMENT
AND FEE TO:

Bayfield County Zoning Department
P.O. Box 58
Washburn, WI 54891
(715) 373-6138

RECEIVED

MAY 29 2009

Bayfield Co. Zoning Dept.

Application No.: 09-0373
Date: _____
Zoning District: R-RB/class 1+3
Amount Paid: \$175
6/2/09 mg

INSTRUCTIONS: No permits will be issued until all fees are paid.
Checks are made payable to: Bayfield County Zoning Department.
DO NOT START CONSTRUCTION UNTIL ALL PERMITS HAVE BEEN ISSUED TO APPLICANT.
Changes in plans must be approved by the Zoning Department.

LAND USE SANITARY PRIVY CONDITIONAL USE SPECIAL USE B.O.A. OTHER _____

Use Tax Statement for Legal Description

Legal Description: _____ 1/4 of Section 05 Township 49 North, Range 04 West, Town of BAYVIEW

Gov't Lot _____ Lot 1 Block 1-3 Subdivision BAYVIEW BEACH CSM # _____ Acreage 6.710
LESS CSM 00602
Volume 942 Page 631 of Deeds Parcel I.D. 04-008-2-49-04-05-1 00-131-01000

Property Owner: JAMES E. LEAN Contractor _____ (Phone) _____

Address of Property 81675 BAYVIEW PARK ROAD Plumber _____
WASHBURN, WI 54891 Authorized Agent: RICK BUCKMAN (Phone) 715-373-2400
105 PECANS, LLC

Telephone 715-373-0644 (Home) 715-373-5388 (Work) Written Authorization Attached: Yes No
cell # 292-9563

Is your structure in a Shoreland Zone? Yes No If yes, _____

Structure: New _____ Addition _____ Existing Square Footage _____
Fair Market Value _____

USE: * Residence or Principal Structure (# of bedrooms) _____
 * Residence w/deck-porch (# of bedrooms) _____
 * Residence w/attached garage (# of bedrooms) _____
 * Residence sq. ft. _____ Porch sq. ft. _____
 * Residence sq. ft. _____ Deck(2) sq. ft. _____
 * Residence sq. ft. _____ Garage sq. ft. _____

Residential Addition / Alteration (explain) _____

Residential Accessory Building (explain) _____

Residential Accessory Building Addition (explain) _____

Residential Other (explain) _____

Commercial Principal Building _____

Commercial Principal Building Addition (explain) _____

Commercial Accessory Building (explain) _____

Commercial Accessory Building Addition (explain) _____

Commercial Other (explain) _____

Special/Conditional Use (explain) SEE UTIL PERMIT

External Improvements to Principal Building (explain) _____

External Improvements to Accessory Building (explain) _____

Mobile Home (manufactured date) _____

Owner or Authorized Agent (Signature) [Signature] Date 05/25/09

Address to send permit 77240 S. HOUGHTON POINTE RD, WASHBURN, WI 54891 ATTACH _____

* See Notice on Back Copy of Tax Statement or _____

(If you recently purchased the property Attach a Copy of Recorded Deed) _____

APPLICANT — PLEASE COMPLETE REVERSE SIDE

Permit Issued: _____ State Sanitary Number _____ Date _____

Date 9-1/09 Permit Number 09-0373 Permit Denied (Date) _____

Reason for Denial: _____

Inspection Record: Site inspection conducted with Karl Kestrowski. Short term rental of residence. Existing POWTS appears to be a conventional system, no paperwork on file. Parking area adequate for 3 vehicles.

6-11-09: contacted owner about By Travis Telbiszewsky Date of inspection 6-09-2009

drainfield (map of lot with sewer back edge of field), plan to meet in 2 weeks after he gets back from vacation.

Mitigation Plan Required: Yes No Variance (B.O.A.) # _____

Record for Issuance _____

Condition: _____

_____ AUG 29 2009

Secretary Staff _____

Signed Travis Telbiszewsky 8/28/2009 Date of Approval _____

Inspector _____

9-26-09: Ed Wroblewski: conducted inspection of existing septic system; inspection report attached.

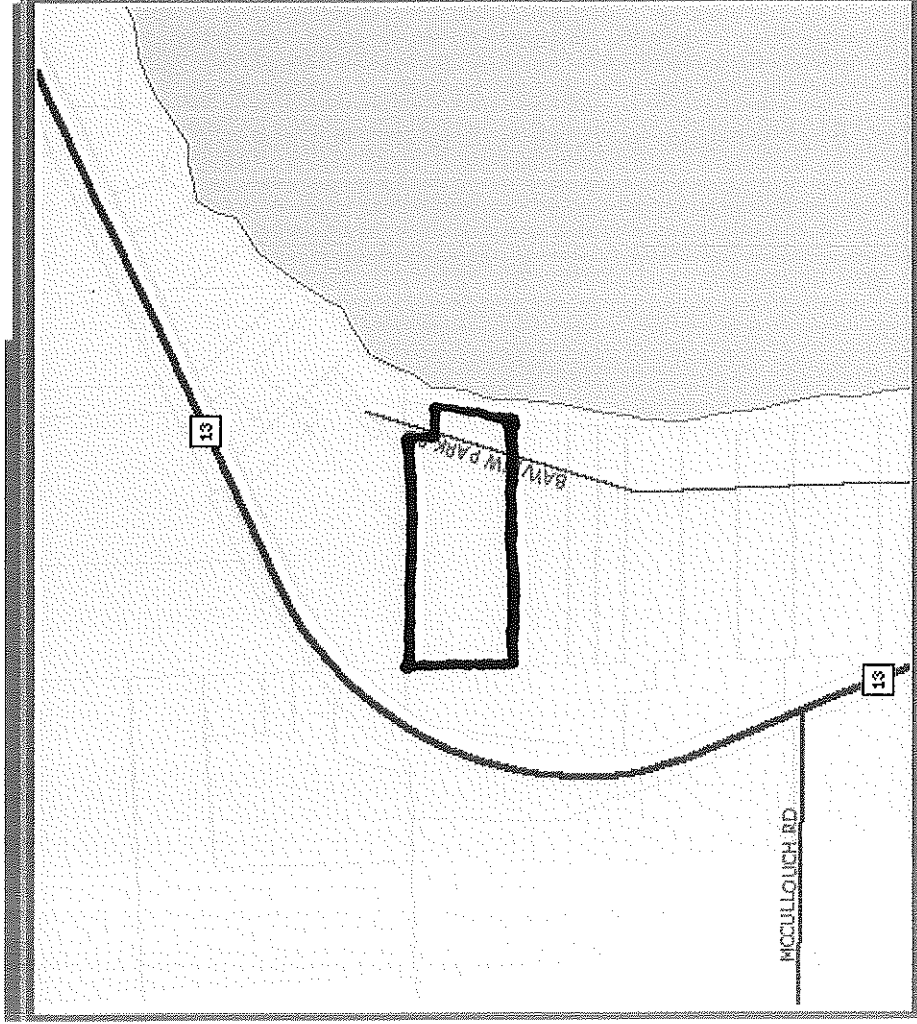

Query Results

Selected point is located in the Bayfield/Penninsula/Southeast watershed within the Town of Bayview and is found on the *Mount Ashwabay* USGS 7.5' quadrangle. It is zoned RRB (Residential-Recreational Busin). The district provides for permanent residential developments in neighborhood environments with water and/or se and other services/utilities. Such developments should be protected from traffic hazards and the intrusion of incompatible land uses. This location is within the Washburn School District and is in Supervisory District 4 is served by the Washburn Ambulance District and the Washburn Fire Department (715-373-6120).

JAMES E. LEAN
81675 BAYVIEW PARK RD
WASHBURN, WI 54891