

SUBMIT COMPLETED ORIGINAL APPLICATION, TAX STATEMENT AND FEE TO:

Bayfield County Zoning Department  
P.O. Box 58  
Washburn, WI 54891  
(715) 373-6138

APPLICATION FOR PERMIT  
BAYFIELD COUNTY, WISCONSIN

RECEIVED  
MAR 19 2009  
Bayfield Co. Zoning Dept

Application No.: 09-0221  
Date: \_\_\_\_\_  
Zoning District C-A-1  
Amount Paid: Unpaid -  
Excising Pit.

INSTRUCTIONS: No permits will be issued until all fees are paid. Checks are made payable to: Bayfield County Zoning Department. DO NOT START CONSTRUCTION UNTIL ALL PERMITS HAVE BEEN ISSUED TO APPLICANT. Changes in plans must be approved by the Zoning Department.

LAND USE  SANITARY  PRIVY  CONDITIONAL USE  SPECIAL USE  B.O.A.  OTHER \_\_\_\_\_

Use Tax Statement for Legal Description

Legal Description NE 1/4 of NE 1/4 of Section 24 Township 43 North, Range 8 West, Town of Cable

Gov't Lot \_\_\_\_\_ Lot \_\_\_\_\_ Block \_\_\_\_\_ Subdivision \_\_\_\_\_ CSM # \_\_\_\_\_ Acreage 8.27

Volume 663 Page 264 of Deeds Parcel I.D. 04-612-2-43-68-24-1-01-000-500.00

Property Owner Larry Rasmussen et al Contractor \_\_\_\_\_ (Phone) \_\_\_\_\_

Address of Property Cable, WI 548 Authorized Agent Mark Rasmussen (Phone) \_\_\_\_\_

Telephone (715) 798-3654 (Home) Same (Work) \_\_\_\_\_

Is your structure in a Shoreland Zone? Yes  No  **if yes.**

Structure: New NA Addition Existing \_\_\_\_\_ Distance from Shoreline: greater than 75'  75' to 40'  less than 40'

Fair Market Value NA Square Footage NA Sanitary: New \_\_\_\_\_ Existing \_\_\_\_\_ Privy \_\_\_\_\_ City \_\_\_\_\_

USE:  \* Residence or Principal Structure (# of bedrooms) \_\_\_\_\_ **Type of Septic/Sanitary System**

\* Residence sq. ft. \_\_\_\_\_  Mobile Home (manufactured date) \_\_\_\_\_

\* Residence w/deck-porch (# of bedrooms) \_\_\_\_\_  Commercial Principal Building \_\_\_\_\_

Residence sq. ft. \_\_\_\_\_ Porch sq. ft. \_\_\_\_\_  Commercial Principal Building Addition (explain) \_\_\_\_\_

Deck sq. ft. \_\_\_\_\_ Deck(2) sq. ft. \_\_\_\_\_  Commercial Accessory Building (explain) \_\_\_\_\_

\* Residence w/attached garage (# of bedrooms) \_\_\_\_\_  Commercial Accessory Building Addition (explain) \_\_\_\_\_

Residence sq. ft. \_\_\_\_\_ Garage sq. ft. \_\_\_\_\_  Commercial Other (explain) \_\_\_\_\_

Residential Addition / Alteration (explain) \_\_\_\_\_  Special/Conditional Use (explain) Gravel Pit

Residential Accessory Building (explain) \_\_\_\_\_  External Improvements to Principal Building (explain) \_\_\_\_\_

Residential Accessory Building Addition (explain) \_\_\_\_\_  External Improvements to Accessory Building (explain) \_\_\_\_\_

Residential Other (explain) \_\_\_\_\_

FAILURE TO OBTAIN A PERMIT OR STARTING CONSTRUCTION WITHOUT A PERMIT WILL RESULT IN PENALTIES. I (we) declare that this application (including any accompanying information) has been examined by me (us) and to the best of my (our) knowledge and belief it is true, correct and complete. I (we) acknowledge that I (we) am (are) responsible for the detail and accuracy of all information I (we) am (are) providing and that it will be relied upon by Bayfield County in determining whether to issue a permit. I (we) further accept liability which may be a result of Bayfield County relying on this information I (we) am (are) providing in or with this application. I (we) consent to county officials charged with administering county ordinances to have access to the above described property at any reasonable time for the purpose of inspection.

Owner or Authorized Agent (Signature) [Signature] Date 3-18-09

Address to send permit 42660 Cable Sunset Rd Cable, WI 54821 ATTACH

\* See Notice on Back Copy of Tax Statement of (If you recently purchased the property Attach a Copy of Recorded Deed)

APPLICANT - PLEASE COMPLETE REVERSE SIDE

Permit Issued: State Sanitary Number \_\_\_\_\_ Date \_\_\_\_\_

Date 6/18/09 Permit Number 09-0221 Permit Denied (Date) \_\_\_\_\_

Reason for Denial: \_\_\_\_\_

Inspection Record: Pit is existing. By M. Furtak Date of Inspection 3-12-09

Mitigation Plan Required: Yes  No  Variance (B.O.A.) # \_\_\_\_\_

Condition: see ZC decision and affidavit

Signed Michael Furtak Inspector 5-27-09 Date of Approval

Rec'd for Issuance

6

JUN 16 2009

Secretarial Staff

SENT BY ZONING

## Rasmussen Adjoining Property Owners Map

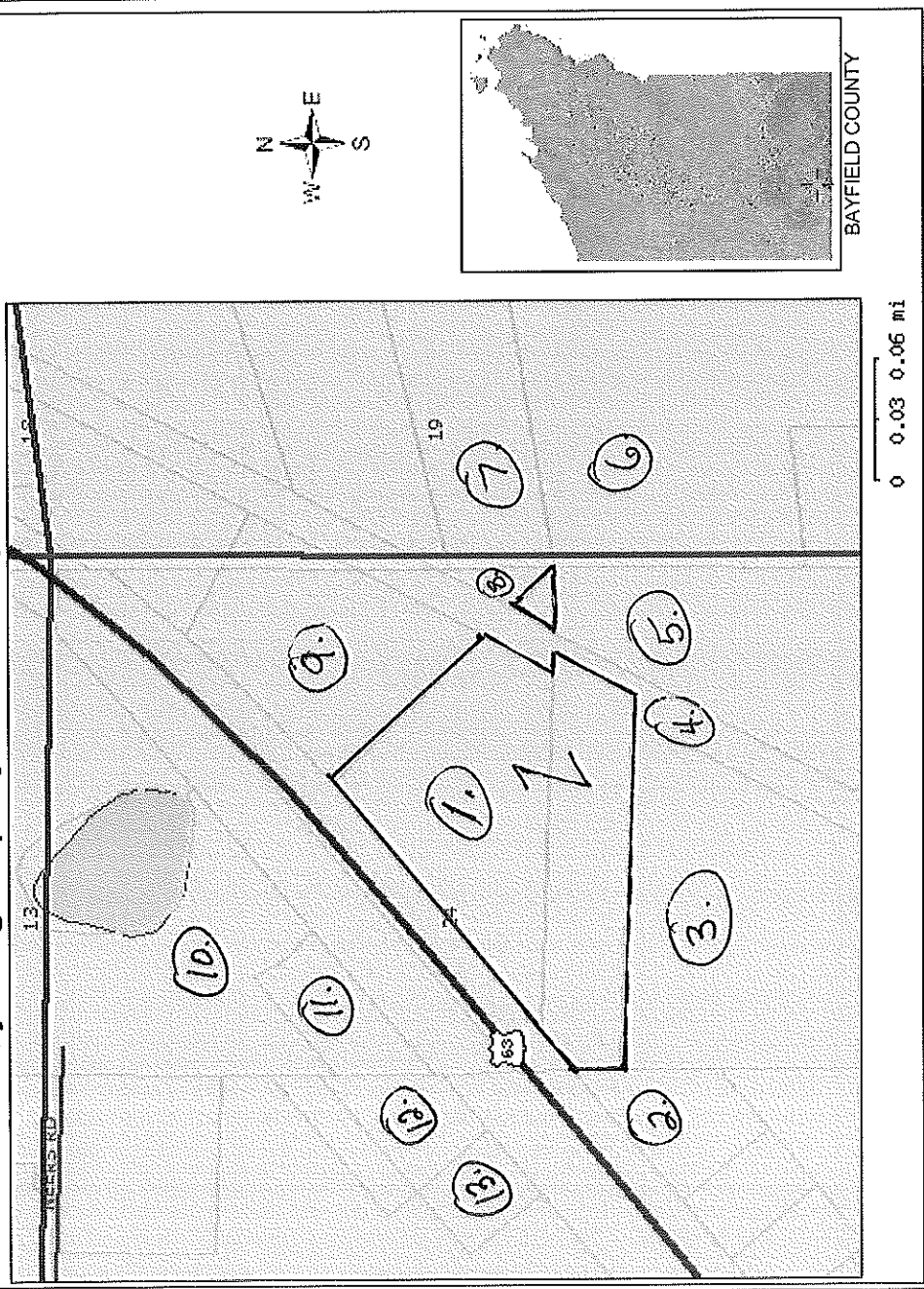

1. subject - Rasmussen et.al.
2. Pine Needles LLC
3. Annabel & Tore Gram (LE) et.al.
4. Bayfield County
5. Annabel & Tome Gram (LE) et.al.
6. Andry Rasmussen
7. Lee A. Wald et.al.
8. Rental Properties LLP Rasmussen Brothers
9. Rental Properties LLP Rasmussen Brothers
10. Patrick D. Cherney
11. Patrick D. Cherney
12. Interstate Energy Ltd.
13. Richard C. Menzel & L.S. Correll

