

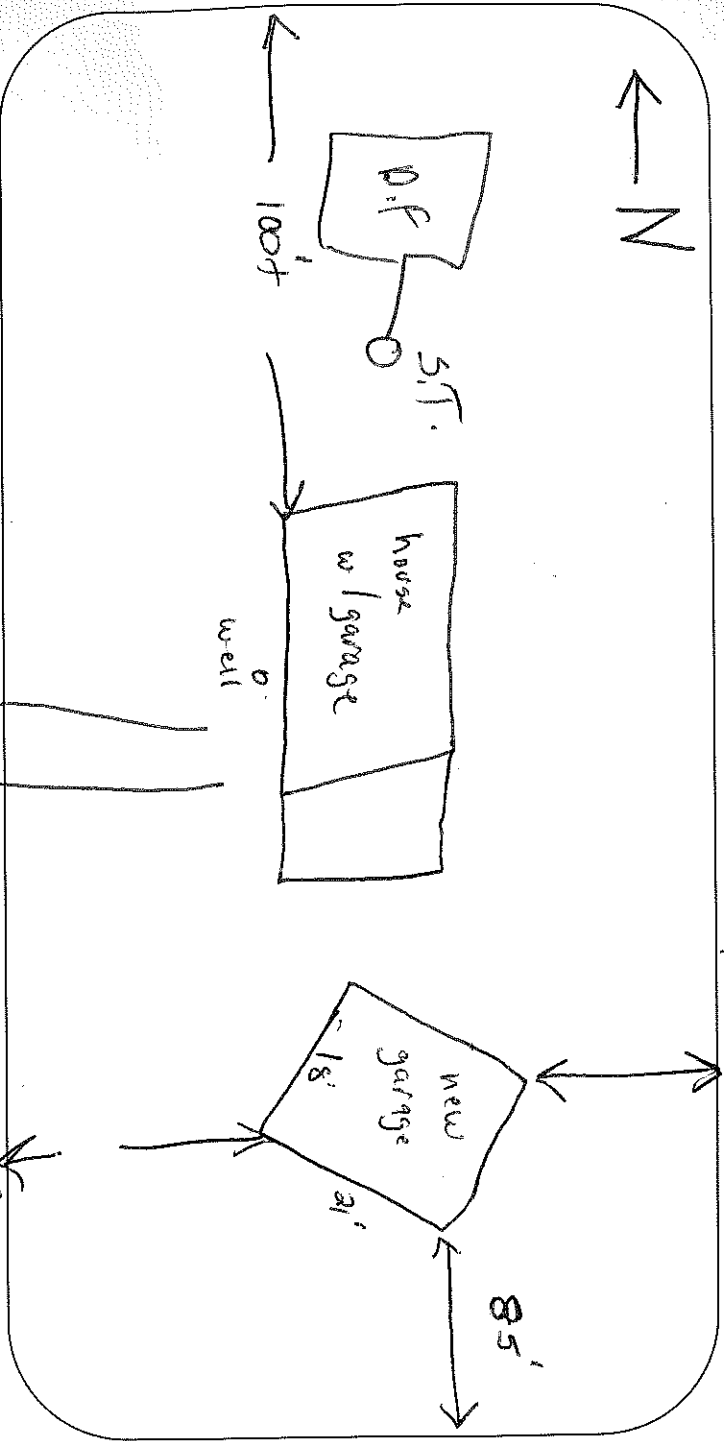

Draw or Sketch your Property (regardless of what you are applying for)

- (1) Show Location of: Proposed Construction
- (2) Show / Indicate: North (N) on Plot Plan
- (3) Show Location of (\*): (\*) Driveway and (\*) Frontage Road (Name Frontage Road)
- (4) Show: (\*) Show: All Existing Structures on your Property
- (5) Show any (\*): (\*) Well (W); (\*) Septic Tank (ST); (\*) Drain Field (DF); (\*) Holding Tank (HT) and/or (\*) Privy (P)
- (6) Show any (\*): (\*) Lake; (\*) River; (\*) Stream/Creek; or (\*) Pond
- (7) Show any (\*): (\*) Wetlands; or (\*) Slopes over 20%



Please complete (1) - (7) above (prior to continuing) **Perry Lake Rd** Changes in plans must be approved by the Planning & Zoning Dept.  
 (8) Setbacks: (measured to the closest point)

Description	Measurement	Description	Measurement
Setback from the Centerline of Platted Road	270 Feet	Setback from the Lake (ordinary high-water mark)	150'
Setback from the Established Right-of-Way	250 Feet	Setback from the River, Stream, Creek	N/A
Setback from the North Lot Line	100 Feet	Setback from the Bank or Bluff	N/A
Setback from the South Lot Line	85 + Feet	Setback from Wetland	N/A
Setback from the West Lot Line	N/A Feet	Setback from 20% slope Area	N/A
Setback from the East Lot Line	150 + Feet	Elevation of Floodplain	N/A
Setback to Septic Tank or Holding Tank	Feet	Setback to Well	Feet
Setback to Drain Field	Feet		
Setback to Privy (Portable, Composting)	N/A Feet		

Prior to the placement or construction of a structure within ten (10) feet of the minimum required setback, the boundary line from which the setback must be measured must be visible from one previously surveyed corner to the other previously surveyed corner or marked by a licensed surveyor at the owner's expense.  
 Prior to the placement or construction of a structure more than ten (10) feet but less than thirty (30) feet from the minimum required setback, the boundary line from which the setback must be measured must be visible from one previously surveyed corner to the other previously surveyed corner, or verifiable by the Department by use of a corrected compass from a known corner within 500 feet of the proposed site of the structure, or must be marked by a licensed surveyor at the owner's expense.

(9) Stake or Mark Proposed Location(s) of New Construction, Septic Tank (ST), Drain Field (DF), Holding Tank (HT), Privy (P), and Well (W).

NOTICE: All Land Use Permits Expire One (1) Year from the Date of Issuance if Construction or Use has not begun.  
 For The Construction Of New One & Two Family Dwelling: All Municipalities Are Required To Enforce The Uniform Dwelling Code.  
 The local Town, Village, City, State or Federal agencies may also require permits.

<b>Issuance Information (County Use Only)</b>		Sanitary Number:	# of bedrooms:	Sanitary Date:			
Permit Denied (Date):		Reason for Denial:					
Permit #: 12-0191	Permit Date: 6-14-12						
Is Parcel a Sub-Standard Lot	<input type="checkbox"/> Yes <input checked="" type="checkbox"/> No	Is Parcel in Common Ownership	<input type="checkbox"/> Yes <input checked="" type="checkbox"/> No	Mitigation Required	<input type="checkbox"/> Yes <input checked="" type="checkbox"/> No	Affidavit Required	<input type="checkbox"/> Yes <input checked="" type="checkbox"/> No
Is Structure Non-Conforming	<input type="checkbox"/> Yes <input checked="" type="checkbox"/> No	Granted by Variance (B.O.A.)	<input type="checkbox"/> Yes <input checked="" type="checkbox"/> No	Previously Granted by Variance (B.O.A.)	<input type="checkbox"/> Yes <input checked="" type="checkbox"/> No	Affidavit Attached	<input type="checkbox"/> Yes <input checked="" type="checkbox"/> No
Was Parcel Legally Created	<input checked="" type="checkbox"/> Yes <input type="checkbox"/> No	Case #:	Were Property Lines Represented by Owner	<input checked="" type="checkbox"/> Yes <input type="checkbox"/> No	Was Property Surveyed	<input checked="" type="checkbox"/> Yes <input type="checkbox"/> No	
Was Proposed Building Site Delineated	<input checked="" type="checkbox"/> Yes <input type="checkbox"/> No	Inspected by: M. Fields	Zoning District (A-1)		Lakes Classification (3)		
Inspection Record:		Date of Re-inspection:					
Well Staked. Metals all staked.		Date of Inspection: 6-14-12					
Conditions: Town, Committee or Board Conditions Attached? <input type="checkbox"/> Yes <input type="checkbox"/> No <input checked="" type="checkbox"/> No they need to be attached.		May not be used for human habitation. No water pressure in structure.					
Signature of Inspector: Michael F. Savelle		Date of Approval: 6-14-12					
Hold For Sanitary: <input type="checkbox"/>	Hold For TBA: <input type="checkbox"/>	Hold For Affidavit: <input type="checkbox"/>	Hold For Fees: <input type="checkbox"/>				