

SUBMIT COMPLETED ORIGINAL APPLICATION, TAX STATEMENT AND FEE TO:
 Bayfield County Zoning Department
 P.O. Box 58
 Washburn, WI 54891
 (715) 373-6138

APPLICATION FOR PERMIT
 BAYFIELD COUNTY, WISCONSIN

RECEIVED
 MAR 02 2012

Bayfield Co. Zoning Dept

INSTRUCTIONS: No permits will be issued until all fees are paid. Checks are made payable to: Bayfield County Zoning Department. DO NOT START CONSTRUCTION UNTIL ALL PERMITS HAVE BEEN ISSUED TO APPLICANT. Changes in plans must be approved by the Zoning Department.

Application No.: 12-0198
 Date: 6-21-12
 Zoning District: RRB, Class 2
 Amount Paid: \$250.00 POS
 3/5/12

LAND USE SANITARY PRIVY CONDITIONAL USE SPECIAL USE B.O.A. OTHER _____

Use Tax Statement for Legal Description

Legal Description NE 1/4 of SE 1/4 of Section 32 Township 45 North, Range 7 West Town of TRAVERS

Gov't Lot 2 Lot _____ Block _____ Subdivision _____ CSM # _____ Acreage 40.627

Volume 910 Page 711 of Deeds Parcel I.D. 04-018-2-45-07-32-105-002-50000

Property Owner TENNIS & DIAMOND Contractor NSA (Phone) 715-394-1009

Address of Property XXX Diamond Lake Rd Plumber _____

Diamond, WI, 54832 Authorized Agent PAUL KERNER (Phone) 73465533

Telephone _____ (Home) _____ (Work) _____ Written Authorization Attached: Yes No

Is your structure in a Shoreland Zone? Yes No If Yes, Distance from Shoreline: greater than 75' 75 to 40' less than 40'

Structure: New Addition _____ Existing _____ Basement: Yes _____ No Number of Stories _____

Fair Market Value \$45,000 Square Footage 1000 sq. ft. Sanitary: New Existing _____ Privy _____ City

USE: * Residence or Principal Structure (# of bedrooms) _____ Type of Septic/Sanitary System _____

* Residence w/attached garage (# of bedrooms) _____ Commercial Principal Building SHOWER/RESTROOM/LAUNDRY

Residence sq. ft. _____ Porch sq. ft. _____ Commercial Principal Building Addition (explain) _____

* Residence w/attached garage (# of bedrooms) _____ Commercial Accessory Building (explain) _____

Residence sq. ft. _____ Garage sq. ft. _____ Commercial Accessory Building Addition (explain) _____

Residential Addition / Alteration (explain) _____ Commercial Other (explain) _____

Residential Accessory Building (explain) _____ Special/Conditional Use (explain) _____

Residential Accessory Building Addition (explain) _____ External Improvements to Principal Building (explain) _____

Residential Other (explain) _____ External Improvements to Accessory Building (explain) _____

FAILURE TO OBTAIN A PERMIT OR STARTING CONSTRUCTION WITHOUT A PERMIT WILL RESULT IN PENALTIES.

I (we) declare that this application (including any accompanying information) has been examined by me (us) and to the best of my (our) knowledge and belief it is true, correct and complete. I (we) acknowledge that I (we) am (are) responsible for the detail and accuracy of all information I (we) am (are) providing and that it will be relied upon by Bayfield County in determining whether to issue a permit. I (we) further accept liability which may be a result of Bayfield County relying on this information I (we) am (are) providing in or with this application. I (we) consent to county officials charged with administering county ordinances to have access to the above described property at any reasonable time for the purpose of inspection.

Owner or Authorized Agent (Signature) Dennis Johnson Date 3-2-12

Address to send permit PO Box 58 Washburn, WI 54832 ATTACH _____

* See Notice on Back APPLICANT - PLEASE COMPLETE REVERSE SIDE Copy of Tax Statement or Attach a Copy of Recorded Deed

Permit Issued: State Sanitary Number _____ Date _____

Date 6-21-12 Permit Number 12-0198 Permit Denied (Date) _____

Reason for Denial: _____

Inspection Record: Site is vacant land. By M. Furtak Date of Inspection 5-1-12

Mitigation Plan Required: Yes No Variance (B.O.A.) # _____

Condition: see ZC decision & affidavit

Record for Issuance Signed Michael Furtak Date of Approval 6-8-12

JUN 21 2012

City of Washburn

City of Washburn

City of Washburn

City of Washburn

City of Washburn

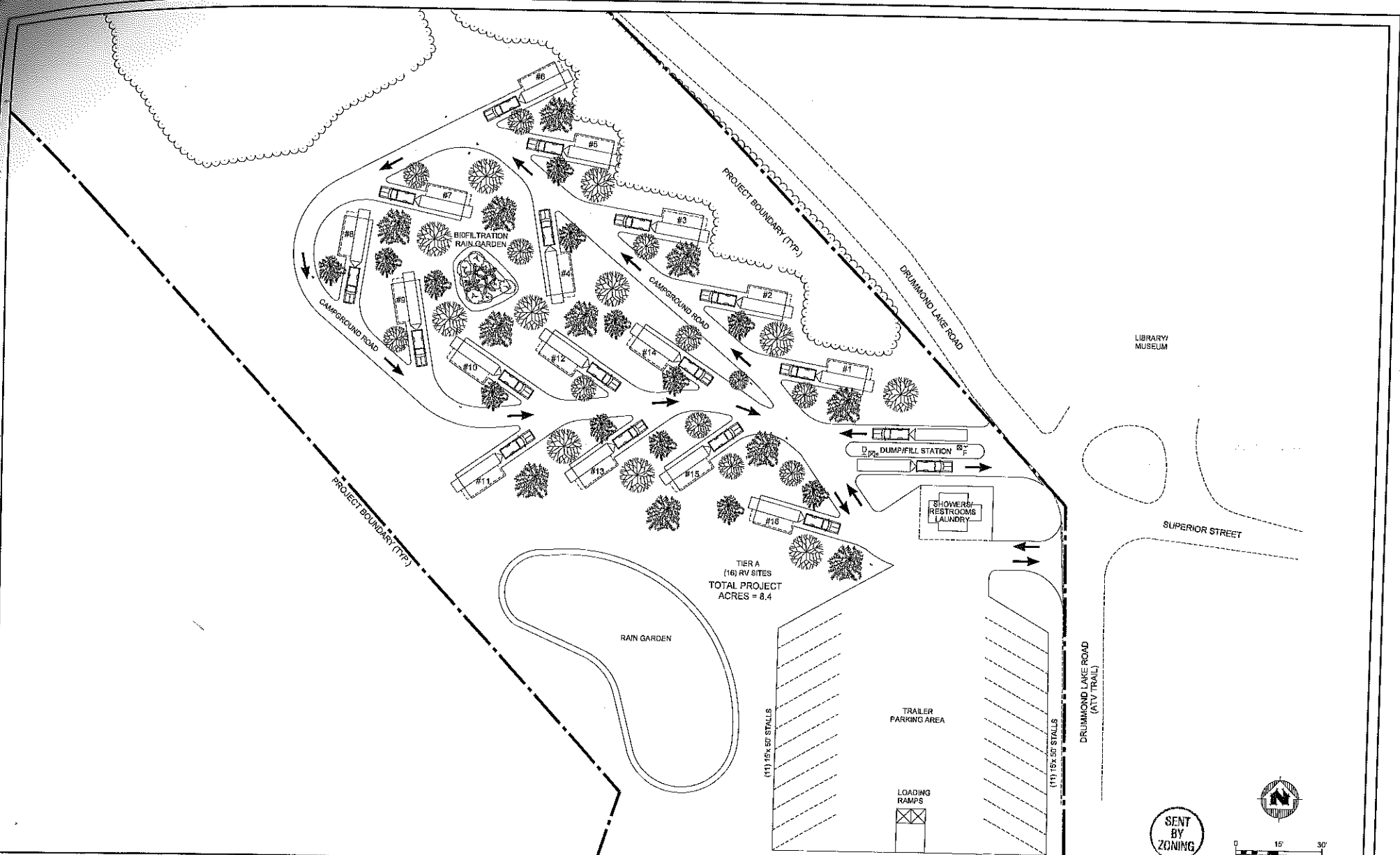

TIER A
 (16) RV SITES
 TOTAL PROJECT
 ACRES = 8.4

SENT
 BY
 ZONING



PROJECT FILE	DATE	SCALE	ABACUS	NO.	DATE	REVISION
DRUMMOND	05/20/11	AS SHOWN	101	05/20/11		
PROJECT DATE	05/20/11	DRAWN BY	EM			
DESIGNED BY	EM					



TRANSPORTATION • MUNICIPAL
 DEVELOPMENT • ENVIRONMENTAL
 ENGINEERING • SURVEYING
 315.574.7000 • 900.800.4141 • WWW.MSA-PA.COM

OVERALL RV PARK LAYOUT PLAN

DRUMMOND ROAD RV PARK AND TRAIL HEAD

PAPER NO. 0000000000