

SUBMIT COMPLETED ORIGINAL APPLICATION, TAX STATEMENT AND FEE TO:

Bayfield County Zoning Department
P.O. Box 58
Washburn, WI 54891
(715) 373-6138

APPLICATION FOR PERMIT
BAYFIELD COUNTY, WISCONSIN

RECEIVED
MAY 12 2011

Bayfield Co. Zoning Dept.

INSTRUCTIONS: No permits will be issued until all fees are paid. Checks are made payable to: Bayfield County Zoning Department. DO NOT START CONSTRUCTION UNTIL ALL PERMITS HAVE BEEN ISSUED TO APPLICANT. Changes in plans must be approved by the Zoning Department.

Application No.: 11-0131
Date: 5-25-11
Zoning District: Commercial
Amount Paid: \$125.00 EOS
5/24/11

ENTERED

LAND USE SANITARY PRIVY CONDITIONAL USE SPECIAL USE B.O.A. OTHER

Legal Description 1/4 of 1/4 of Section 8 Township 47 North, Range 8 West, Town of Iron River

Gov't Lot 5-24 Block 3 Subdivision Hessel's CSM # 1.148

Volume 783 Page 899 of Deeds Parcel I.D. 04-074-2-47-08-08-3-00-1A2-15000

Property Owner Ryan Seidel Couple Contractor Selis-Wagner MASE (Phone)

Address of Property Highway 2 8205 Hwy 2

Plumber

Iron River WI 54847 Authorized Agent (Phone)

Telephone 715-373-6115 (Home) (Work)

Written Authorization Attached: Yes No

Is your structure in a Shoreland Zone? Yes No If Yes, Distance from Shoreline: greater than 75' 75' to 40' less than 40'

Structure: New Addition Existing Basement: Yes No Number of Stories 1

Fair Market Value 7000⁰⁰ Square Footage 360 Sanitary: New Existing Privy City

USE: Residence or Principal Structure (# of bedrooms) Mobile Home (manufactured date)

Residence sq. ft. Commercial Principal Building Commercial Principal Building Addition (explain) Picked Road

Residence w/deck-porch (# of bedrooms) Commercial Accessory Building (explain)

Residence sq. ft. Commercial Accessory Building Addition (explain)

Deck sq. ft. Commercial Other (explain)

Residence sq. ft. Special/Conditional Use (explain)

Residential Addition / Alteration (explain) External Improvements to Principal Building (explain)

Residential Accessory Building (explain) External Improvements to Accessory Building (explain)

Residential Accessory Building Addition (explain)

Residential Other (explain)

FAILURE TO OBTAIN A PERMIT OR STARTING CONSTRUCTION WITHOUT A PERMIT WILL RESULT IN PENALTIES

I (we) declare that this application (including any accompanying information) has been examined by me (us) and to the best of my (our) knowledge and belief it is true, correct and complete. I (we) acknowledge that I (we) am (are) responsible for the detail and accuracy of all information I (we) am (are) providing and that it will be relied upon by Bayfield County in determining whether to issue a permit. I (we) further accept liability which may be a result of Bayfield County relying on this information I (we) am (are) providing in or with this application. I (we) consent to county officials charged with administering county ordinance to have access to the above described property at any reasonable time for the purpose of inspection.

Owner or Authorized Agent (Signature) Paul Hessel Date 5-12-11

Address to send permit 311 W 1st Ave - Washburn WI 54891

ATTACH

* See Notice on Back Copy of Tax Statement or Attach a Copy of Recorded Deed

APPLICANT - PLEASE COMPLETE REVERSE SIDE

Permit Issued: State Sanitary Number Date 5-25-11 Permit Number 11-0131 Permit Denied (Date)

Reason for Denial: Inspection Record: Property is located and already subject to various/catchments as mentioned by

catchment were not done. BY DR Date of Inspection 5-11-11

Mitigation Plan Required: Yes No Variance (B.O.A.) #

Condition:

Comments - like water/fence check Signed Inspector Date of Approval 5-17-11

Kraft

Lot Line

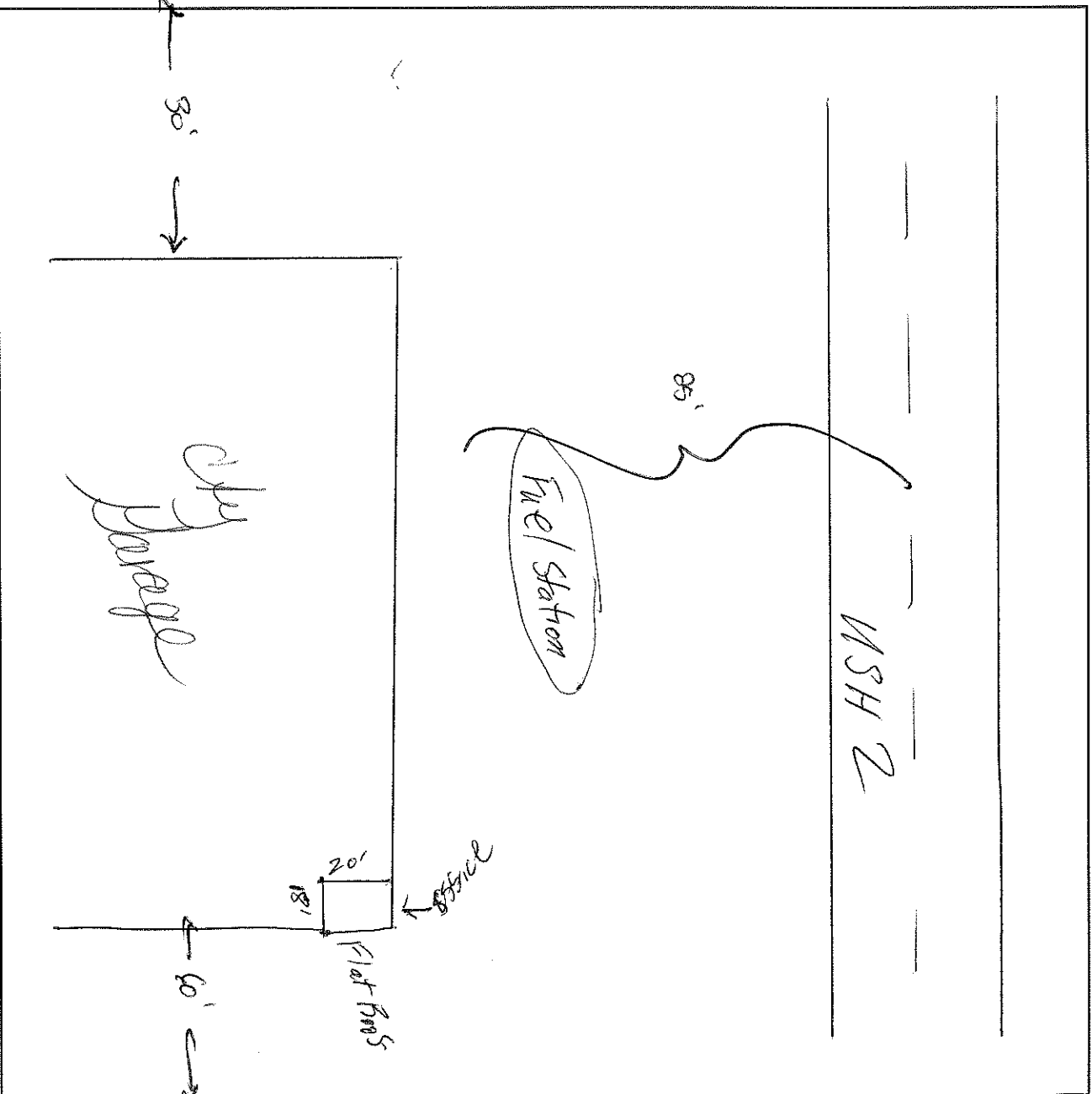

Name of Frontage Road (_____)

1. Name the frontage road and use as a guideline, fill in the lot dimensions and indicate North (N).
2. Show the location, size and dimensions of the structure.
3. Show the location, size and dimensions of attached deck(s), porch(s) or garage.
4. Show the location of the well, holding tank, septic tank and drain field.
5. Show the location of any lake, river, stream or pond if applicable.
6. Show the location of other existing structures.
7. Show the location of any wetlands or slopes over 20 percent.
8. Show dimensions in feet on the following:
 - a. Building to all lot lines
 - b. Building to centerline of road
 - c. Building to lake, river, stream or pond
 - d. Holding tank to closest lot line
 - e. Holding tank to building
 - f. Holding tank to well
 - g. Holding tank to lake, river, stream or pond
 - h. Privy to closest lot line
 - i. Privy to building
 - j. Privy to lake, river, stream or pond
 - k. Septic Tank and Drain field to closest lot line
 - l. Septic Tank and Drain field to building
 - m. Septic Tank and Drain field to well
 - n. Septic Tank, and Drain field to lake, river, stream or pond.
 - o. Well to building

IMPORTANT
 DETAILED PLOT PLAN
 IS NECESSARY, FOLLOW
 STEPS 1-8 (a-o) COMPLETELY

*NOTICE: All Land Use Permits Expire One (1) Year From The Date Issued.

For The Construction Of New One & Two Family Dwellings: ALL Municipalities Are Required To Enforce The Uniform Dwelling Code.
 You Must Contact Your Town Chairman / Clerk For More Information.

The local town, village, city, state or federal agencies may also require permits.

Stake or mark proposed location(s) of new building, holding tank, septic, drain field, privy, and well. Inspector will not make an inspection until location(s) are staked or marked.