

**SUBMIT COMPLETED ORIGINAL APPLICATION, TAX STATEMENT AND FEE TO:**  
 Bayfield County Zoning Department  
 P.O. Box 58  
 Washburn, WI 54891  
 (715) 373-6138

**APPLICATION FOR PERMIT  
 BAYFIELD COUNTY, WISCONSIN**

**RECEIVED**  
 MAY 16 2008  
 Bayfield Co. Zoning Dept.

ENTERED

Application No.: 08-0155  
 Date: \_\_\_\_\_  
 Zoning District: AG-1  
 Amount Paid: \$125.00 RDS  
5/16/08

INSTRUCTIONS: No permits will be issued until all fees are paid. Checks are made payable to: Bayfield County Zoning Department. DO NOT START CONSTRUCTION UNTIL ALL PERMITS HAVE BEEN ISSUED TO APPLICANT. Changes in plans must be approved by the Zoning Department.

LAND USE  SANITARY  PRIVY  CONDITIONAL USE  SPECIAL USE  B.O.A.  OTHER \_\_\_\_\_  
 Legal Description NE 1/4 of SE 1/4 of Section 20 Township 47 North, Range 6 West, Town of KEYSIDING

Gov't Lot \_\_\_\_\_ Lot \_\_\_\_\_ Block \_\_\_\_\_ Subdivision \_\_\_\_\_ CSM # 27. Acreage \_\_\_\_\_  
 Volume 203 Page 596 of Deeds Parcel I.D. # 028100409990 Use Tax Statement for Legal Description \_\_\_\_\_

Property Owner BRUCE FELKER Contractor \_\_\_\_\_ (Phone) \_\_\_\_\_  
 Address of Property 2025 HWY 6 Plumber \_\_\_\_\_  
ASHLAND, WI Authorized Agent \_\_\_\_\_ (Phone) \_\_\_\_\_

Telephone 920-233-9051 (Home) 920-450-4520 (Work) Written Authorization Attached: Yes  No

Is your structure in a Shoreland Zone? Yes  No  If yes, \_\_\_\_\_ Distance from Shoreline: greater than 75'  75' to 40'  less than 40'

Structure: New  Addition  Existing  Basement: Yes  No  Number of Stories 1  
 Estimated Cost of Construction \$6,900. Square Footage 864 Sanitary: New \_\_\_\_\_ Existing \_\_\_\_\_ Privy \_\_\_\_\_ City \_\_\_\_\_

USE:  \* Residence or Principal Structure (# of bedrooms) pole bldg (2x150) Mobile Home (manufactured date) \_\_\_\_\_  
 Residence sq. ft. \_\_\_\_\_

\* Residence w/deck-porch (# of bedrooms) \_\_\_\_\_ Commercial Principal Building \_\_\_\_\_  
 Residence sq. ft. \_\_\_\_\_ Porch sq. ft. \_\_\_\_\_  Commercial Principal Building Addition (explain) \_\_\_\_\_

Deck sq. ft. \_\_\_\_\_ Deck(2) sq. ft. \_\_\_\_\_  Commercial Accessory Building (explain) \_\_\_\_\_  
 \* Residence w/attached garage (# of bedrooms) \_\_\_\_\_  Commercial Accessory Building Addition (explain) \_\_\_\_\_

Residence sq. ft. \_\_\_\_\_ Garage sq. ft. \_\_\_\_\_  Commercial Other (explain) \_\_\_\_\_  
 Residential Addition / Alteration (explain) \_\_\_\_\_  Special/Conditional Use (explain) \_\_\_\_\_

Residential Accessory Building (explain) \_\_\_\_\_  External Improvements to Principal Building (explain) \_\_\_\_\_  
 Residential Accessory Building Addition (explain) \_\_\_\_\_  External Improvements to Accessory Building (explain) \_\_\_\_\_

Residential Other (explain) \_\_\_\_\_

FAILURE TO OBTAIN A PERMIT OR STARTING CONSTRUCTION WITHOUT A PERMIT WILL RESULT IN PENALTIES. I (we) declare that this application (including any accompanying information) has been examined by me (us) and to the best of my (our) knowledge and belief it is true, correct and complete. I (we) acknowledge that I (we) am (are) responsible for the detail and accuracy of all information I (we) am (are) providing and that it will be relied upon by Bayfield County in determining whether to issue a permit. I (we) further accept liability which may be a result of Bayfield County relying on this information I (we) am (are) providing in or with this application. I (we) consent to county officials charged with administering county ordinances to have access to the above described property at any reasonable time for the purpose of inspection.

Owner or Authorized Agent (Signature) Bruce Felker Date 5/16/08

Address to send permit 145 W 21st AVE OSHKOSH, WI 54902 ATTACH Copy of Tax Statement

\* See Notice on Back APPLICANT - PLEASE COMPLETE REVERSE SIDE If you previously purchased the property Attach a Copy of Recorded Deed

Permit Issued: State Sanitary Number \_\_\_\_\_ Date \_\_\_\_\_

Date 5/10/08 Permit Number 08-0155 Permit Denied (Date) \_\_\_\_\_

Reason for Denial: \_\_\_\_\_

Inspection Record: Meets code requirements per owners representation. Proposed bldg site staked and West property was flagged. By Travis Tuborby Date of Inspection 5/19/2008

Mitigation Plan Required: Yes  No  Variance (B.O.A.) # \_\_\_\_\_

Condition: No human habitation.

Signed Travis Tuborby Date of Approval 5/19/2008  
 Inspector

Rec'd for Issuance

MAY 20 2008

Secretarial Staff

S. Lot Line

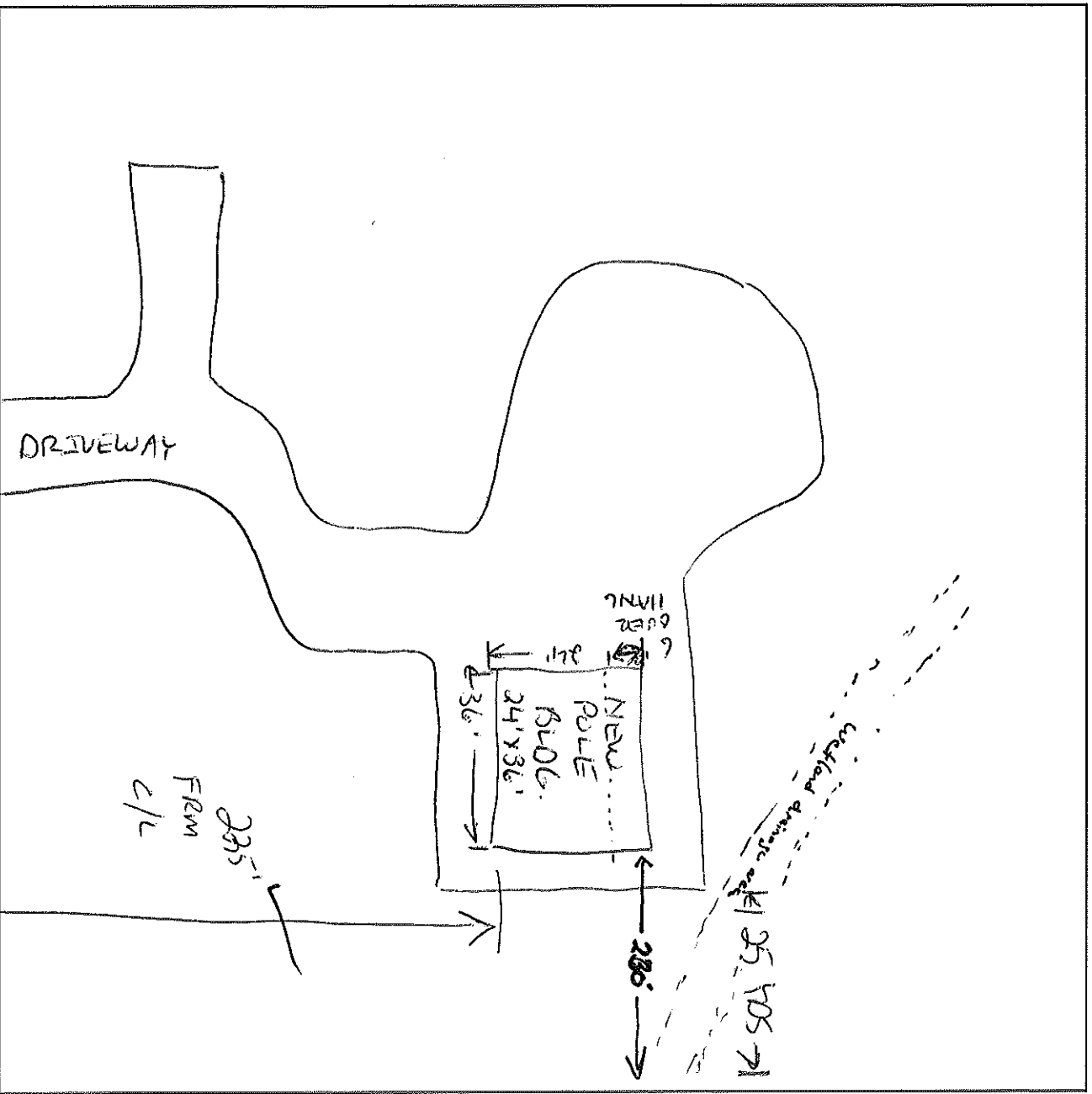

Name of Frontage Road ( Hwy G )

1. Name the frontage road and use as a guideline, fill in the lot dimensions and indicate North (N).
2. Show the location, size and dimensions of the structure - (include any deck(s), porch or garage)
3. Show the location of the well, septic tank and drain field.
4. Show the location of any lake, river, stream or pond if applicable.
5. Show the approximate location of other existing structures.
6. Show the approximate location of any wetlands or slopes over 20 percent.
7. Show dimensions in feet on the following:
  - a. Building to all lot lines
  - b. Building to centerline of road
  - c. Building to lake, river, stream or pond
  - d. Septic tank to closest lot line
  - e. Septic tank to building
  - f. Septic tank to well
  - g. Septic tank to lake, river, stream or pond
  - h. Privy to closest lot line
  - i. Privy to building
  - j. Privy to lake, river, stream or pond
  - k. Drain field to closest lot line
  - l. Drain field to building
  - m. Drain field to well
  - n. Drain field to lake, river, stream or pond.
  - o. Well to building

**IMPORTANT**  
DETAILED PLOT PLAN  
IS NECESSARY, FOLLOW  
STEPS 1-7 (a-o) COMPLETELY.

\*NOTICE: All Land Use Permits Expire One (1) Year From The Date Issued.

For The Construction Of New One & Two Family Dwellings: ALL Municipalities Are Required To Enforce The Uniform Dwelling Code.  
You Must Contact Your Town Chairman / Clerk For More Information.

The local town, village, city, state or federal agencies may also require permits.

Stake or mark proposed location(s) of new building, septic, drain field, privy, and well. Inspector will not make an inspection until location(s) are staked or marked.