

BAYFIELD COUNTY SANITARY PERMIT APPLICATION

I. APPLICATION INFORMATION (Please Print All Information)		Soil Test No:	County Permit No:	ENTERED		
Property Owner's Name <i>Reid, Lori / Ashland WI 54806</i>		County:	Bayfield			
Address of Property <i>67680 Cross Rd, Ashland, WI 54806</i>		Property Location:	T 47 N, R 6 E (or) W			
Property Owner's Mailing Address <i>67680 Cross Rd, Ashland, WI 54806</i>		Township <i>Pilsen</i>	Gov. Lot #:			
City, State <i>Ashland, WI</i>	Zip Code <i>54806</i>	Lot #	Block #:	Subdivision Name or CSM #:		
II. TYPE OF BUILDING: (Check One)						
<input type="checkbox"/> State Owned <input type="checkbox"/> Public (Explain the use/purpose _____) <input checked="" type="checkbox"/> 1 or 2 Family Dwelling - No. of Bedrooms _____						
III. TYPE OF PERMIT: (Check only one box on line A. Check box on line B, if applicable)						
A) <input checked="" type="checkbox"/> New <input type="checkbox"/> Replacement <input type="checkbox"/> County Private Interceptor 1. <input type="checkbox"/> Reconnection 2. <input type="checkbox"/> Repair 3. <input type="checkbox"/> Revision ** <input type="checkbox"/> Transfer of Owner (List Previous Owner below) _____						
B) <input type="checkbox"/> A Sanitary Permit was previously issued. <i>Previous Permit Number:</i> _____ Date Issued: _____						
IV. TYPE OF NON-PLUMBING SYSTEM: (Check One) * Replacements need previous permit number and date filled out above						
C) <input type="checkbox"/> Pit Privy <input type="checkbox"/> Vault Privy (Vault size: _____ gallons or _____ cubic yards) <input type="checkbox"/> Portable Privy (Temporary Use Only) <input checked="" type="checkbox"/> Composting Toilets <input type="checkbox"/> Incinerating Toilet						
V. ABSORPTION SYSTEM INFORMATION:						
1. Gallons Per Day	2. Absorp. Area Required (Sq. Ft.)	3. Absorp. Area Proposed (Sq. Ft.)	4. Loading Rate (Gals. / Day / Sq. Ft.)	5. Perc. Rate (Min. Inch)	6. System Elev.(Feet)	7. Final Grade Elev. (Feet)
VI. TANK INFORMATION:		Capacity In Gallons	Total Gallons	Manufacturer's Name	Prefab. Concrete	Site Constructed
Septic Tank or Holding Tank		New Tanks	Existing Tanks	<i>biolet</i>		Fiber-glass
Lift Pump Tank / Siphon Chamber						Steel
						Plastic
						Exper. App.
VII. RESPONSIBILITY STATEMENT:						
I the undersigned, assume responsibility for installation of the onsite sewage system shown on the attached plans.						
Plumber's / Owner's Name: (Print) <i>AARON REID</i>		Plumber's / Owner's Signature: (No Stamps) MP/MPRSW No: <i>Lori Reid</i>				
Plumber's Address: (Street, City State, Zip Code) <i>67680 Cross Rd, Ashland, WI 54806</i>		Home Phone: <i>715-746-7133</i>	Business Phone: <i>N/A</i>			
VIII. COUNTY / DEPARTMENT USE ONLY						
<input checked="" type="checkbox"/> Approved		Sanitary Permit/Transfer Fee: <i>\$150</i>	Date Issued: <i>8/24/09</i>	Issuing Agent's Signature / Date: <i>Tami Tubenueghy 8/21/2009</i>		
<input type="checkbox"/> Disapproved		Owner Given Initial Adverse Determination				
IX. CONDITIONS OF APPROVAL / REASONS FOR DISAPPROVAL:						
<i>- Per recorded Privy Agreement.</i>						

Rec'd for Issuance
AUG 21 2009

Secretarial Staff Plot Plan on reverse side

Lot Line

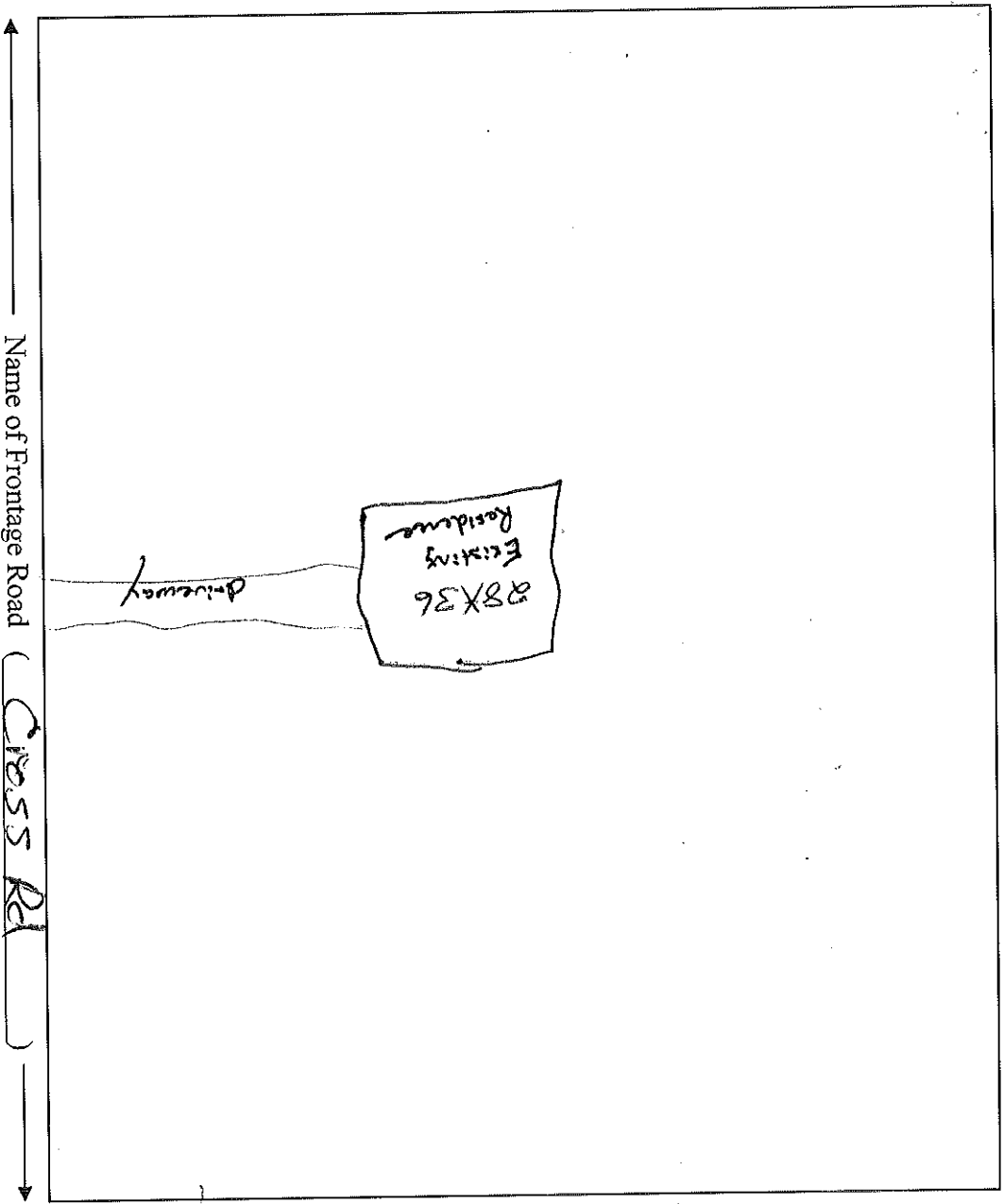

**IMPORTANT
DETAILED PLOT PLAN
IS NECESSARY, FOLLOW
STEPS 1-7 COMPLETELY**

1. Name the frontage road and use as a guideline, fill in the lot dimensions and indicate North (N).
2. Show the approximate location and size of the building.
3. Show the location of the well, septic tank and drain field.
4. Show the location of any lake, river, stream or pond if applicable.
5. Show the approximate location of other existing structures.
6. Show the approximate location of any wetlands or slopes over 20 percent.
7. Show dimensions in feet on the following:
 - a. Building to all lot lines
 - b. Building to centerline of road
 - c. Building to lake, river, stream or pond
 - d. Septic / holding tank to closest lot line
 - e. Septic/holding tank to building
 - f. Septic / holding tank to well
 - g. Septic / holding tank to lake, river, stream or pond
 - h. Privy to closest lot line
 - i. Privy to building
 - j. Privy to lake, river, stream or pond
 - k. Drain field to closest lot line
 - l. Drain field to building
 - m. Drain field to well
 - n. Drain field to lake, river, stream or pond
 - o. Well to building