

SUBMIT COMPLETED ORIGINAL APPLICATION, TAX STATEMENT AND FEE TO:  
 Bayfield County Zoning Department  
 P.O. Box 58  
 Washburn, WI 54891  
 (715) 373-6138

APPLICATION FOR PERMIT  
 BAYFIELD COUNTY, WISCONSIN

Application No. 16-0017  
 Date: \_\_\_\_\_  
 Zoning District: A-1  
 Amount Paid: 75 1/21/10 mg

RECEIVED

JAN 21 2010

INSTRUCTIONS: No permits will be issued until all fees are paid. Checks are made payable to: Bayfield County Zoning Department. DO NOT START CONSTRUCTION UNTIL ALL PERMITS HAVE BEEN ISSUED TO APPLICANT. Changes in plans must be approved by the Zoning Department.

LAND USE  SANITARY  PRIVY  CONDITIONAL USE  SPECIAL USE  B.O.A.  OTHER

Use Tax Statement for Legal Description

Legal Description: THAT PART OF NW 1/4 of Section 28 Township 51 North, Range 4 West, Town of Russell lying North and East of SH13

Volume \_\_\_\_\_ Page \_\_\_\_\_ of Deeds Parcel I.D. 04-046-2-51-04-28-2 03-000-10000

Property Owner Thomas J. Galuzza Contractor None (Phone) \_\_\_\_\_

Address of Property Town of Russell Plumber \_\_\_\_\_

Telephone 715-779-3255 (Home) \_\_\_\_\_ (Work) \_\_\_\_\_ Authorized Agent \_\_\_\_\_ (Phone) \_\_\_\_\_

Is your structure in a Shoreland Zone? Yes  No  if yes. Distance from Shoreline: greater than 75'  75' to 40'  less than 40'

Structure: New  Addition  Existing  Basement: Yes  No  Number of Stories 1  
 Fair Market Value 2,000.00 Square Footage \_\_\_\_\_  
 USE: see tax as i.c.r. Sanitary: New  Existing  Privy  City \_\_\_\_\_

- \* Residence or Principal Structure (# of bedrooms) \_\_\_\_\_
- Residence sq. ft. \_\_\_\_\_
- \* Residence w/deck-porch (# of bedrooms) \_\_\_\_\_
- Residence sq. ft. \_\_\_\_\_ Porch sq. ft. \_\_\_\_\_
- Deck sq. ft. \_\_\_\_\_ Deck(2) sq. ft. \_\_\_\_\_
- \* Residence w/attached garage (# of bedrooms) \_\_\_\_\_
- Residence sq. ft. \_\_\_\_\_ Garage sq. ft. \_\_\_\_\_
- Residential Addition / Alteration (explain) \_\_\_\_\_
- Residential Accessory Building (explain) wind tower < 110'
- Residential Accessory Building Addition (explain) \_\_\_\_\_
- Residential Other (explain) \_\_\_\_\_
- External Improvements to Accessory Building (explain) \_\_\_\_\_

FAILURE TO OBTAIN A PERMIT OR STARTING CONSTRUCTION WITHOUT A PERMIT WILL RESULT IN PENALTIES

I (we) declare that this application (including any accompanying information) has been examined by me (us) and to the best of my (our) knowledge and belief it is true, correct and complete. I (we) acknowledge that I (we) am (are) responsible for the detail and accuracy of all information I (we) am (are) providing and that it will be relied upon by Bayfield County in determining whether to issue a permit. I (we) further accept liability which may be a result of Bayfield County relying on this information I (we) am (are) providing in or with this application. I (we) consent to county officials charged with administering county ordinances to have access to the above described property at any reasonable time for the purpose of inspection.

Owner or Authorized Agent (Signature) Thomas J. Galuzza Date 1-20-10

Address to send permit 86760 Valley Rd, Bayfield, WI 54814 ATTACH

\* See Notice on Back APPLICANT - PLEASE COMPLETE REVERSE SIDE (If you recently purchased the property Attach a Copy of Recorded Deed)

Permit Issued: \_\_\_\_\_ State Sanitary Number \_\_\_\_\_ Date \_\_\_\_\_  
 Date 2-4-10 Permit Number 10-0017 Permit Denied (Date) \_\_\_\_\_

Reason for Denial: \_\_\_\_\_

Inspection Record: Structural Safety/Conditions as represented by under appears to be good  
Complete & w. Permit may be By ML Date of Inspection 2-2-10

Mitigation Plan Required: Yes  No  Variance (B.O.A.) # \_\_\_\_\_

Condition: \_\_\_\_\_

Nearby site using driveway Signed [Signature] Inspector \_\_\_\_\_  
 Date of Approval 2-2-10

Areas to be newly-constructed  
unnecessary

Lot Line

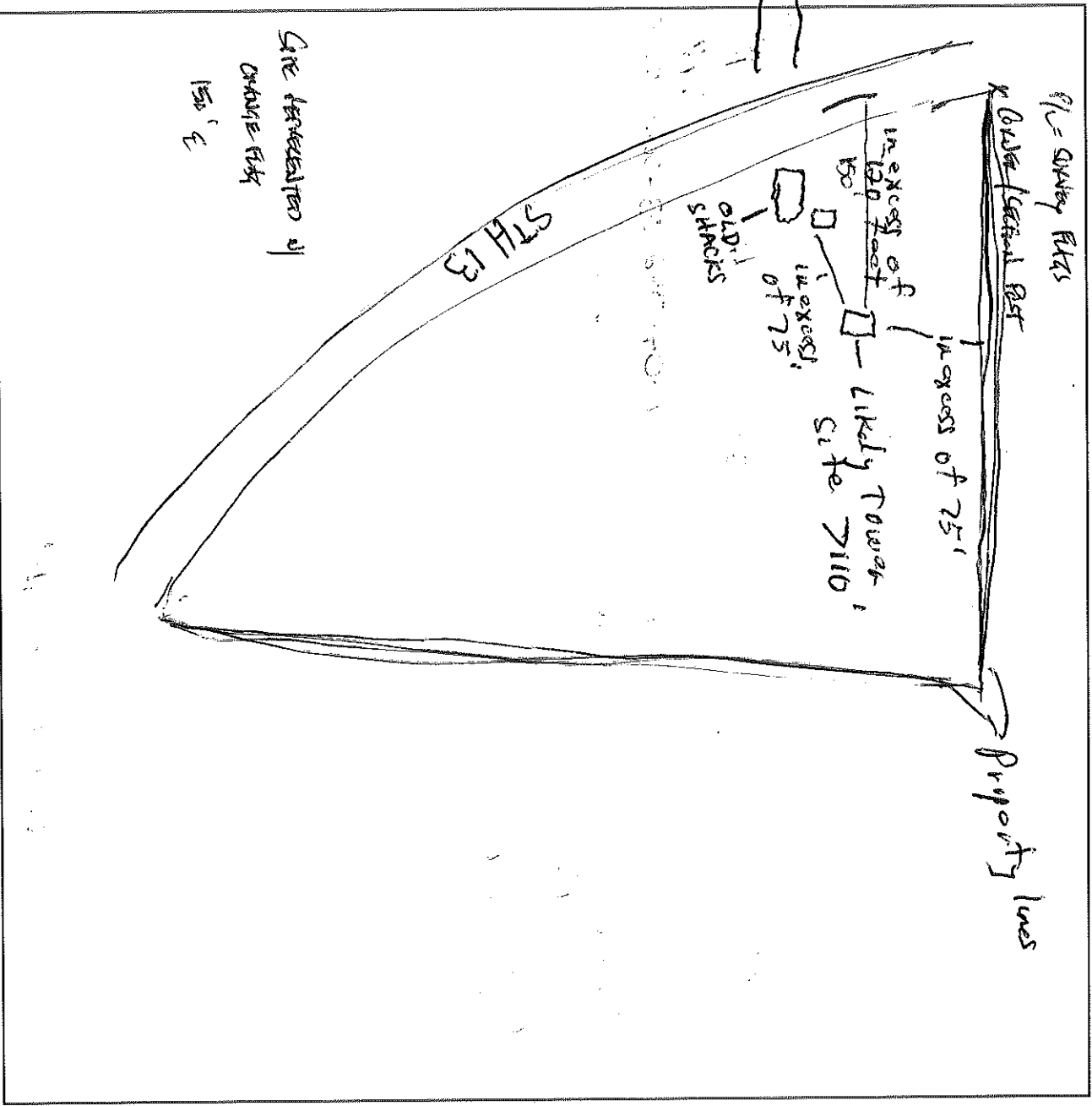

Name of Frontage Road ( 5714 13 )

1. Name the frontage road and use as a guideline, fill in the lot dimensions and indicate North (N).
2. Show the location, size and dimensions of the structure.
3. Show the location, size and dimensions of attached deck(s), porch(s) or garage.
4. Show the location of the well, holding tank, septic tank and drain field.
5. Show the location of any lake, river, stream or pond if applicable.
6. Show the location of other existing structures.
7. Show the location of any wetlands or slopes over 20 percent.
8. Show dimensions in feet on the following:
  - a. Building to all lot lines
  - b. Building to centerline of road
  - c. Building to lake, river, stream or pond
  - d. Holding tank to closest lot line
  - e. Holding tank to building
  - f. Holding tank to well
  - g. Holding tank to lake, river, stream or pond
  - h. Privy to closest lot line
  - i. Privy to building
  - j. Privy to lake, river, stream or pond
  - k. Septic Tank and Drain field to closest lot line
  - l. Septic Tank and Drain field to building
  - m. Septic Tank and Drain field to well
  - n. Septic Tank, and Drain field to lake, river, stream or pond.
  - o. Well to building

**IMPORTANT**  
DETAILED PLOT PLAN  
IS NECESSARY, FOLLOW  
STEPS 1-8 (a-o) COMPLETELY.

\*NOTICE: All Land Use Permits Expire One (1) Year From The Date Issued.

For The Construction Of New One & Two Family Dwellings: ALL Municipalities Are Required To Enforce The Uniform Dwelling Code.  
You Must Contact Your Town Chairman / Clerk For More Information.

The local town, village, city, state or federal agencies may also require permits.

Stake or mark proposed location(s) of new building, holding tank, septic, drain field, privy, and well. Inspector will not make an inspection until location(s) are staked or marked.

Revised June 2008

Site is ribboned but other ribbons are in area  
Please consult, Prospective  
TOWN CLERK 779-3254