

APPLICATION FOR RECREATIONAL VEHICLE

ENTERED

F 75

Bayfield County Planning and Zoning Department
P.O. Box 58
117 East Sixth Street
Washburn, WI 54891
Phone - (715) 373-6138

RECEIVED

AUG 07 2014

Bayfield Co. Zoning Dept.

Office Use:	
Zoning District/Lakes Class	<u>UB-C1</u>
Application No.	<u>14-0341</u>
Date	<u>9-17-14</u>
Fee Paid	<u>\$75 8-7-14</u> <u>\$75 8-7-14</u>

INSTRUCTIONS: No permits will be issued until all fees are paid.
Checks are made payable to: Bayfield County Zoning Department.
DO NOT START CONSTRUCTION UNTIL ALL PERMITS HAVE BEEN ISSUED TO APPLICANT.
Changes in plans must be approved by the Zoning Department

Property Owner Roger + Marianne Pikus

Mailing Address 15032 FAIRHAM AVE N
Hugo, MN 55038

Telephone 651-464-7008

Property Address of RV placement 89040 Brk Point Road

Agent: _____

Written Authorization Attached: Yes (X) No ()

Accurate Legal Description involved in this request:

1/4 of S 1/4 of Section 27 Township 51 N. Range 7 W. Town of Clover

Gov't Lot _____ Lot 2 Block _____ Subdivision _____ CSM # 1109

Volume _____ Page _____ of Deeds Parcel I.D. # 040142510727400 - Acreage 1.39
17714000

Additional Legal Description: _____

ATTACH
Copy of Tax Statement

Is your RV in a Shoreland Zone? Yes No If Yes, Distance from Shoreline: 75' or greater < 75' to 40' less than 40'

RV: New Replacement Year: 2000 Vin #: 4E ZTS 3229150 45188

Make of RV: Sportsmans (KSC) Model of RV: 31' Trailer

FAILURE TO OBTAIN A PERMIT or PLACING RV ON PROPERTY WITHOUT A PERMIT WILL RESULT IN PENALTIES

APPLICANT - PLEASE COMPLETE REVERSE SIDE

For Office Use Only		Zoning District/Lakes Class <u>R/RB/1-Superior</u>
Permit Issued:	Sanitary Number <u>10-755</u>	Date <u>7/21/2010</u>
Issuance Date <u>9-17-14</u>	Permit Number <u>14-0341</u>	Permit Denied (Date) _____
Reason for Denial: _____		
Inspection Record: <u>RV PRESENT (RENEWAL REQUEST)</u>		
By <u>J. Cronin</u> <u>Murphy</u>		Date of Inspection <u>8-15-14</u>
Variance (B.O.A.) # <u>X</u>		
Condition: <u>RV may be placed up to 4 months from issuance date.</u>		Must be removed by: <u>2 years from date of permit issuance</u>
Signed _____ Inspector		Date of Approval <u>9-17-14</u>

NO. 1109, LOCATED IN GOVERNMENT LOT 1 OF SECTION 27, T. 51 N.,
R. 7 W., IN THE TOWN OF CLOVER, BAYFIELD COUNTY, WISCONSIN

SURVEYOR'S CERTIFICATE

I, TIMOTHY E. OKSIUTA, REGISTERED LAND SURVEYOR IN THE STATE OF WISCONSIN, HEREBY CERTIFY:

THAT ON THE ORDER OF ROGER PIKUS, I HAVE MADE A RESURVEY OF LOT 2 OF BAYFIELD COUNTY CERTIFIED SURVEY MAP NO. 1109, LOCATED IN GOVERNMENT LOT 1 OF SECTION 27, T. 51 N., R. 7 W., IN THE TOWN OF CLOVER, BAYFIELD COUNTY, WISCONSIN;

THAT THIS MAP IS A TRUE REPRESENTATION OF SAID SURVEY; AND

THAT SAID SURVEY AND MAP ARE CORRECT TO THE BEST OF MY KNOWLEDGE AND BELIEF.

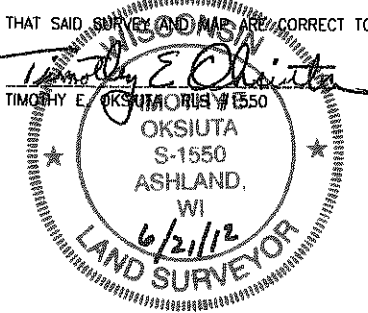

BEARINGS ARE BASED ON THE EASTERLY PART OF THE NORTH LINE OF LOT 2 ASSUMED AS N 73°42'11" E

