

SUBMIT: COMPLETED APPLICATION, TAX STATEMENT AND FEE TO:

Bayfield County
 Planning and Zoning Dept.
 PO Box 58
 Washburn, WI 54891
 (715) 373-6138

APPLICATION FOR PERMIT
 BAYFIELD COUNTY, WISCONSIN

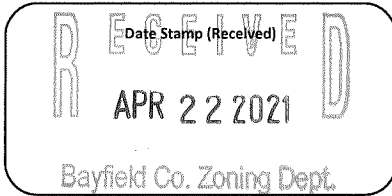

Permit #:	21-0082
Date:	4-29-21
Amount Paid:	\$75 4-26-21
Refund:	

INSTRUCTIONS: No permits will be issued until all fees are paid. Checks are made payable to: Bayfield County Zoning Department.

DO NOT START CONSTRUCTION UNTIL ALL PERMITS HAVE BEEN ISSUED TO APPLICANT. Original Application MUST be submitted FILL OUT IN INK (NO PENCIL)

TYPE OF PERMIT REQUESTED →		<input checked="" type="checkbox"/> LAND USE	<input type="checkbox"/> SANITARY	<input type="checkbox"/> PRIVY	<input type="checkbox"/> CONDITIONAL USE	<input type="checkbox"/> SPECIAL USE	<input type="checkbox"/> B.O.A.	<input type="checkbox"/> OTHER
Owner's Name: Todd M. Goetsch		Mailing Address:			City/State/Zip:		Telephone:	
Address of Property: 17040 Cty Hwy M		City/State/Zip: Cable WI 54821			Cell Phone: 608 219-7978			
Contractor: Creative Concepts		Contractor Phone: 715-558-4442		Plumber:		Plumber Phone:		
Authorized Agent: (Person Signing Application on behalf of Owner(s))		Agent Phone:		Agent Mailing Address (include City/State/Zip):			Written Authorization Attached <input type="checkbox"/> Yes <input type="checkbox"/> No	
PROJECT LOCATION	Legal Description: (Use Tax Statement)			Tax ID# 8656	Recorded Document: (Showing Ownership) 2019R 575939			
NW 1/4, SW 1/4 9 of old grade	Gov't Lot	Lot(s)	CSM 550	Vol & Page 4/101	CSM Dcg # 2019R 575939	Lot(s) #	Block #	Subdivision:
Section 14, Township Cable N, Range 7 W		Town of: Cable		Lot Size		Acreage 26		

<input type="checkbox"/> Shoreland	<input type="checkbox"/> Is Property/Land within 300 feet of River, Stream (incl. Intermittent) Creek or Landward side of Floodplain? If yes---continue →	Distance Structure is from Shoreline: _____ feet	Is your Property in Floodplain Zone? <input type="checkbox"/> Yes <input type="checkbox"/> No	Are Wetlands Present? <input type="checkbox"/> Yes <input type="checkbox"/> No
	<input type="checkbox"/> Is Property/Land within 1000 feet of Lake, Pond or Flowage If yes---continue →	Distance Structure is from Shoreline: _____ feet		
<input type="checkbox"/> Non-Shoreland				

Value at Time of Completion * include donated time & material	Project	Project # of Stories	Project Foundation	Total # of bedrooms on property	What Type of Sewer/Sanitary System(s) Is on the property or Will be on the property?	Type of Water on property
\$ 20,000.00	<input checked="" type="checkbox"/> New Construction	<input type="checkbox"/> 1-Story	<input checked="" type="checkbox"/> Basement	<input type="checkbox"/> 1	<input type="checkbox"/> Municipal/City	<input type="checkbox"/> City
	<input type="checkbox"/> Addition/Alteration	<input type="checkbox"/> 1-Story + Loft	<input type="checkbox"/> Foundation	<input checked="" type="checkbox"/> 2	<input type="checkbox"/> (New) Sanitary Specify Type: _____	<input checked="" type="checkbox"/> Well
	<input type="checkbox"/> Conversion	<input type="checkbox"/> 2-Story	<input type="checkbox"/> Slab	<input type="checkbox"/> 3	<input checked="" type="checkbox"/> Sanitary (Exists) Specify Type: _____	<input type="checkbox"/>
	<input type="checkbox"/> Relocate (existing bldg)	<input checked="" type="checkbox"/> OPEN w/ Basement	<input type="checkbox"/>	<input type="checkbox"/>	<input type="checkbox"/> Privy (Pit) or <input type="checkbox"/> Vaulted (min 200 gallon)	
	<input type="checkbox"/> Run a Business on Property		<input type="checkbox"/> Use	<input type="checkbox"/> None	<input type="checkbox"/> Portable (w/service contract)	
			<input type="checkbox"/> Year Round	<input type="checkbox"/> Compost Toilet		
			<input type="checkbox"/>	<input type="checkbox"/> None		

Existing Structure: (if addition, alteration or business is being applied for)	Length:	Width:	Height:
Proposed Construction: (overall dimensions)	Length: 20	Width: 20	Height: 14

Proposed Use	Proposed Structure	Dimensions	Square Footage
<input checked="" type="checkbox"/> Residential Use	<input type="checkbox"/> Principal Structure (first structure on property)	(X)	
	<input type="checkbox"/> Residence (i.e. cabin, hunting shack, etc.)	(X)	
	<input type="checkbox"/> with Loft	(X)	
	<input type="checkbox"/> with a Porch	(X)	
	<input type="checkbox"/> with (2nd) Porch	(X)	
	<input type="checkbox"/> with a Deck	(X)	
	<input type="checkbox"/> with (2nd) Deck	(X)	
<input type="checkbox"/> Commercial Use	<input type="checkbox"/> with Attached Garage	(X)	
	<input type="checkbox"/> Bunkhouse w/ (<input type="checkbox"/> sanitary, or <input type="checkbox"/> sleeping quarters, or <input type="checkbox"/> cooking & food prep facilities)	(X)	
<input type="checkbox"/> Municipal Use	<input type="checkbox"/> Mobile Home (manufactured date) _____	(X)	
	<input type="checkbox"/> Addition/Alteration (explain) _____	(X)	
	<input checked="" type="checkbox"/> Accessory Building (explain) Covered Shelter /w basement	(20 X 20)	400
	<input type="checkbox"/> Accessory Building Addition/Alteration (explain) _____	(X)	
	<input type="checkbox"/> Special Use: (explain) _____	(X)	
	<input type="checkbox"/> Conditional Use: (explain) _____	(X)	
	<input type="checkbox"/> Other: (explain) _____	(X)	

FAILURE TO OBTAIN A PERMIT OR STARTING CONSTRUCTION WITHOUT A PERMIT WILL RESULT IN PENALTIES
 I (we) declare that this application (including any accompanying information) has been examined by me (us) and to the best of my (our) knowledge and belief it is true, correct and complete. I (we) acknowledge that I (we) am (are) responsible for the detail and accuracy of all information I (we) am (are) providing and that it will be relied upon by Bayfield County in determining whether to issue a permit. I (we) further accept liability which may be a result of Bayfield County relying on this information I (we) am (are) providing in or with this application. I (we) consent to county officials charged with administering county ordinances to have access to the above described property at any reasonable time for the purpose of inspection.

Owner(s): Todd M. Goetsch Date 4/23/21
 (If there are Multiple Owners listed on the Deed All Owners must sign or letter(s) of authorization must accompany this application)

Authorized Agent: _____ Date _____
 (If you are signing on behalf of the owner(s) a letter of authorization must accompany this application)

Address to send permit _____ Attach Copy of Tax Statement
 If you recently purchased the property send your Recorded Deed

Original Application MUST be submitted

Below: Draw or Sketch your Property (regardless of what you are applying for)

Fill Out in Ink - NO PENCIL

- (1) Show Location of: **Proposed Construction**
- (2) Show / Indicate: **North (N) on Plot Plan**
- (3) Show Location of (*): **(* Driveway and (* Frontage Road (Name Frontage Road)**
- (4) Show: **All Existing Structures on your Property**
- (5) Show: **(* Well (W); (* Septic Tank (ST); (* Drain Field (DF); (* Holding Tank (HT) and/or (* Privy (P)**
- (6) Show any (*): **(* Lake; (* River; (* Stream/Creek; or (* Pond**
- (7) Show any (*): **(* Wetlands; or (* Slopes over 20%**

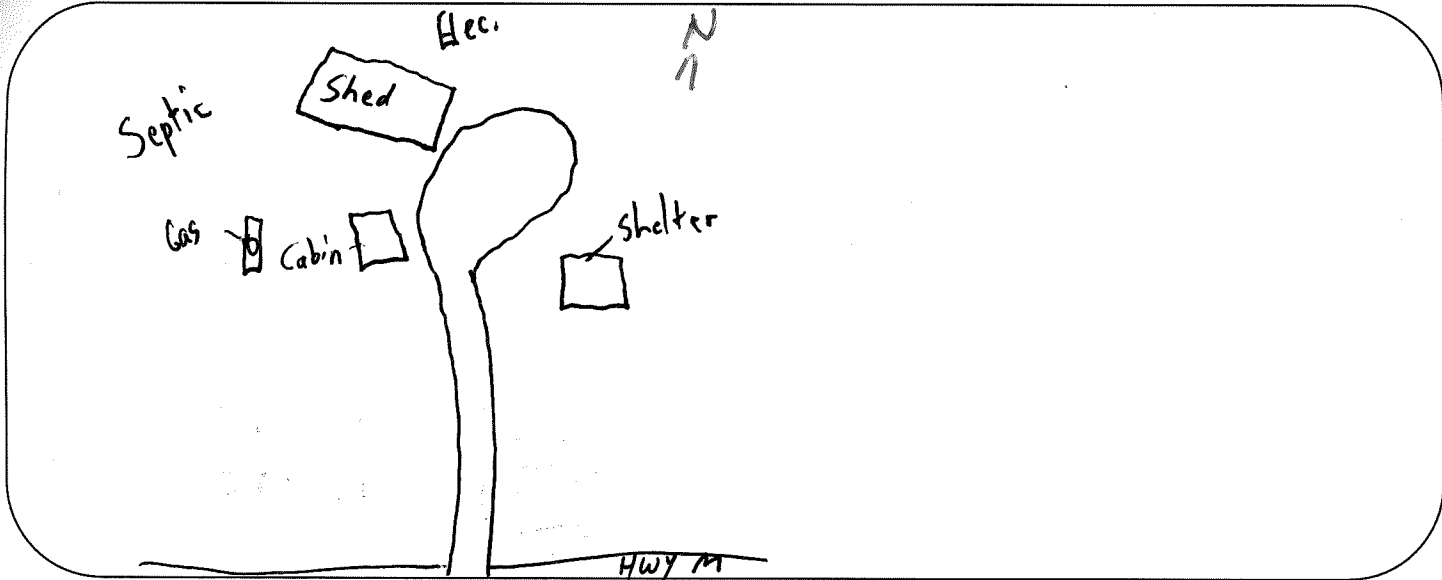

Please complete (1) - (7) above (prior to continuing)

Changes in plans must be approved by the Planning & Zoning Dept.

(8) Setbacks: (measured to the closest point)

Description	Setback Measurements	Description	Setback Measurements
Setback from the Centerline of Platted Road	100 Feet	Setback from the Lake (ordinary high-water mark)	Feet
Setback from the Established Right-of-Way	Feet	Setback from the River, Stream, Creek	Feet
		Setback from the Bank or Bluff	Feet
Setback from the North Lot Line	100 Feet		
Setback from the South Lot Line	90 Feet	Setback from Wetland	Feet
Setback from the West Lot Line	250 Feet	20% Slope Area on the property	<input type="checkbox"/> Yes <input type="checkbox"/> No
Setback from the East Lot Line	800 Feet	Elevation of Floodplain	Feet
Setback to Septic Tank or Holding Tank	200 Feet	Setback to Well	Feet
Setback to Drain Field	250 Feet		
Setback to Privy (Portable, Composting)	Feet		

Prior to the placement or construction of a structure within ten (10) feet of the minimum required setback, the boundary line from which the setback must be measured must be visible from one previously surveyed corner to the other previously surveyed corner or marked by a licensed surveyor at the owner's expense.

Prior to the placement or construction of a structure more than ten (10) feet but less than thirty (30) feet from the minimum required setback, the boundary line from which the setback must be measured must be visible from one previously surveyed corner to the other previously surveyed corner, or verifiable by the Department by use of a corrected compass from a known corner within 500 feet of the proposed site of the structure, or must be marked by a licensed surveyor at the owner's expense.

(9) Stake or Mark Proposed Location(s) of New Construction, Septic Tank (ST), Drain field (DF), Holding Tank (HT), Privy (P), and Well (W).

NOTICE: All Land Use Permits Expire One (1) Year from the Date of Issuance if Construction or Use has not begun.

For the Construction Of New One & Two Family Dwelling: ALL Municipalities Are Required To Enforce The Uniform Dwelling Code.

The local Town, Village, City, State or Federal agencies may also require permits.

You are responsible for complying with state and federal laws concerning construction near or on wetlands, lakes, and streams. Wetlands that are not associated with open water can be difficult to identify. Failure to comply may result in removal or modification of construction that violates the law or other penalties or costs. For more information, visit the department of natural resources wetlands identification web page or contact a department of natural resources service center (715) 685-2900.

Issuance Information (County Use Only)		Sanitary Number:	# of bedrooms:	Sanitary Date:
Permit Denied (Date):		Reason for Denial:		
Permit #: 21-0082		Permit Date: 4-29-21		
Is Parcel a Sub-Standard Lot	<input type="checkbox"/> Yes (Deed of Record) <input checked="" type="checkbox"/> No	Mitigation Required	<input type="checkbox"/> Yes <input checked="" type="checkbox"/> No	Affidavit Required
Is Parcel in Common Ownership	<input type="checkbox"/> Yes (Fused/Contiguous Lot(s)) <input checked="" type="checkbox"/> No	Mitigation Attached	<input type="checkbox"/> Yes <input checked="" type="checkbox"/> No	Affidavit Attached
Is Structure Non-Ownership	<input type="checkbox"/> Yes <input checked="" type="checkbox"/> No			<input type="checkbox"/> Yes <input checked="" type="checkbox"/> No
Granted by Variance (B.O.A.)		Previously Granted by Variance (B.O.A.)		
<input type="checkbox"/> Yes <input checked="" type="checkbox"/> No Case #:		<input type="checkbox"/> Yes <input checked="" type="checkbox"/> No Case #:		
Was Parcel Legally Created	<input checked="" type="checkbox"/> Yes <input type="checkbox"/> No	Were Property Lines Represented by Owner	<input type="checkbox"/> Yes <input type="checkbox"/> No	
Was Proposed Building Site Delineated	<input checked="" type="checkbox"/> Yes <input type="checkbox"/> No	Was Property Surveyed	<input type="checkbox"/> Yes <input type="checkbox"/> No	
Inspection Record:				Zoning District (F-1)
Date of Inspection: 4/28/21				Lakes Classification (N/A)
Inspected by: [Signature]				Date of Re-Inspection:
Condition(s): Town, Committee or Board Conditions Attached? <input type="checkbox"/> Yes <input type="checkbox"/> No - (If No they need to be attached.)				
Temporary shelter only Not for Human Habitation or sleeping Get UDC Inspections if required				
Signature of Inspector: [Signature]				Date of Approval: 4/28/21
Hold For Sanitary: <input type="checkbox"/>	Hold For TBA: <input type="checkbox"/>	Hold For Affidavit: <input type="checkbox"/>	Hold For Fees: <input type="checkbox"/>	<input type="checkbox"/>

City, Village, State or Federal
Permits May Also Be Required

LAND USE - X
SANITARY -
SIGN -
SPECIAL -
CONDITIONAL -
BOA -

BAYFIELD COUNTY PERMIT

WEATHERIZE AND POST THIS PERMIT
ON THE PREMISES DURING CONSTRUCTION

No. **21-0082** Issued To: **Todd Goetsch**

Location: **NW ¼ of SW ¼ Section 14 Township 43 N. Range 7 W. Town of Cable
S of Old Co Hwy D & N of Co Hwy M & W of CSM #550**

Gov't Lot	Lot	Block	Subdivision	CSM#

For: **Residential Accessory Structure: [1- Story; Covered Shelter (20' x 20') = 400 sq. ft.]**
(Disclaimer): Any future expansions or development would require additional permitting.

Condition(s): Temporary shelter only. Not for human habitation or sleeping. Get UDC inspections if required.

You are responsible for complying with state and federal laws concerning construction near or on wetlands, lakes, and streams. Wetlands that are not associated with open water can be difficult to identify. Failure to comply may result in removal or modification of construction that violates the law or other penalties or costs. For more information, visit the department of natural resources wetlands identification web page or contact a department of natural resources service center (715) 685-2900.

NOTE: This permit expires one year from date of issuance if the authorized construction work or work or land use has not begun.

Changes in plans or specifications shall not be made without obtaining approval. This permit may be void or revoked if any of the application information is found to have been misrepresented, erroneous, or incomplete.
This permit may be void or revoked if any performance conditions are not completed

or if any prohibitory conditions are violated.

Tracy Pooler

Authorized Issuing Official

April 29, 2021

Date