

# Bayfield County Forestry and Parks Department

Forester: Sirrine			Compartment: 55	Stand: 6, 7, 19, &27	Tract Number: 27-20
Twp: 50N	Range: 7W	Sec: 36	Township: Clover	Contract Number:	
Topography: Rolling			Reforestation Code: Natural regen	Soil: Sand, silt loam/clay	Acres 74

Estimated Volumes				*Red pine contains 11% white pine, including approximately 91MBF of red pine and white pine. ^Red maple contains 78% red maple and 22% white birch.
Species	Whole Tree (Tons)	4" Roundwood (Cords)	Sawlogs (MBF)	
Red pine*	X	473		No seasonal restrictions Utilization specification (see Supplemental Requirements.)
Red oak	X	245	63	
Aspen	X	31		
Red maple^	X	33		

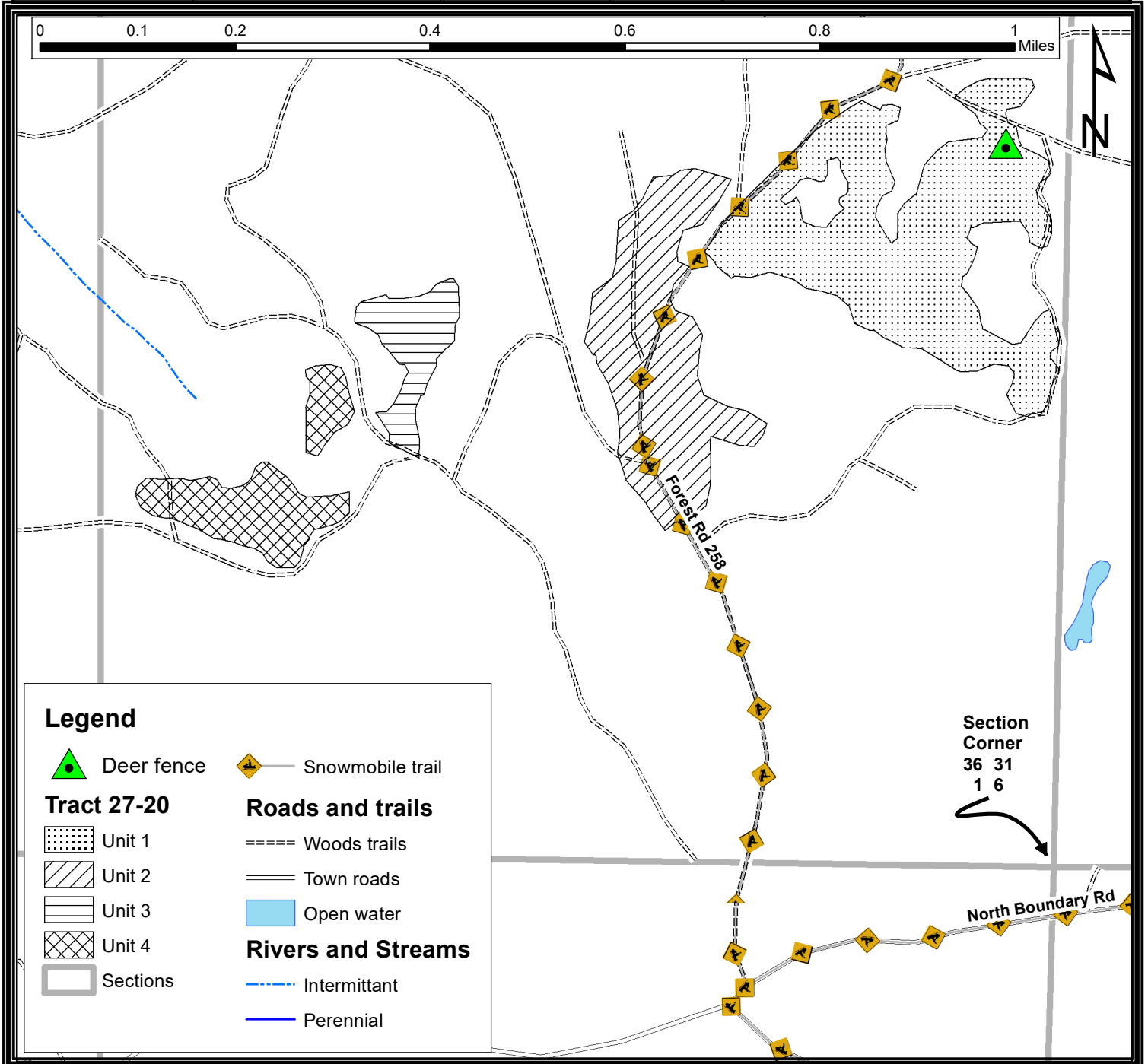

# TRACT 27-20 – HARVEST REQUIREMENTS

The following terms and conditions supplement those provided in the Bayfield County Timber Sale Contract.

## A. PRESCRIPTION:

1. Unit 1: Red oak overstory removal. Average Diameter 12 inches. Residual 3 sq.ft./acre of red oak and red pine.
2. Unit 2: Natural red pine stand thinning. Average Diameter 10 inches. Residual 103 s.ft./acre of red and white pine.
3. Unit 3: Mixed hardwood and mixed pine shelterwood. Residual 17 sq.ft./acre of oak and red and white pine.
4. Unit 4: Second thin of red pine. Average Diameter 8 inches. Residual 117 sq.ft./acre of red pine.

## B. HARVEST REQUIREMENTS

1. Unit 1: LEAVE all trees marked with 2 purple slashes and LEAVE all red and white pine. CUT all red oak and red maple 2" diameter and greater. LEAVE all trees supporting and within deer enclosure fencing.
2. Unit 2: CUT all red and white pine marked in orange paint. CUT all red maple, red oak and aspen 2" diameter or greater.
3. Unit 3: LEAVE all trees that are marked in Purple Paint and LEAVE all white pine under 2" in diameter. CUT all other trees not marked in Purple Paint 2" diameter or greater.
4. Unit 4: CUT all red pine marked in orange paint and CUT all aspen and red maple 2" diameter or greater. LEAVE all red oak.

## C. OPERATIONAL REQUIREMENTS and SEASONAL RESTRICTIONS:

1. No seasonal restrictions on this sale.
2. Harvested pine cannot be kept on the Bayfield County Forest for more than three weeks from May 1st to August 31st.
3. For Unit 1: This sale is an overstory removal. Minimize damage to advance regeneration. Harvest activities will be temporarily stopped if damage to regeneration is deemed to be excessive, as determined by the county.
4. In 2018, oak wilt was officially confirmed in Bayfield County. Currently, this timber sale is located more than six miles away from the closest known infected tree. However, over the duration of this contract, additional infections could be discovered. If, over the duration of this contract, including extensions, oak wilt is officially confirmed within a six mile radius of this timber sale, as determined by the county, the following seasonal restriction will be applied: no harvesting operations will be allowed between April 15 (or as otherwise determined by the county) and July 15
5. Sale boundaries are red paint lines as indicated on map.
6. Whole tree harvesting will NOT be allowed on this site.

## D. ACCESS AND ROADS:

1. This contract requires County authorization for all road/landing construction and places a number of other requirements on road construction and closure.
2. Decking of wood along town roads will not be allowed without permission from Bayfield County.
3. During winter harvesting the snowmobile trail must be kept unobstructed and in a packed snow condition. The purchaser must ensure that harvesting and hauling operations will not create a safety hazard to snowmobiles.
4. The primary haul route utilizes a portion of the snowmobile trail. Excessive damage (beyond normal wear and tear) to the trail, as determined by the county, will not be tolerated. If Bayfield County determines excessive damage has occurred, the Contractor may be held responsible for a portion or all of the repair. The County and Contractor must communicate on a regular basis to ensure issues are addressed in a timely manner and the snowmobile trail remains in a safe and acceptable condition.

## E. OTHER:

1. Utilization specification is to a 4" top. However, if the County determines that pulpwood markets continue to be very poor at the time of harvest the County will sign a contract amendment with the purchaser changing the utilization specification to a 5" top for selected species. When determining condition of the market, the County will pay particular attention to the amount of wood being purchased by the mills in Wisconsin Rapids and any other significant shifts in wood demand.
2. To comply with Best Management Practices for Invasive Species: Prior to moving equipment onto or off the sale area, scrape or brush soil and debris from exterior surfaces to the extent practical.
3. Do not damage survey monumentation.
4. Leave all trees supporting and within deer enclosure fencing.

