

# Bayfield County Forestry & Parks Department

Forester: Caleb E. Brown			Compartment: 109	Stand: 17	Tract Number: <b>29-18</b>
Twp: 47N	Range: 9W	Sec: 12	Township: Hughes	Contract Number:	
Topography: Flat & Gently Rolling			Reforestation Code: NA	Soil: Loamy Sand & Sand	Acres: <b>86</b>

Estimated Volumes				*Approximately 99% Red Pine and 1% Other Conifer.
Species	4" Roundwood (Cords)	Whole Tree (Tons)	Sawlogs (MBF)	
Red Pine*	3233	1138		<b>Notes</b> Harvested pine cannot be kept on the Bayfield County Forest for more than three weeks from May 1st to August 31st.

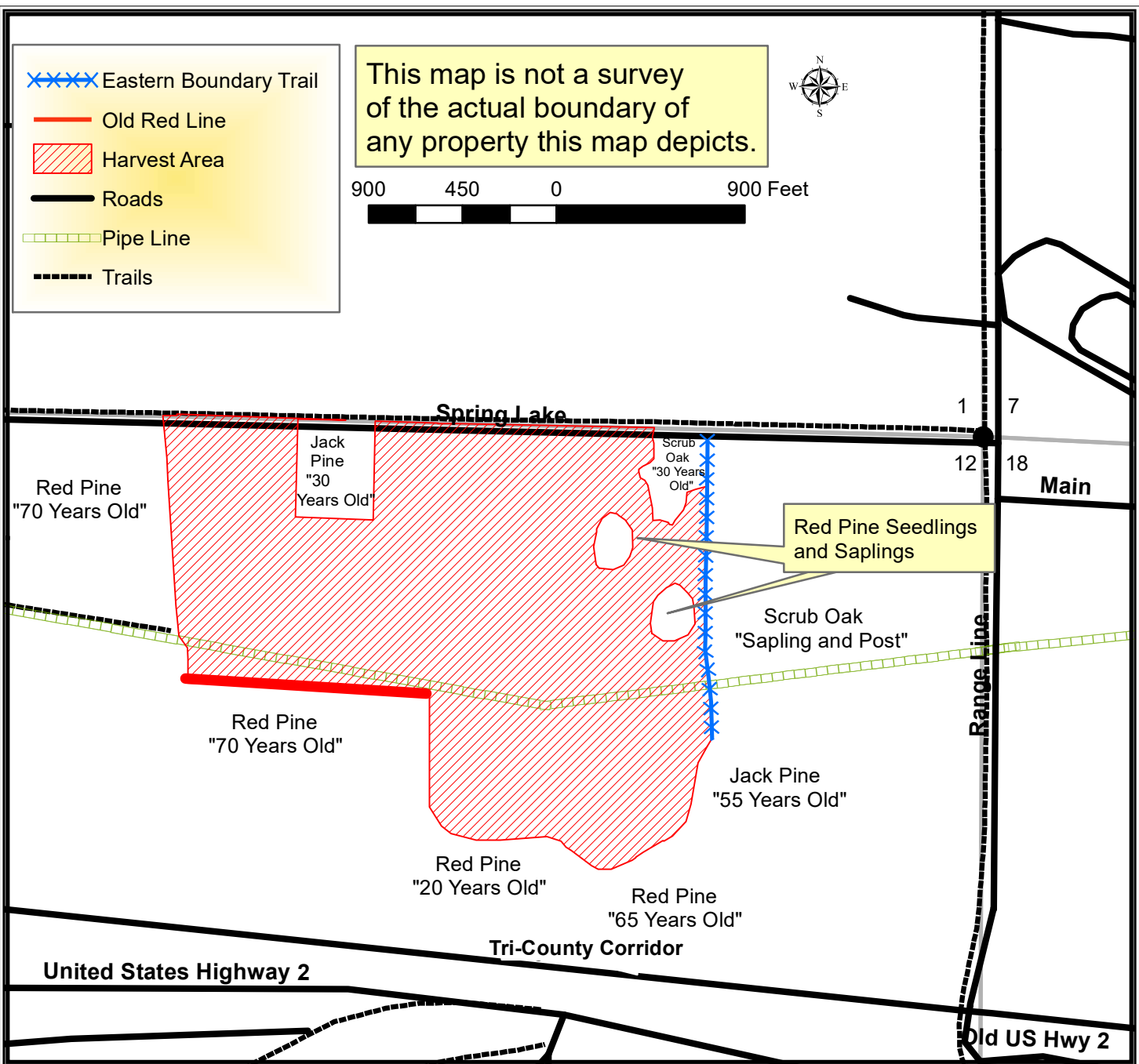

# TRACT 29-18 – SUPPLEMENTAL REQUIREMENTS

The following terms and conditions supplement those provided in the Bayfield County Timber Sale Contract.

## A. PRESCRIPTION:

1. Harvest is a red pine thinning with an estimated average residual basal area of 99 ft<sup>2</sup>.

## B. HARVESTING REQUIREMENTS:

1. Harvest all orange marked trees.

## C. OPERATIONAL REQUIREMENTS AND SEASONAL RESTRICTIONS:

1. Sale boundaries consist of old red paint line, eastern boundary trail, Spring Lake Road, and abrupt timber type changes to jack pine planation, young scrub oak and the western old forest road.
2. Harvested pine cannot be kept on the Bayfield County Forest for more than three weeks from May 1<sup>st</sup> to August 31<sup>st</sup>.
3. If harvest will utilize the whole tree, 1 in 10 tops must be left scattered throughout the sale.
4. The eastern boundary trail indicates private property. No equipment or felled trees may cross the line.
5. Do not cut snags except for individuals that pose a safety hazard.
6. Do not damage any survey monumentation.

## D. ACCESS AND ROADS:

1. This contract requires County authorization for all road/landing construction and places a number of other requirements on road construction and closure.
2. Decking of wood along town roads will not be allowed without permission from Bayfield County.

## E. OTHER:

1. To comply with Best Management Practices for Invasive Species: Prior to moving equipment onto or off the sale area, scrape or brush soil and debris from exterior surfaces to the extent practical.

