

Bayfield County Forestry and Parks

Forester: LeBouton			Acres: 37	Estimated Volumes:									
Twp: 45N	Range: 9W	Section: 8	Compartment: 157	<table border="1"> <thead> <tr> <th rowspan="2">Species</th> <th>Round Wood</th> <th>Whole Tree</th> </tr> <tr> <th>Cords</th> <th>Tons</th> </tr> </thead> <tbody> <tr> <td>*Red Pine</td> <td>360</td> <td>750</td> </tr> </tbody> </table> <p>*Volume includes 12% jack pine and 5% aspen.</p>		Species	Round Wood	Whole Tree	Cords	Tons	*Red Pine	360	750
Species	Round Wood	Whole Tree											
	Cords	Tons											
*Red Pine	360	750											
Township: Barnes			Stand: 22										
Soil: Sand	Reforestation Code: Thinning		Tract Number: 42-17										
Topography: Gently Rolling			Contract Number:										

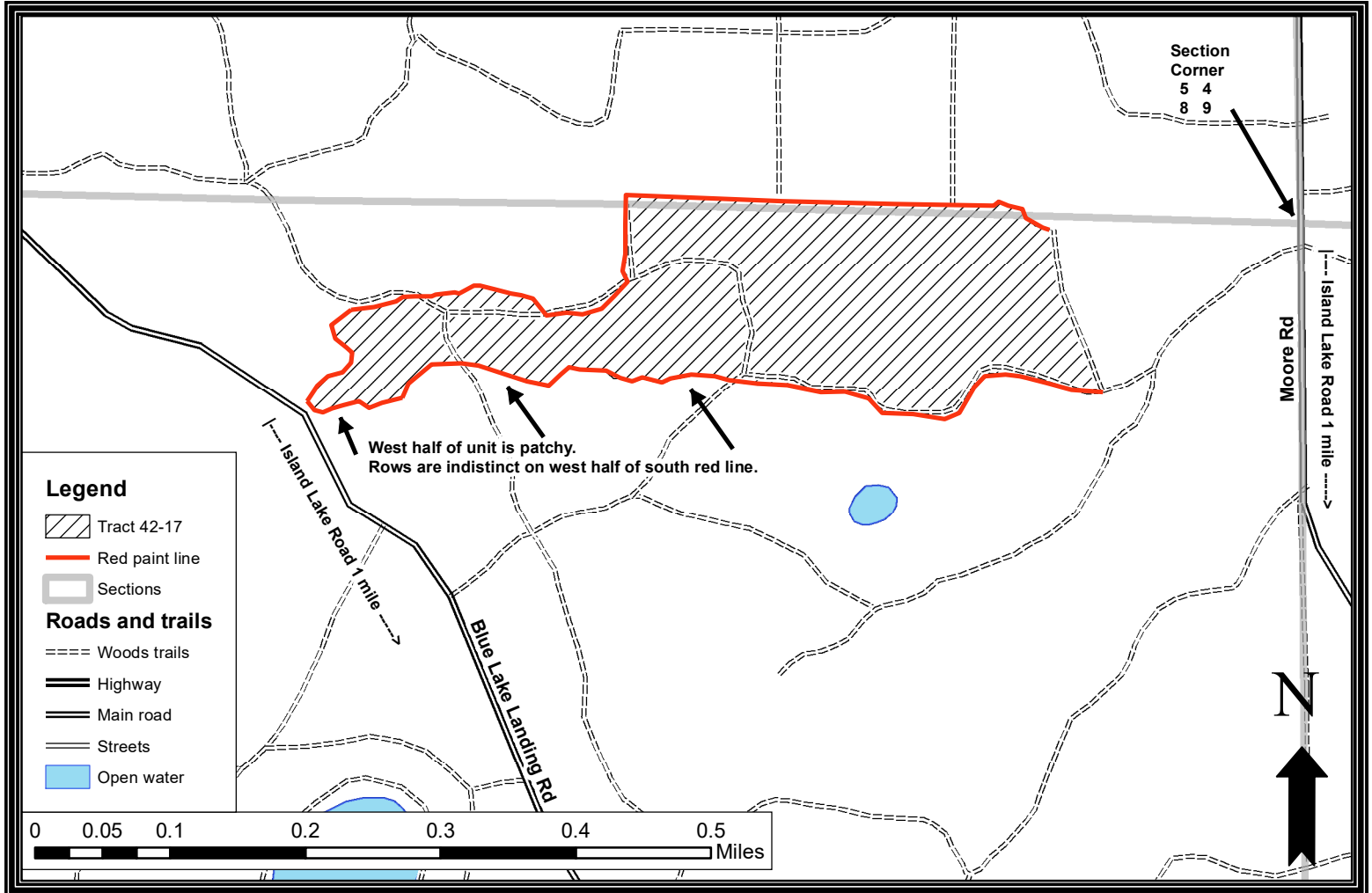

Harvest requirements:

- This timber sale is being sold on a ticket scale basis.
- This is a first thin red pine plantation with an average diameter of 8 inches.
- Harvested pine cannot be kept on the Bayfield County Forest for more than three weeks from May 1st to August 31st.
- Logger select, cut all trees in every third row utilizing to a 4-inch top diameter. The harvest pattern should leave two rows and take one row.
- Harvest all merchantable aspen in the timber sale area.
- No damage to residual rows will be allowed.
- To comply with the Best Management Practices for Invasive Species, prior to moving equipment on to or off the sale area, scrape or brush debris and soil from exterior surfaces to the greatest extent possible.
- The existing access roads within this timber sale are open to highway vehicle use. Upon completion of the timber sale these roads will be left open and in good condition, unless otherwise directed by the sale administrator.
- Decking of wood along town roads will not be allowed without the permission of Bayfield County.
- Sale boundaries are designated with red paint where indicated. The eastern boundary is a 5yr old pine plantation.