

Bayfield County Forestry & Parks Department

Forester: Neitzel			Acres: 25	Estimated Volumes																						
Twp: 50N	Range: 6W	Sec: 8	Compartment: 25																							
Township: Bell			Stand: 8,12,19	<table border="1"> <thead> <tr> <th rowspan="2">Species</th> <th>Whole Tree</th> <th>Round Wood</th> <th>Logs</th> </tr> <tr> <th>Tons</th> <th>Cords</th> <th>MBF</th> </tr> </thead> <tbody> <tr> <td>Red Oak</td> <td>1015</td> <td>306*</td> <td>36**</td> </tr> <tr> <td>Aspen</td> <td>63</td> <td>22</td> <td></td> </tr> <tr> <td>Red Pine***</td> <td>116</td> <td>42</td> <td></td> </tr> </tbody> </table>				Species	Whole Tree	Round Wood	Logs	Tons	Cords	MBF	Red Oak	1015	306*	36**	Aspen	63	22		Red Pine***	116	42	
Species	Whole Tree	Round Wood	Logs																							
	Tons	Cords	MBF																							
Red Oak	1015	306*	36**																							
Aspen	63	22																								
Red Pine***	116	42																								
Soil: Sand, Silty Clay, Clay		Reforestation Code: Nat.	Tract Number: 47-17																							
Topography: Moderate Slopes			Contract Number:																							

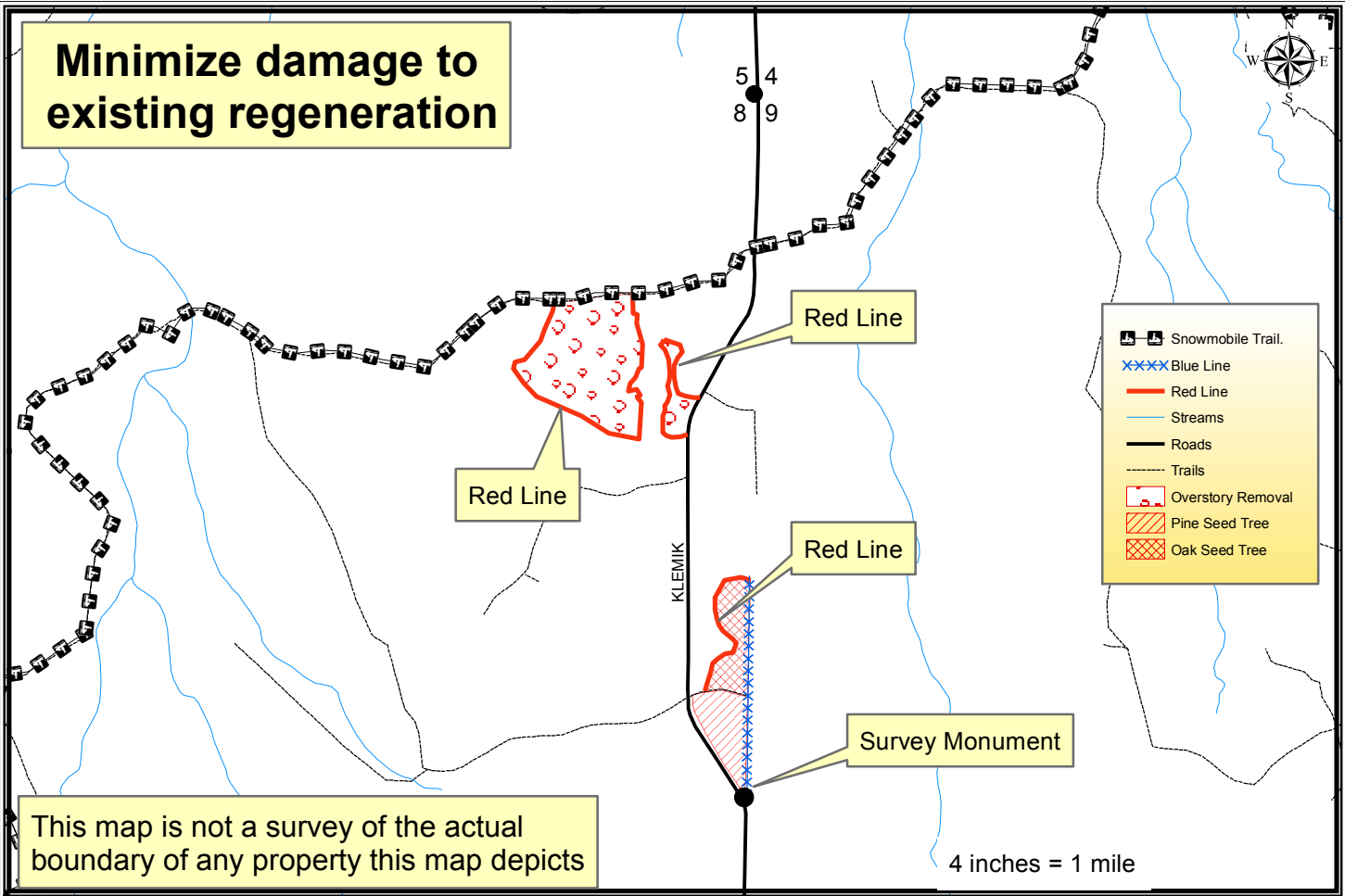

Harvest Requirements:

- Sale is a seed tree and an overstory removal being sold on a Ticket Scale Basis
- Sale boundaries consist of red paint line, blue paint line, roads or trails.
- The blue line indicates private property. No equipment or felled trees may cross the line.
- **Overstory Removal Unit:** Harvest all hardwood stems 4 inches in diameter and greater not marked with purple paint. Leave all hardwood marked with purple paint and all conifer. **Minimize damage to existing regeneration, except ironwood in this unit. In this unit only, sale operations may only occur when the ground is frozen.**
- **Oak Seedtree Unit:** Harvest all unmarked hardwood stems 2 inches in diameter and greater. Leave all hardwood stems marked with purple paint and all conifer.
- **Pine Seedtree Unit:** Harvest all hardwood stems greater than 2 inches in diameter and red pine. Leave all white pine, balsam fir, and spruce.
- Harvested pine cannot be kept on the Bayfield County Forest for more than three weeks from May 1st to August 31st.
- During winter harvesting the snowmobile trail must be kept unobstructed and in a packed snow condition. The purchaser must ensure that harvesting and hauling operations will not create a safety hazard to snowmobiles. Avoid damage to signs and trail markers.
- Do not damage any survey monumentation.
- Do not cut snags except for those that pose a safety hazard.
- To comply with the Best Management Practices for Invasive Species: Prior to moving equipment onto or off of the sale area, scrape or brush soil and debris from exterior surfaces to the extent practical.
- Decking of wood along town roads will not be allowed without permission from Bayfield County.
- If harvest will utilize the whole tree, 1 in 10 tops must be left scattered throughout the sale.
- This contract requires County authorization for all road/landing construction and places a number of other requirements on road construction and closure.