

Bayfield County Forestry and Parks

Forester: LeBouton	Twp: 48N	Range: 08W	Sec: 22	Estimated Volumes:		
Acres: 120	Township: Tripp		Species	4" cords	MBF	
Soil: Sand	Compartment: 96,98	6,15 and 16,29	Aspen	1230		
Topography: Rolling	Tract Number: 13-16	Reforestation Code: Natural	Mixed hardwood*	670		
Scale: 4" = 1 mile	Contract Number:		Red pine **	140		
			Jack pine	130		
			Balsam fir	15		
			Oak			28
			*Includes 70% oak, and 30% red maple			
			**Average red pine diameter = 12" dbh			

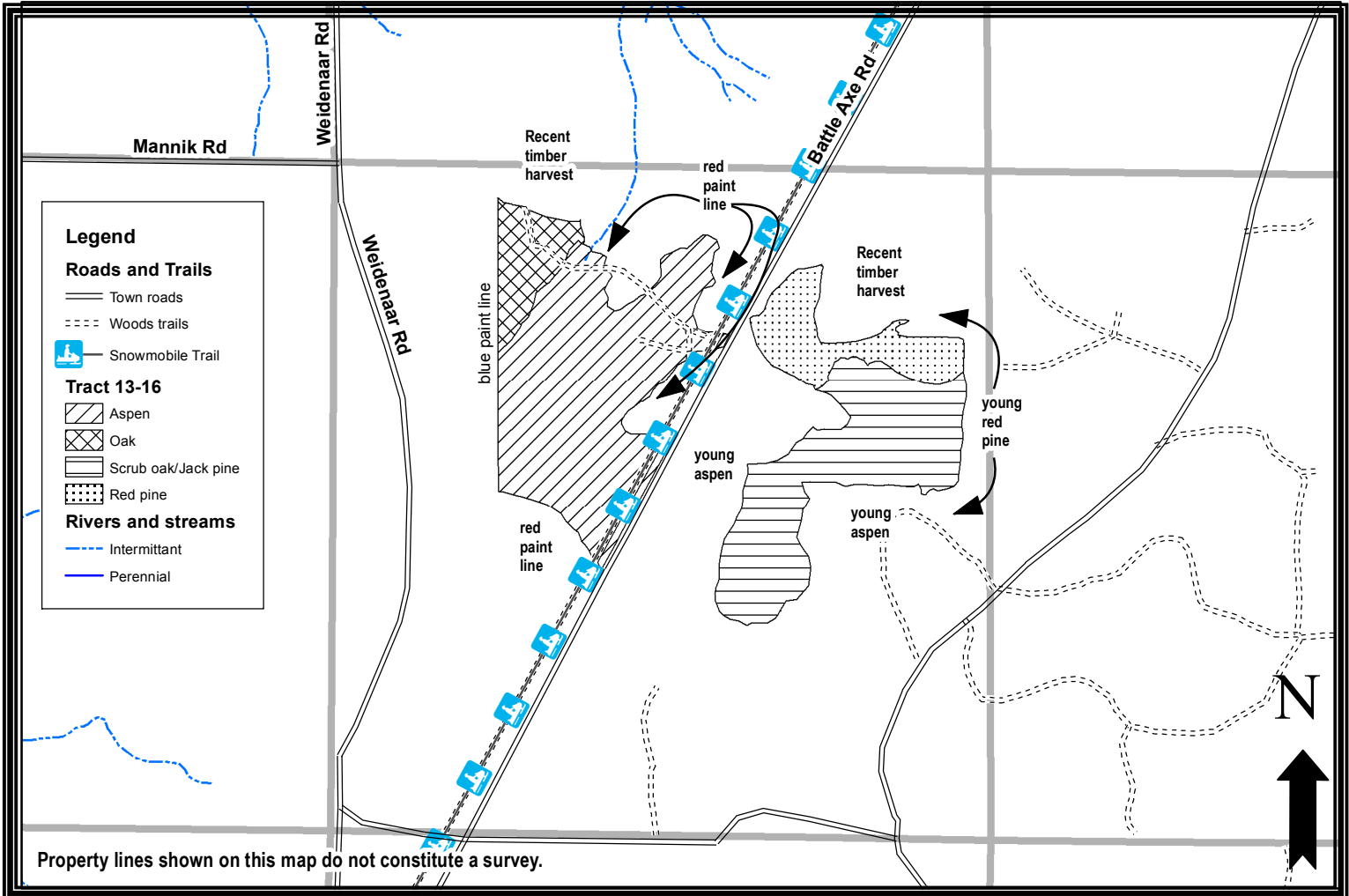

Harvest requirements:

- This is a ticket sale.
- Sale boundaries are red paint lines and abrupt cover type changes. No paint lines between units.
- Scrub oak, Oak, and Aspen units:
 - Harvest all oak, hardwood, aspen, and jack pine not marked with purple paint.
 - Harvest all pine marked with purple paint. Do not cut unpainted red pine, white pine, cedar, or hemlock.
 - Harvest all trees except oak within strip between road and snowmobile trail.
 - Sever all stems 2" diameter and larger.
- Red pine unit: harvest all orange-painted red pine. Harvest all aspen, maple, oak, and jack pine.
- Whole-tree harvesting and/or utilization of tops less than 4" diameter will not be allowed.
- Do not damage any survey monumentation.
- Prior to moving equipment on to or off the sale area, scrape or brush debris and soil from exterior surfaces.
- All roads are in place. This contract requires county authorization for all road/landing construction and places a number of other requirements on road construction and closure.
- Decking of wood along town roads will not be allowed without permission of Bayfield County.
- Harvested pine cannot be kept on the Bayfield County Forest for more than three weeks from May 1st to August 31st.
- NO SKIDDING OR HAULING on ATV/snowmobile trail.
- During winter harvesting the snowmobile trail must be kept unobstructed and in a packed snow condition. The purchaser must ensure that harvesting and hauling operations do not create a safety hazard to snowmobiles.
- No machinery or cut trees may cross the blue paint line onto private property.