

Bayfield County Forestry and Parks

Forester: Latvala			Acres: 78	Estimated Volumes:		
Twp: 50N	Range: 7W	Section: 25	Compartment: 52	Species	Round Wood Cords	MBF
Township: Clover			Stand: 5	Red Oak	1175	125
Soil: Loamy Sand		Reforestation Code: Natural	Tract Number: 52-16	*MX Hwd	585	35
Topography: Gently Rolling			Contract Number:	Aspen	340	
				Balsam Fir	40	
*MX Hwd volume includes 45% red maple, 45% sugar maple, 5% basswood, 4% white birch & 1% black ash.						

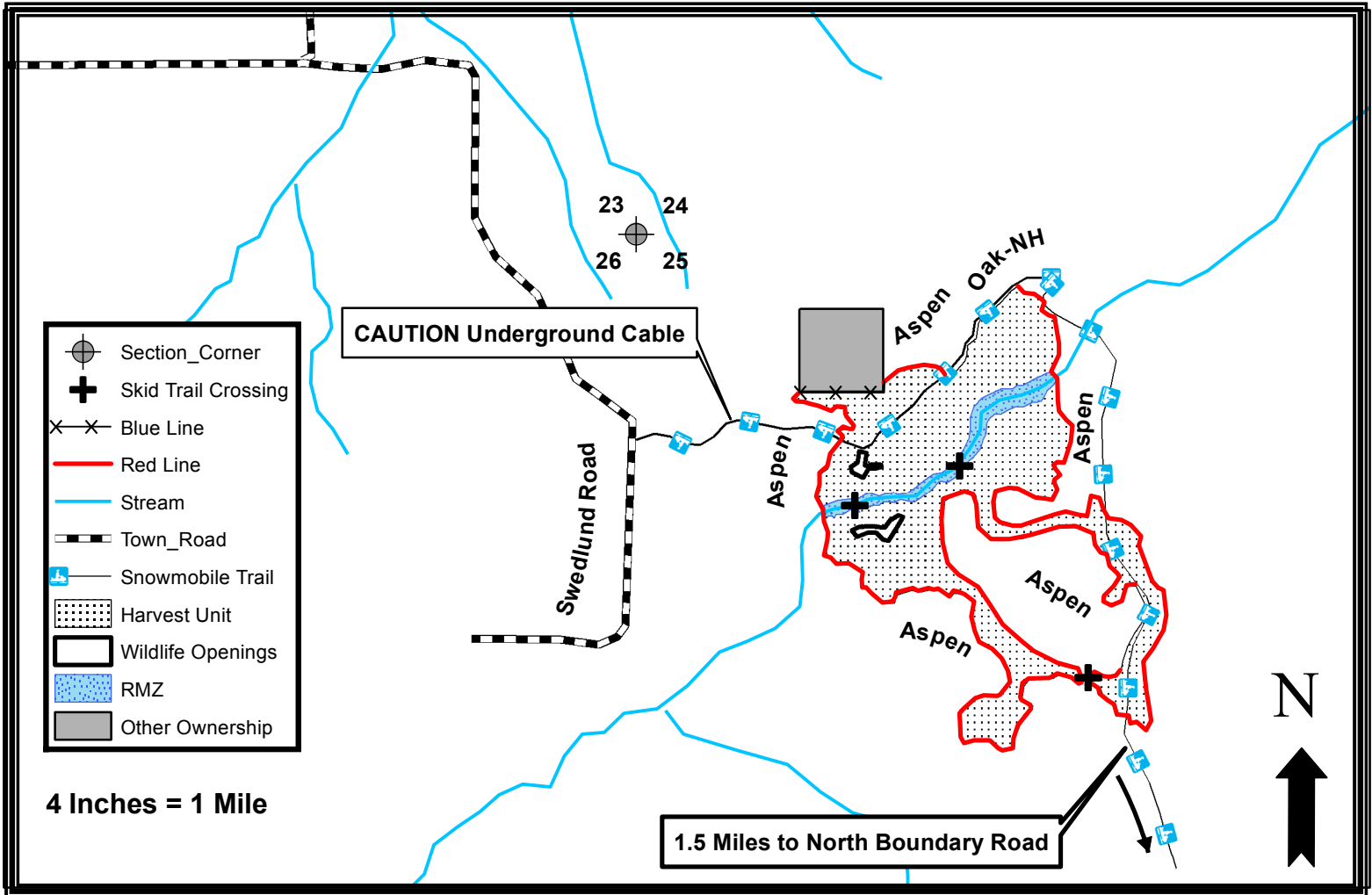

Harvest requirements:

- This timber sale is being sold on a ticket scale basis.
- Leave all purple marked trees, and leave all conifers except balsam fir.
- Harvest all other trees greater than 4" d.b.h. and sever all stems 2" diameter and larger, EXCEPT for unmapped pockets of red oak saplings and scattered snags throughout the timber sale.
- Harvesting allowed during dry or frozen season only, as determined by the sale administrator.
- To comply with the Best Management Practices for Invasive Species, prior to moving equipment on to or off the sale area, scrape or brush debris and soil from exterior surfaces to the greatest extent possible.
- The existing access roads are open to highway vehicle use in the summer and are designated snowmobile trails in the winter time. Upon completion of the timber sale these roads will be left open and in good condition, unless otherwise directed by the sale administrator.
- County authorization for all road/landing construction and other requirements on road construction and closure are required.
- Three skid trail crossing areas are designated and may be used. Proper BMP's and sale administrator authorization are required.
- During winter time harvesting, the snowmobile trail must be kept unobstructed, and in a packed snow condition. The purchaser must ensure that harvesting and hauling operations will not create a safety hazard to snowmobiles.
- Sale boundaries are marked with Red Paint or natural type change.
- The property boundary is marked with Blue Paint. (The property line depicted on this map does not constitute a survey). No equipment or felled trees may cross the blue paint line.
- There is an underground cable along the access road to the sale. The contractor will be responsible for contacting Digger's Hotline to locate the underground cable. It is the contractor's responsibility to ensure safe harvesting conditions when operating within the vicinity of the underground line.