

Bayfield County Forestry and Parks

Forester: LeBouton	Twp: 50N	Range: 5W	Sec: 35 and 36	Estimated Volumes:									
Acres: 46	Township: Bayview			<table border="1"> <thead> <tr> <th>Species</th> <th>4" cords</th> <th>MBF</th> </tr> </thead> <tbody> <tr> <td>Red oak</td> <td>230</td> <td>101</td> </tr> <tr> <td>Mixed hardwood*</td> <td>110</td> <td>14</td> </tr> </tbody> </table>	Species	4" cords	MBF	Red oak	230	101	Mixed hardwood*	110	14
Species	4" cords	MBF											
Red oak	230	101											
Mixed hardwood*	110	14											
Soil: Sand	Compartment: 63 & 66	Stand: 20,67 & 2											
Topography: Rolling	Tract Number: 23-15	Reforestation Code: Natural											
Scale: 4" = 1 mile	Contract Number:												

*pulp includes 55% hard maple, 35% soft maple, and 10% basswood
*MBF includes 45% hard maple, 30% soft maple, and 25% basswood.

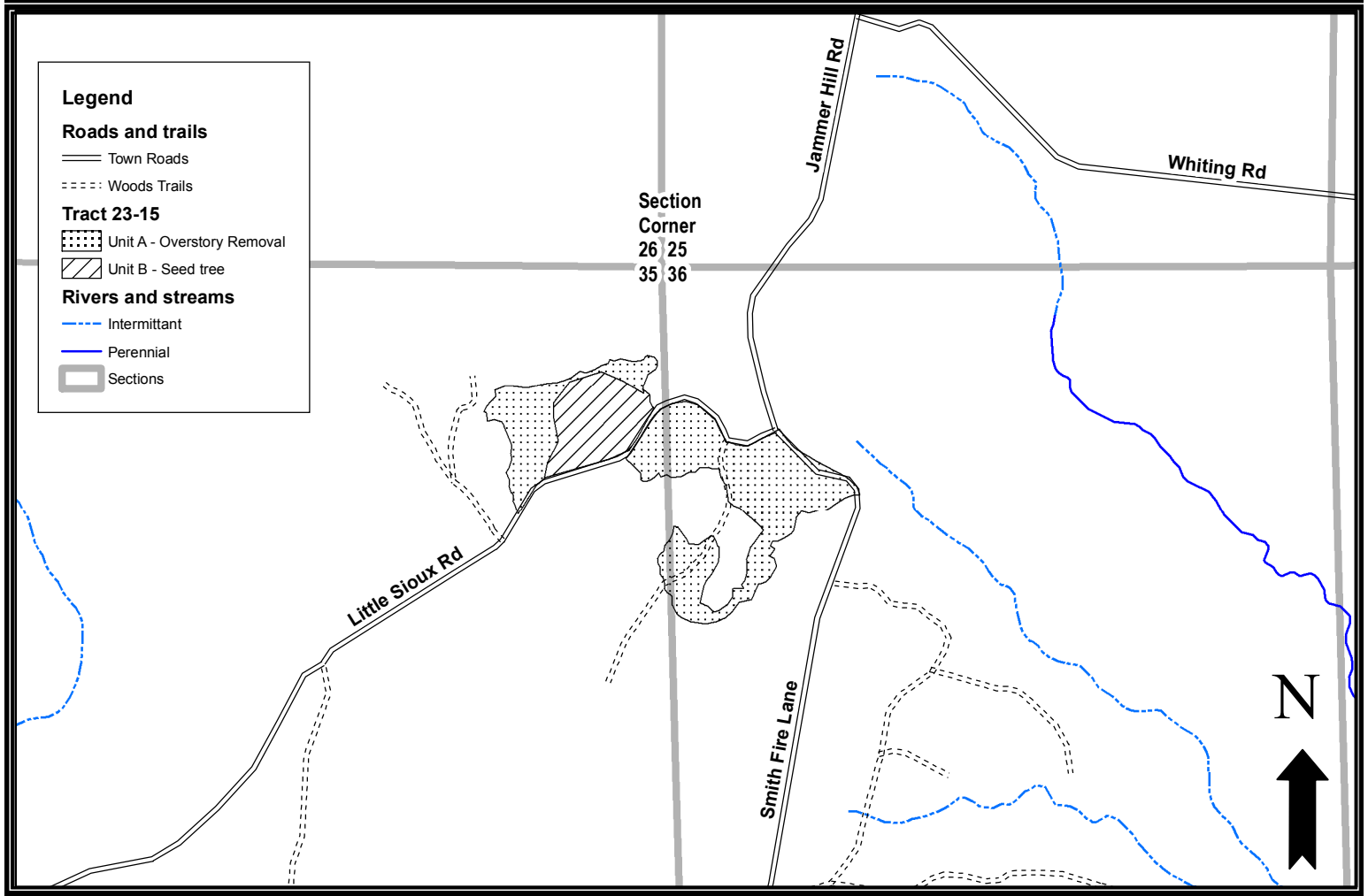

Harvest requirements:

- This is a ticket sale.
- Unit A is an overstory removal. Unit B is a seed tree harvest.
- Leave all hemlock, white pine, and trees marked with purple paint in both units. Do not damage saplings.
- CUT all other merchantable trees.
- Whole-tree harvesting and/or utilization of tops less than 4" diameter will not be allowed.
- Do not damage any survey monumentation.
- Prior to moving equipment on to or off the sale area, scrape or brush debris and soil from exterior surfaces.
- This contract requires county authorization for all road/landing construction and places a number of other requirements on road construction and closure.
- Decking of wood along town roads will not be allowed without permission of Bayfield County.