

Bayfield County Forestry & Parks Department

Foresters: Amman, Holmes, J. & L. Neitzel	Twp: 47N	Range: 9W	Sec: 1, 2
Acres: 51	Township: Hughes		
Soil: Sand	Compartment: 106	Stand: 1 & 2	
Topography: Gentle Rolling	Tract Number: 24-15	Reforestation Code:	
Scale: 4"=1 mile	Contract Number:		

Estimated Volumes

Species	Roundwood (cords)	Whole Tree (tons)
Red Pine (11" Avg. Diameter)*	542	1628
Scrub Oak**	16	68

*Less than 1% jack pine

**Less than 10% other hardwood

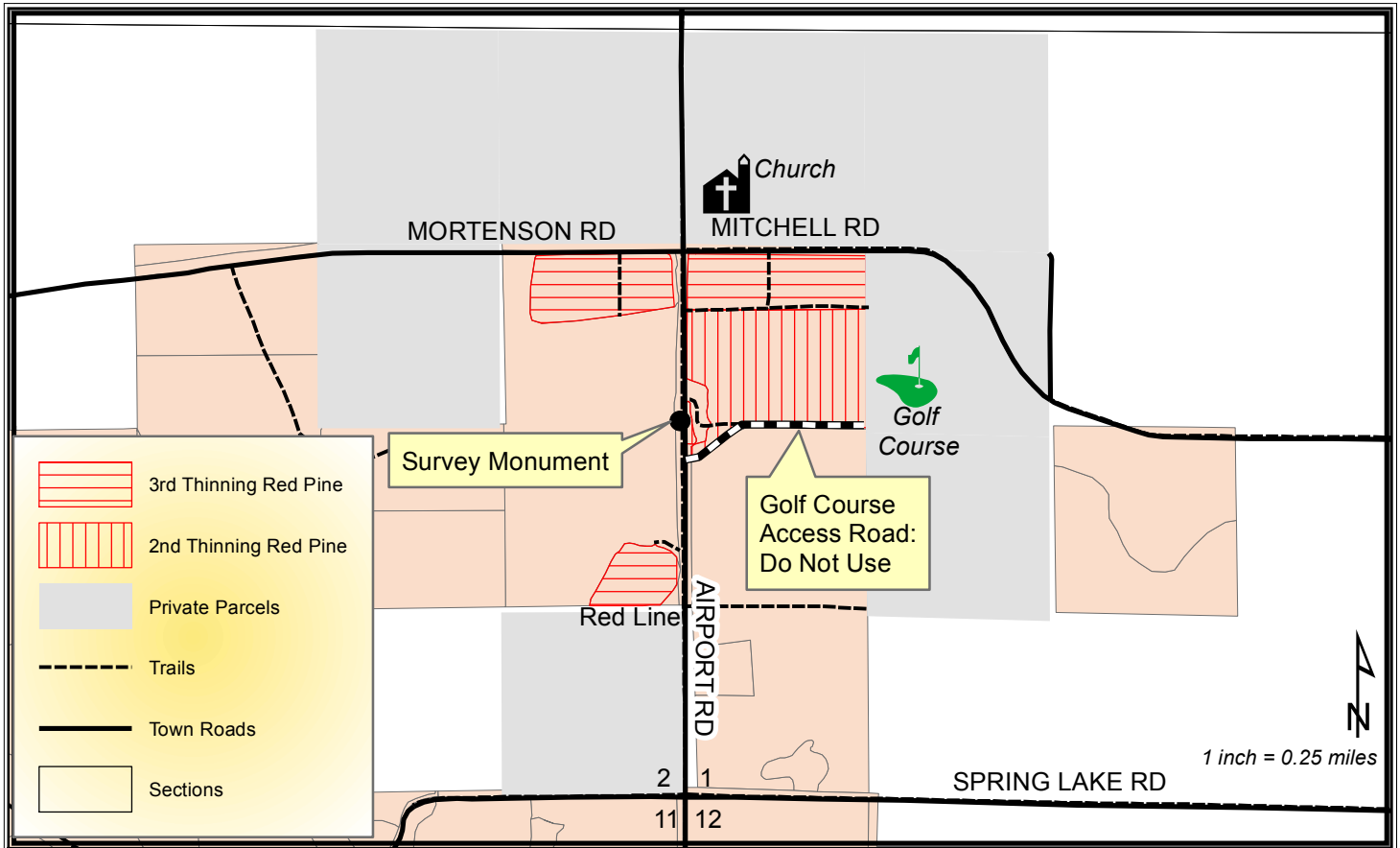

Harvest Requirements:

- This 51-acre sale is composed of a red pine thinning (27 acres of 3rd thinning and 24 acres of 2nd thinning) and is being sold on a Ticket Scale Basis.
- Sale boundaries are identifiable on the ground by abrupt changes in timber types (plantation edges), by the road that leads to the golf course on the south side of the eastern units, and by red paint on the south side of the southwestern unit.
- This sale is restricted to short-wood logging. Bayfield County may, at its discretion, allow pole skidding if the purchaser can demonstrate that it can be done without damaging the residual stand.
- As a courtesy, no harvesting in the vicinity of the church during regular meetings (Sunday 8am-noon & Wednesday 6pm-9pm).
- When harvesting adjacent to the golf course, no equipment or felled trees may cross beyond the property line which is formed by the far eastern edge of the plantation.
- Do not use the golf course access road. No equipment or felled trees may cross onto the golf course access road. Sign road for safety.
- Underground utilities run parallel to Airport Road on the east side and run through the pine plantation in places. Utilities (above or below ground) may exist at other places in the sale area. Contact Diggers Hotline and use caution.
- PRESCRIPTION: Harvest all orange-painted red pine as well as all merchantable hardwoods and jack pine.
- Minimize damage to residual red pine stand.
- Harvested pine cannot be kept on the Bayfield County Forest for more than 3 weeks from May 1st to August 31st.
- Do not damage any survey monuments.
- To comply with the Best Management Practices for Invasive Species: Prior to moving equipment onto or off of the sale area, scrape or brush soil and debris from exterior surfaces of the logging equipment.
- Decking of wood along town roads will not be allowed without permission from Bayfield County Forestry Department
- This contract requires County authorization for all road/landing construction and places a number of other requirements on road construction and closure. (refer to Section 17)