

# Bayfield County Forestry and Parks

Forester: Sirrine	Twp: 50N	Range: 05W, 6W	Sec: 31, 36	Estimated Volumes:	
Acre: 55	Township: Bell, Bayfield			Species	Cords
Soil: Sand	Compartment: 60	Stand: 37		Scrub oak+	725
Topography: Rolling	Tract Number: 47-15	Reforestation Code: natural		Aspen	420
				Jack pine*	340
				Red pine**	180
Scale: 4" = 1 mile	Contract Number:			+ Includes approximately 7 cords of red maple *Average diameter = 10 inches ** Average diameter = 8 inches	

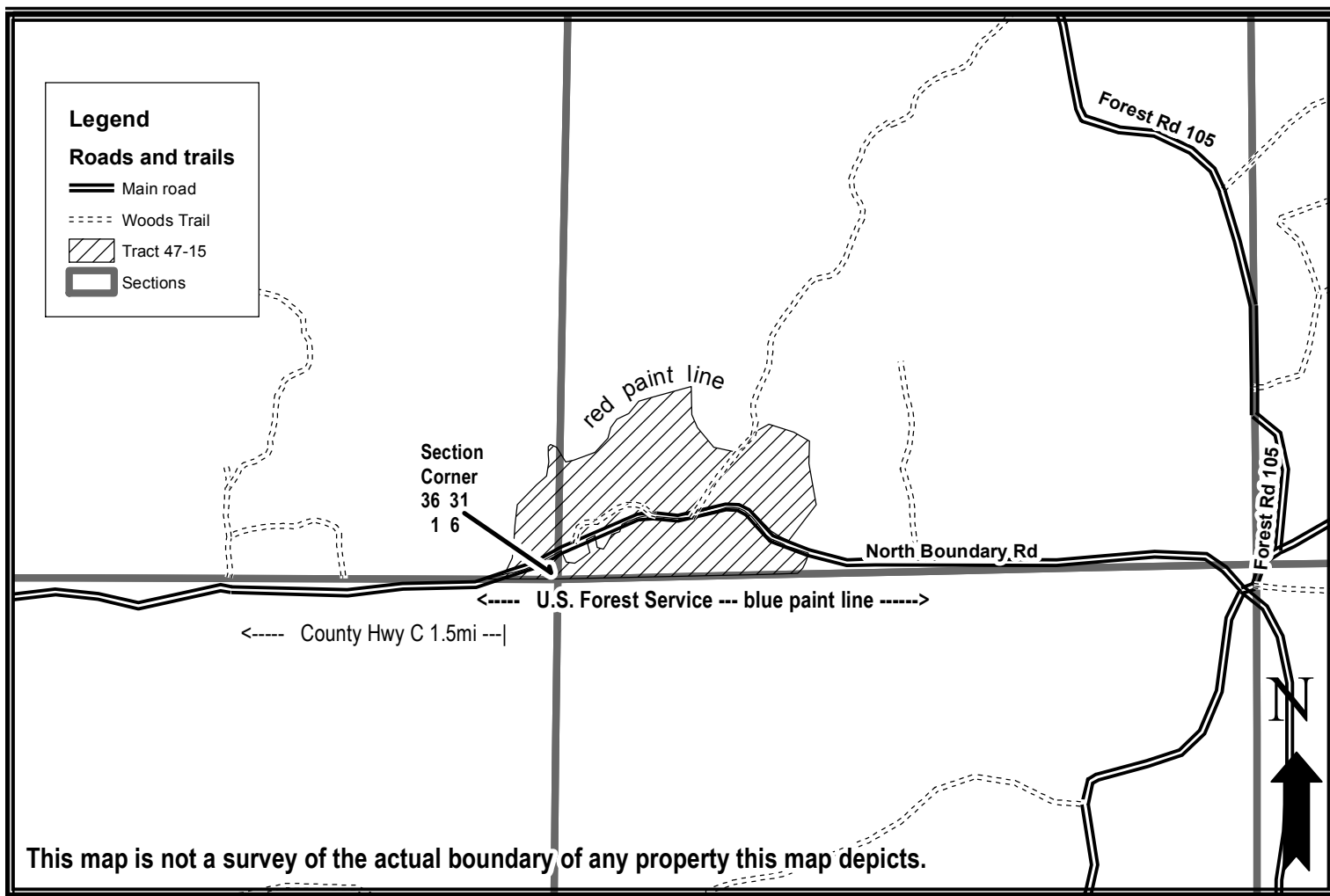

## Harvest requirements:

- This is a ticket sale. Sale boundaries are red paint line (north) and blue paint line (south.)
- This is a clear cut in scrub oak, aspen, and pine.
- Whole-tree harvesting and/or utilization of tops less than 4" diameter will not be allowed.
- Harvest all merchantable trees EXCEPT those marked with green paint. Sever all stems 2" diameter at breast height and larger.
- Do not cut snags except for individuals that pose a safety hazard.
- Do not damage any survey monumentation.
- The blue line indicates Forest Service land. No equipment or felled trees may cross the line.
- To comply with the Best Management Practices for invasive species: Prior to moving equipment onto or off of the sale area, scrape or brush soil and debris from exterior surfaces to the extent practical
- All roads are in place. This contract requires county authorization for all road/landing construction and places a number of other requirements on road construction and closure.
- Decking of wood along town roads will not be allowed without permission of Bayfield County.
- Harvested pine cannot be kept on the Bayfield County Forest for more than three weeks from May 1<sup>st</sup> to August 31<sup>st</sup>.
- Purchaser must ensure that harvesting and hauling operations will not create a safety hazard to ATVs or snowmobiles. During winter harvesting the snowmobile trail must be kept unobstructed and in a packed snow condition.