

Bayfield County Forestry & Parks Department

Forester: Caleb E. Brown			Compartment: 7	Stand: 29	Tract Number: 05-21
Twp: T51N	Range: R4W	Sec: 16	Township: Russell	Contract Number:	
Topography: Gentle Rolling & Flat			Reforestation Code: Seed - White Pine	Soil: Sand & Sandy Loam	Acres: 77

Estimated Volumes			
Species	Whole Tree (Tons)	4" Roundwood (Tons)	Sawlogs (MBF)
Mixed Hardwoods	4283*	3181**	60
Aspen	684	559	-

*Approximately 58% Sugar Maple, 15% Basswood, 15% Red Maple, 4% Yellow Birch, 4% White Birch, 3% Red Oak, & 1% Other
 **Approximately 34% Red Oak, 34% Basswood, 20% Sugar Maple, 6% Red Maple, 5% Yellow Birch, & 1% Other Hardwood

Other
 -Summer Chance (Dry) or Frozen Operations Only
 -No Operations Between April 15th & June 15th
 -Utilization Specification (see supplemental requirements)

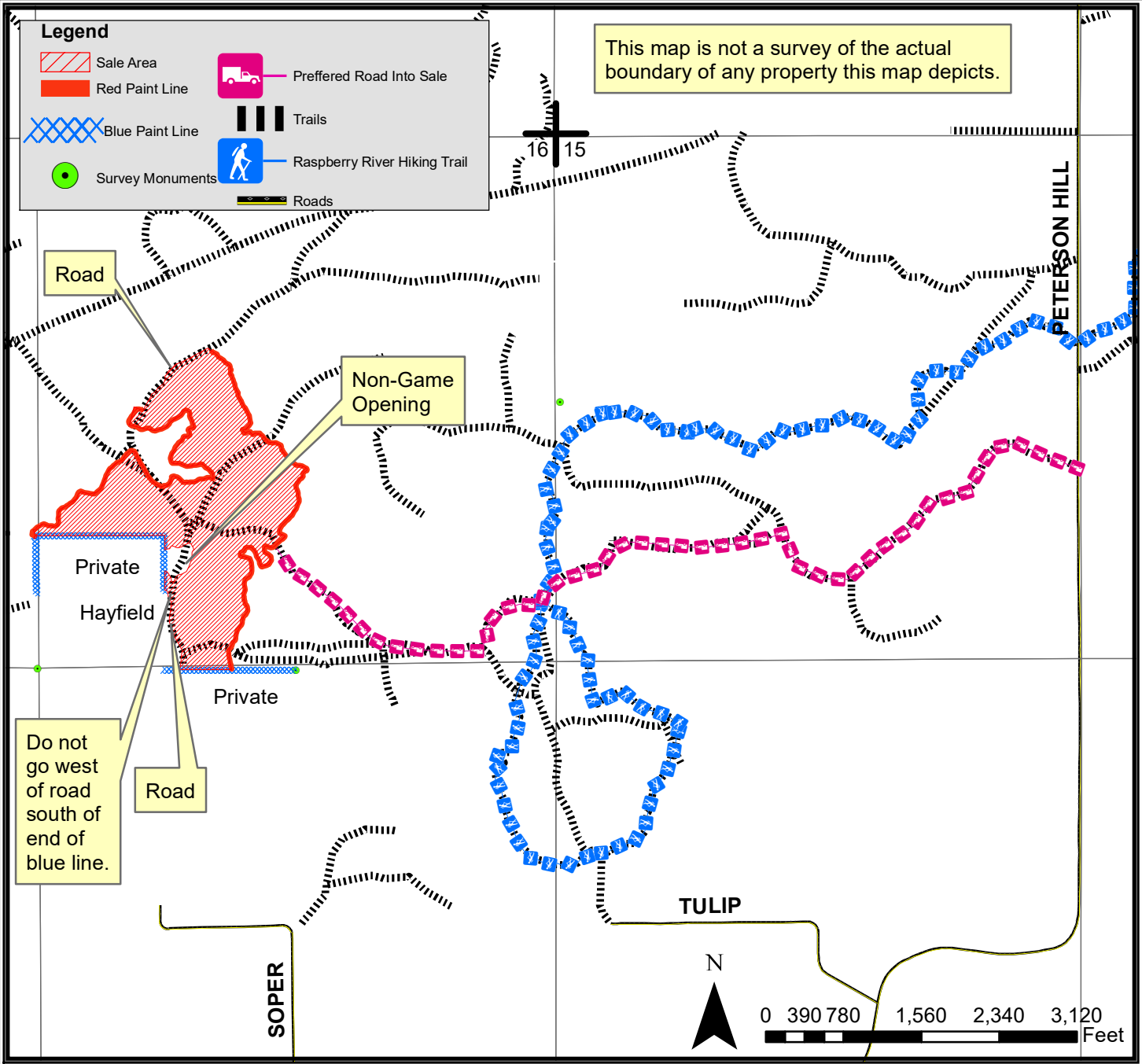

TRACT 05-21 – SUPPLEMENTAL REQUIREMENTS

The following terms and conditions supplement those provided in the Bayfield County Timber Sale Contract.

A. PRESCRIPTION:

1. The sale area has a northern hardwood seed tree prescription with an estimated average residual basal area of 10 ft².

B. HARVEST REQUIREMENTS:

1. In the sale area harvest all stems 2 inches and greater except for oak 16" in diameter and less. Leave all conifer.

C. HARVEST AND OPERATIONAL REQUIREMENTS AND SEASONAL RESTRICTIONS:

1. Summer chance or frozen ground operations only as determined by the county.
2. Utilization specification is to a 4" top. However, if the County determines that pulpwood markets continue to be very poor at the time of harvest the County will sign a contract amendment with the purchaser changing the utilization specification to a 5" top for selected species. When determining condition of the market, the County will pay particular attention to the amount of wood being purchased by the mills in Wisconsin Rapids and any other significant shifts in wood demand.
3. Sale boundaries include red paint line, blue paint line, and established logging & farming roads (along the south western and northern part of the stand).
4. Do not cross west of road in southern west part of the sale south of the end of the blue line to protect private owners' hayfield (see map).
5. The blue line indicates private property. No equipment or felled trees may cross the line.
6. The Raspberry River walking trail intersects the preferred haul route. Do not cut the blue marked trail trees.
7. If harvest will utilize the whole tree, 1 in 10 tops must be left scattered throughout the sale.
8. Do not damage any survey monumentation.

D. ACCESS AND ROADS:

1. Preferred access to sale from Peterson Hill Road shown on map. This road was used as recently as the winter/spring of 2021 as a haul road.
2. This contract requires County authorization for all road/landing construction and places a number of other requirements on road construction and closure.
3. Decking of wood along town roads will not be allowed without permission from Bayfield County.

E. OTHER:

1. To comply with Best Management Practices for Invasive Species: Prior to moving equipment onto or off the sale area, scrape or brush soil and debris from exterior surfaces to the extent practical.

