

TOWN OF BARNES

Bayfield County, Wisconsin

PREFERRED FUTURE LAND USE

(NORTHERN AREA)

Map 5-6

- GENERAL LAND USES**
- RESIDENTIAL
 - COMMERCIAL
 - INDUSTRIAL
 - MUNICIPAL/INSTITUTIONAL
 - AGRICULTURE
 - COUNTY FOREST
 - PRIVATE FOREST
 - OTHER FORESTS
 - PARKS/RECREATIONAL
- NATURAL LIMITATIONS**
- WETLAND AND FORESTED WETLANDS



Northern Area Boundary

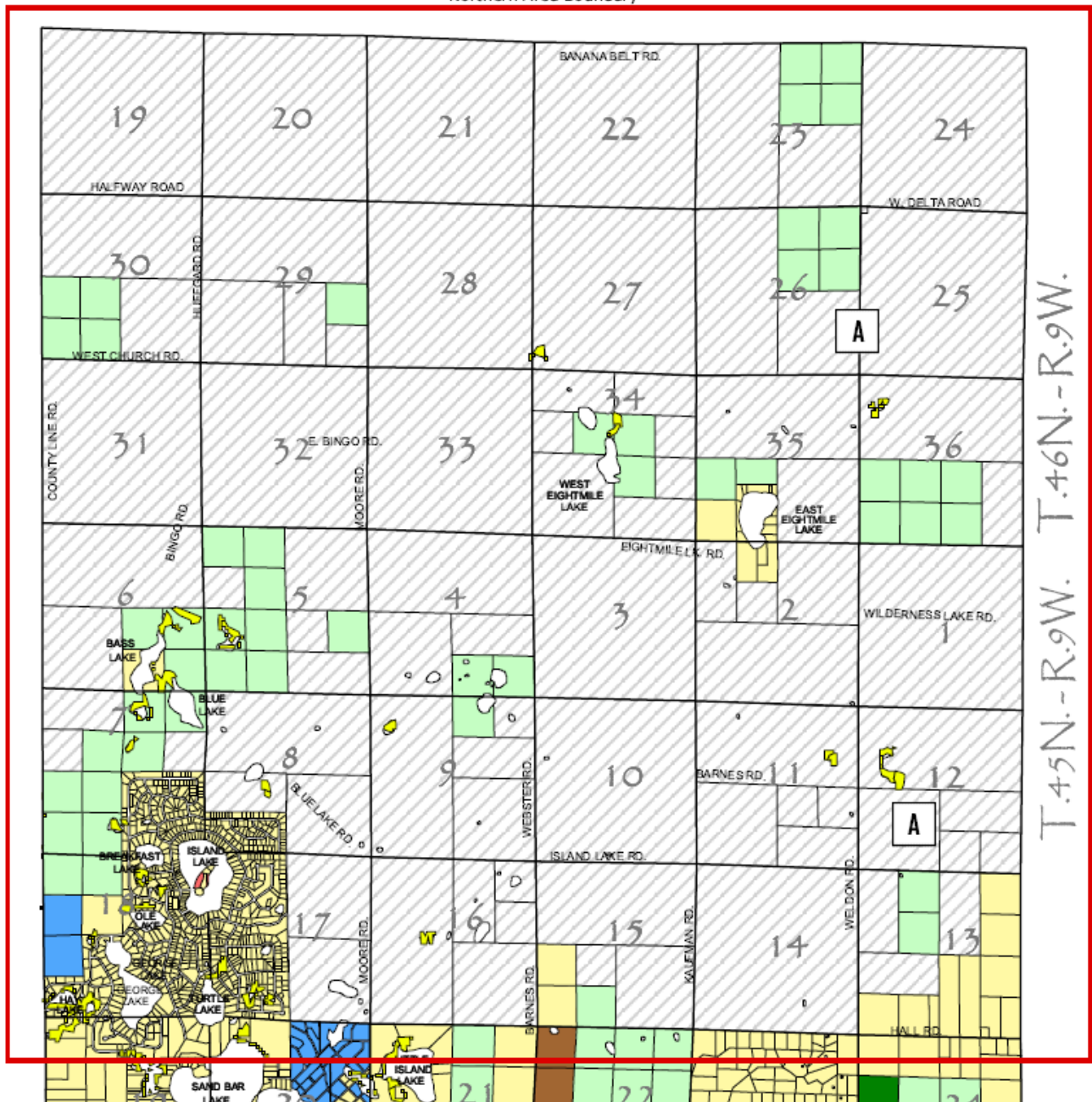

*** In the case of any inconsistencies between this Preferred Future Land Use map, contained in the Town of Barnes Comprehensive Land Use Plan 2006-2026, and the existing Bayfield County zoning classification of parcels in the Town of Barnes, the existing Bayfield County zoning classification shall take precedence.**

TOWN OF BARNES

Bayfield County, Wisconsin

PREFERRED FUTURE LAND USE

(MIDDLE AREA)

Map 5-7

- GENERAL LAND USES**
- RESIDENTIAL
 - COMMERCIAL
 - INDUSTRIAL
 - MUNICIPAL/INSTITUTIONAL
 - AGRICULTURE
 - COUNTY FOREST
 - PRIVATE FOREST
 - OTHER FORESTS
 - PARKS/RECREATIONAL
- NATURAL LIMITATIONS**
- WETLAND AND FORESTED WETLANDS

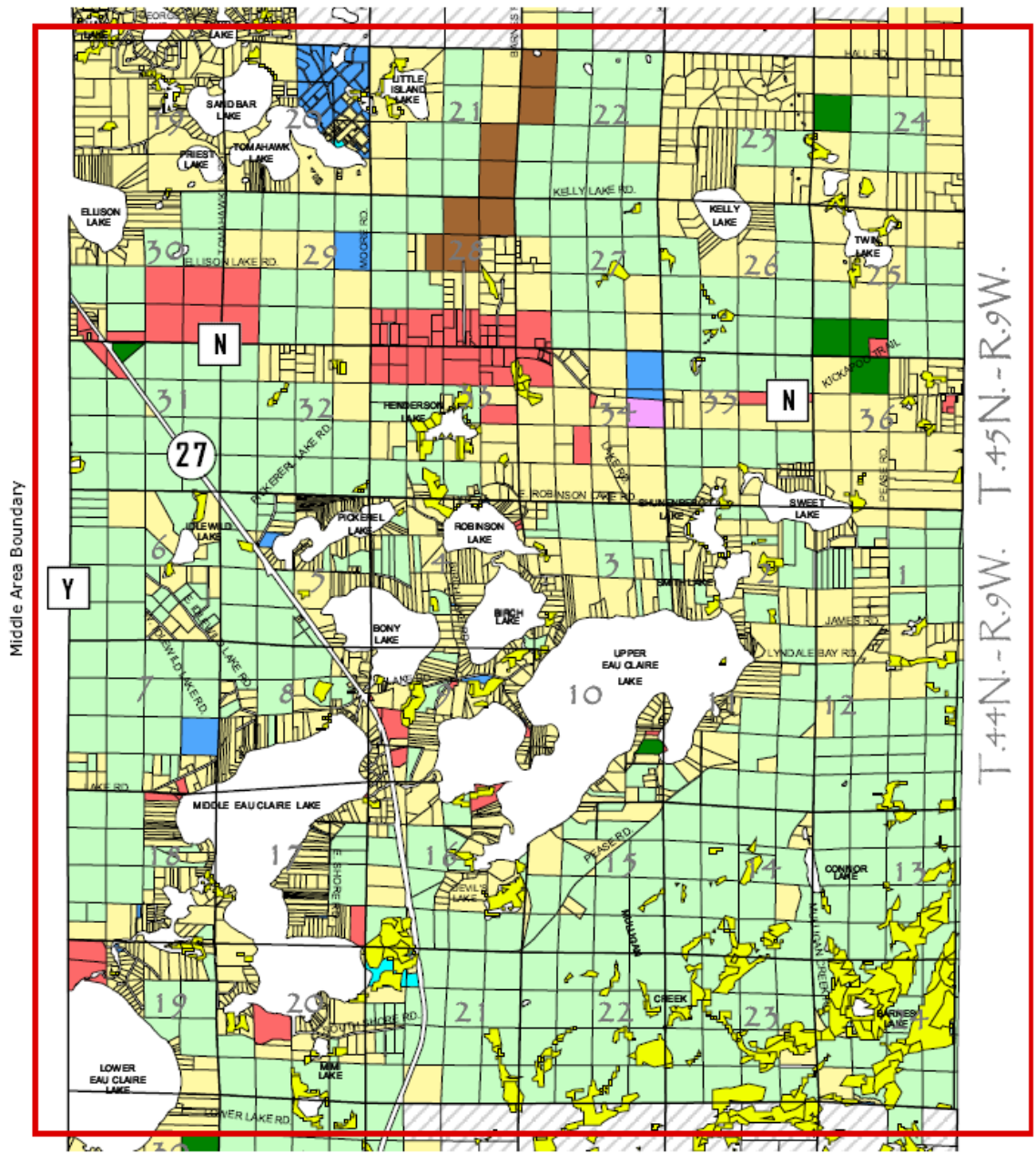

* In the case of any inconsistencies between this Preferred Future Land Use map, contained in the Town of Barnes Comprehensive Land Use Plan 2006-2026, and the existing Bayfield County zoning classification of parcels in the Town of Barnes, the existing Bayfield County zoning classification shall take precedence.

Source: 2004 Bayfield County Tax Roll, Town of Barnes Comprehensive Land Use Planning Committee, 2004 Bayfield County Plat Book.

TOWN OF BARNES

Bayfield County, Wisconsin

PREFERRED FUTURE LAND USE

(SOUTHERN AREA)

Map 5-8

- GENERAL LAND USES**
- RESIDENTIAL
 - COMMERCIAL
 - INDUSTRIAL
 - MUNICIPAL/INSTITUTIONAL
 - AGRICULTURE
 - COUNTY FOREST
 - PRIVATE FOREST
 - OTHER FORESTS
 - PARKS/RECREATIONAL
- NATURAL LIMITATIONS**
- WETLAND AND FORESTED WETLANDS

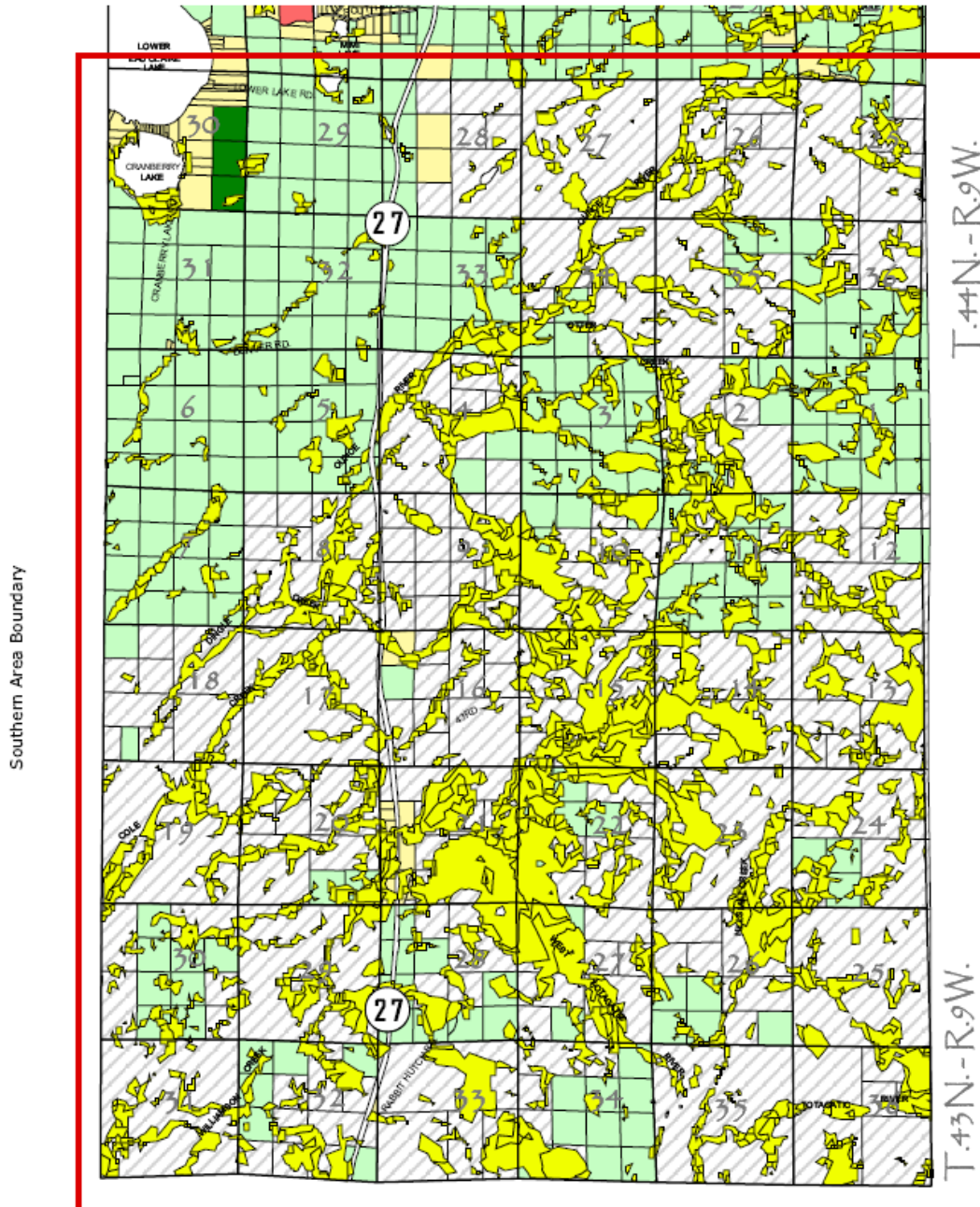

*** In the case of any inconsistencies between this Preferred Future Land Use map, contained in the Town of Barnes Comprehensive Land Use Plan 2006-2026, and the existing Bayfield County zoning classification of parcels in the Town of Barnes, the existing Bayfield County zoning classification shall take precedence.**

Source: 2004 Bayfield County Tax Roll, Town of Barnes Comprehensive Land Use Planning Committee, 2004 Bayfield County Plat Book.