

Bayfield County Forestry and Parks

Forester: Golembiewski			Acres: 35	Estimated Volumes:			
Twp: 48N	Range: 8W	Section: 33 & 34	Compartment: 101	Species	Whole Tree Tons	Round Wood Cords	MBF
Township: Tripp			Stand: 16	Jack Pine*	870	290	XXX
Soil: Sand	Reforestation Code: Natural		Tract Number: 14-16	Aspen	680	210	XXX
Topography: Gently Rolling			Contract Number:	Scrub Oak**	550	120	XXX

*Jack Pine includes 20% Red Pine & 2% Balsam Fir.
**Scrub Oak includes 15% Red Maple.

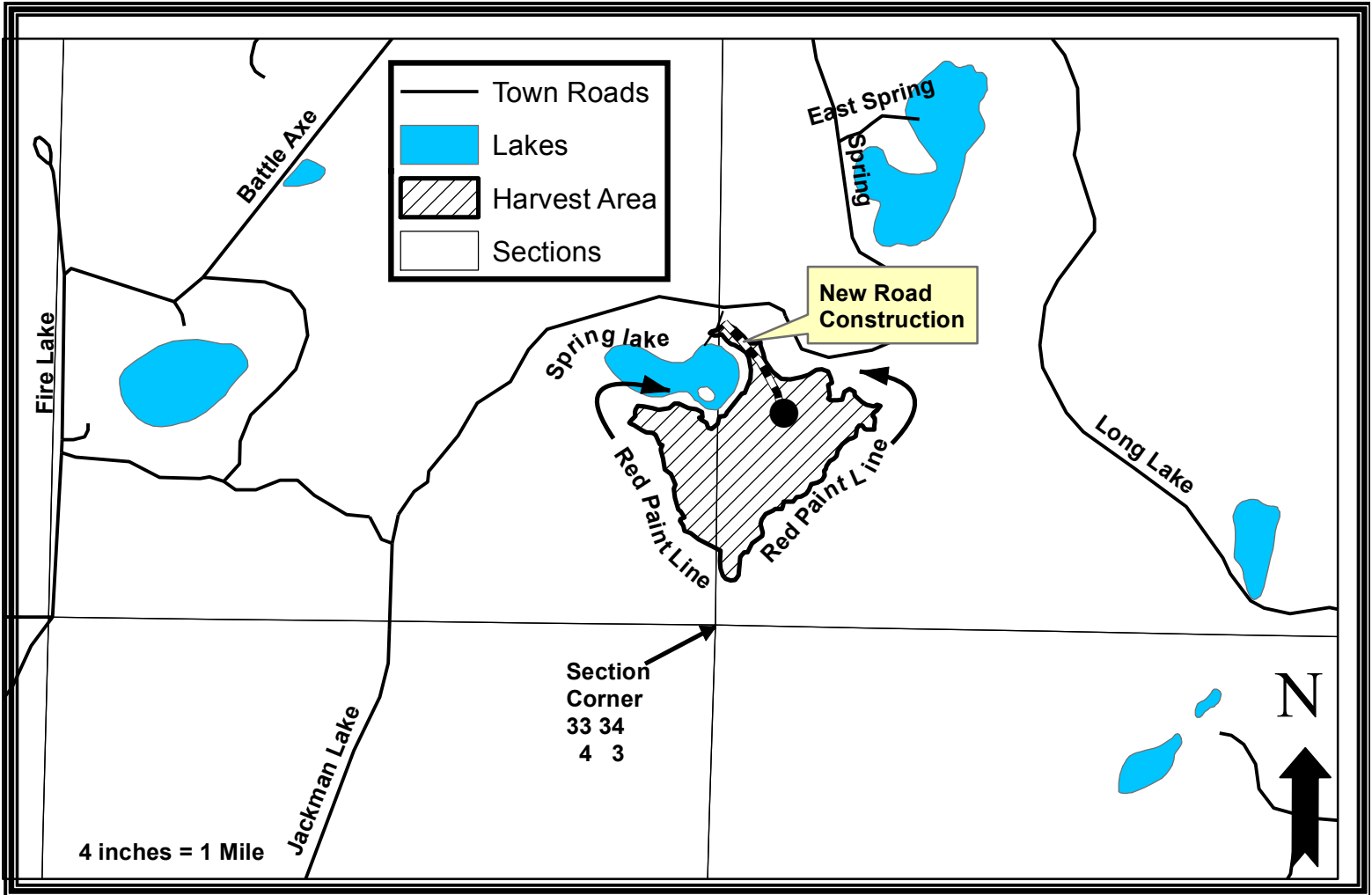

Harvest requirements:

- This is a ticket sale.
- This is a clear-cut harvest with a residual basal area of 1 ft²/acre.
- Cut all aspen, red maple, balsam fir, and jack pine within the sale area 2 inches DBH and larger. Cut red pine 5 inch DBH and larger. Leave all white pine. Leave all red pine less than 5 inch DBH.
- Do not damage any survey monumentation.
- Prior to moving equipment on to or off the sale area, scrape or brush debris and soil from exterior surfaces.
- Do not cut snags of other species except those that pose a safety hazard to logging operations.
- An 800 foot stub road will be required to be built and is not marked in the field. Final location will be determined by the sale administrator. All other roads are in place. This contract requires county authorization for all road/landing construction and places a number of other requirements on road construction and closure.
- Decking of wood along town roads will not be allowed without permission of Bayfield County.
- Harvested pine cannot be kept on the Bayfield County Forest for more than three weeks from May 1st to August 31st.