

# Bayfield County Forestry & Parks Department

Forester: Neitzel			Compartment: 108,115,118,119	Stand: 15,27,10,1,20,1,5	<b>Tract Number: 12-19</b>
Twp: 47N	Range: 9W	Sec: 16,21,28	Township: Hughes	Contract Number:	
Topography: Gentle Rolling			Reforestation Code: NAT.	Soil: Sand, Loamy Sand, Sandy Loam	<b>Acres: 53</b>

Estimated Volumes			
Species	4" Roundwood (Cords)	Whole Tree (Tons)	Sawlogs (MBF)
Oak	372		17***
Red Pine*	327		
Red Maple**	178		
Aspen	54		

\*Approx. 95% red pine and 5% white pine  
 \*\*Approx. 92% red maple, 7% white birch, 1% other hardwood  
 \*\*\*Approx. 47% red oak, 40% scrub oak, 6% white birch, 6% maple, 1% other hardwood

**Special Restrictions:**  
 >See Operational Requirements and Season Restrictions section in the Harvest Requirements

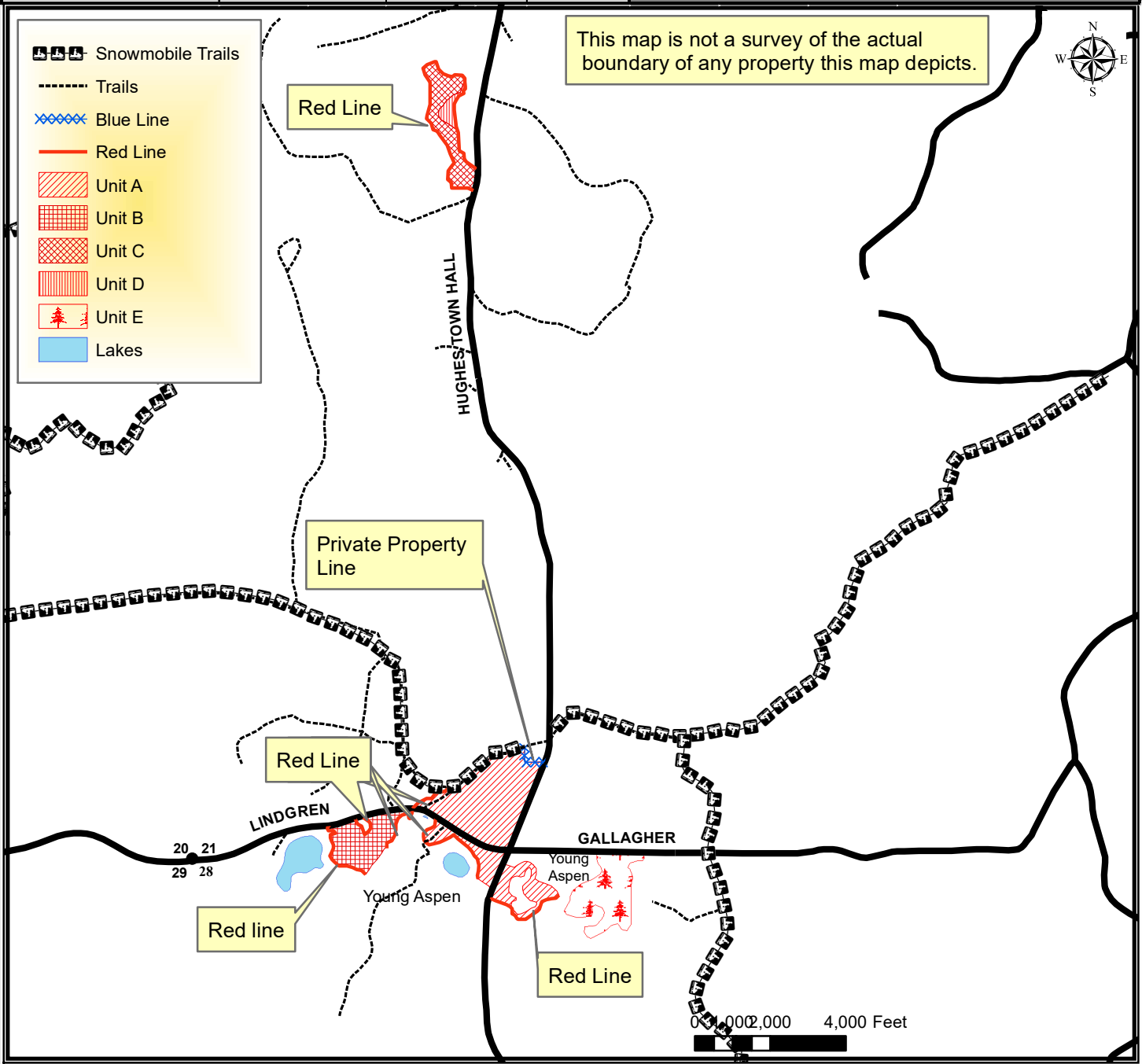

# TRACT 12-19 – HARVEST REQUIREMENTS

The following terms and conditions supplement those provided in the Bayfield County Timber Sale Contract.

## A. PRESCRIPTION:

1. Harvest unit A has a clear cut prescription with an estimated average residual basal area of 14 ft<sup>2</sup>.
2. Harvest unit B has a seed tree prescription with an estimated average residual basal area of 28 ft<sup>2</sup>.
3. Harvest unit C has a clear cut prescription with an estimated average residual basal area of 0 ft<sup>2</sup>.
4. Harvest unit D has an overstory removal prescription with an estimated average residual basal area of 0 ft<sup>2</sup>.
5. Harvest unit E has a thinning prescription with an estimated average residual basal area of 115 ft<sup>2</sup>.

## B. HARVEST REQUIREMENTS:

1. In harvest unit A, sever all hardwood stems 2" in diameter and greater and jack pine stems 5 inches in diameter and greater. Leave all conifer stems except jack pine.
2. In harvest unit B, sever all unmarked hardwood stems 2" in diameter and greater, jack pine stems 5" in diameter and greater and all orange marked conifer stems. Leave all purple marked hardwood stems and unmarked conifer stems except jack pine.
3. In harvest unit C, sever all hardwood stems 2 inches in diameter and greater and all red and jack pine stems 5 inches in diameter and greater. Leave all white pine and spruce
4. In harvest unit D, harvest all hardwood stems 5 inches in diameter and greater and all red and jack pine stems 5 inches and diameter and greater. Leave all white pine and spruce.
5. In harvest unit E, harvest all red pine stems marked with orange paint.

## C. OPERATIONAL REQUIREMENTS AND SEASONAL RESTRICTIONS:

1. Sale boundaries consist of red line, blue line, trails, roads, abrupt timber type changes to young aspen or from mature marked red pine.
2. The blue line indicates private property. No equipment or felled trees may cross the line.
3. Whole tree harvesting and/or utilization of tops ( $\leq 4$ " diameter) will not be allowed.
4. In 2018, oak wilt was officially confirmed in Bayfield County. Currently, this timber sale is located more than six miles away from the closest known infected tree. However, over the duration of this contract, additional infections could be discovered. If, over the duration of this contract, including extensions, oak wilt is officially confirmed within a six-mile radius of this timber sale, as determined by the county, the following seasonal restrictions will be applied: no harvesting operations will be allowed between April 15 (or as otherwise determined by the county) and July 15 in units A and B.
5. Harvested pine cannot be kept on the Bayfield County Forest for more than three weeks from May 1<sup>st</sup> to August 31<sup>st</sup>.
6. From May 19<sup>th</sup> to October 16<sup>th</sup> care should be taken to avoid open sandy areas with equipment and felled trees due to the possible presence of a rare animal.
7. Do not cut snags except for individuals that pose a safety hazard.
8. Do not damage any survey monumentation.

## D. ACCESS AND ROADS:

1. During winter harvesting the snowmobile trail must be kept unobstructed and in a packed snow condition. The purchaser must ensure that harvesting operations will not create a safety hazard to snowmobiles. No skidding will be allowed on the snowmobile trail. Avoid damage to signs and trail markers.
2. This contract requires County authorization for all road/landing construction and places a number of other requirements on road construction and closure.
3. Decking of wood along town roads will not be allowed without permission from Bayfield County.

## E. OTHER:

1. To comply with the Best Management Practices for invasive species: Prior to moving equipment onto or off of the sale area, scrape or brush soil and debris from exterior surfaces to the extent practical.

